

FEATURES

- 66" (167.6cm) x 36"(81.3cm) x 24" (46.4cm)
- Cast iron with Safeguard® finish
- System II - 1 hp 2 speed pump with integral heater & electronic switch
- 8 Flexjets
- LESS ALL TRIM
- Pump is supplied with a grounding-type plug-in cord

CODES/STANDARDS APPLICABLE

Specified model meets or exceeds the following:

- ADA
- ASME/ANSI A112.19.1M
- ASME/ANSI A112.19.7M
- CABO/ANSI A117.1
- IAPMO/UPC
- Underwriters Laboratories (UL)

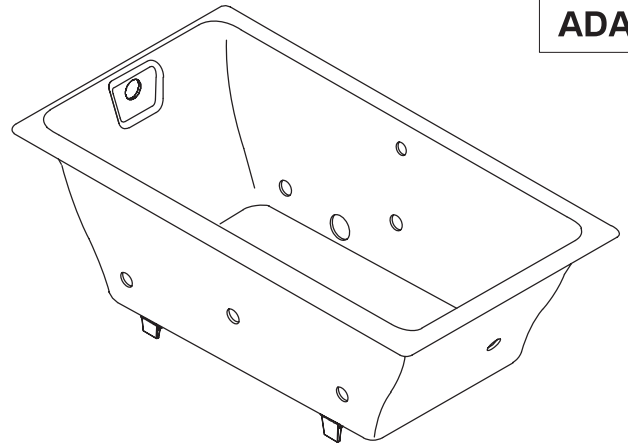

COLORS/FINISHES

- 0 White
- Other Refer to Fixtures Price Book for additional colors

Accessories:

- CP Polished Chrome
- PB Polished Brass
- Other Refer to Faucets Price Book for additional finishes
- NA None Applicable

SPECIFIED MODEL:

Model	Description	Colors/Finishes		
K-856	5.5' bath whirlpool, drop-in rim style	<input type="checkbox"/> 0 White	<input type="checkbox"/> Other_____	
K-856-L	5.5' bath whirlpool with left outlet, integral flange	<input type="checkbox"/> 0 White	<input type="checkbox"/> Other_____	
K-856-R	5.5' bath whirlpool with right outlet, integral flange	<input type="checkbox"/> 0 White	<input type="checkbox"/> Other_____	
Required Accessories				
K-9698	Jet trim kit	<input type="checkbox"/> CP	<input type="checkbox"/> PB	<input type="checkbox"/> Other_____
K-7147-AF	Drain	<input type="checkbox"/> CP	<input type="checkbox"/> PB	<input type="checkbox"/> Other_____
Optional Accessories				
K-587	Undermount installation kit (template and installation instructions)			<input type="checkbox"/> NA

PRODUCT SPECIFICATION:

The bath whirlpool shall be 66" (167.6cm) in length, 36" (81.3cm) in width, and 24" (46.4cm) in height. Bath whirlpool shall be made of cast iron with Safeguard® finish. Bath whirlpool shall have System II, with 8 Flexjets, 1 hp 2 speed pump with integral heater, and electronic switch. Bath whirlpool shall be less all trim. Bath whirlpool pump shall be supplied with a grounding-type plug-in cord. Bath whirlpool shall be Kohler Model K-856-_____.

TEA-FOR-TWO™

PRODUCT INFORMATION

Fixture*:	basin area	top area	weight
Bathing well	45" (114.3cm) x 25" (63.5cm)	58" (147.3cm) x 29" (73.7cm)	500 lbs. (228.2 kg)
	water depth	capacity	
To overflow	19-1/2" (49.5cm)	105 gal. (397.4L)	
* Approximate measurements for comparison only.			

Pump	high HP	V	Hz	A
2-speed	1	120	60	16.5

REQUIRED ELECTRICAL SERVICE

Dedicated circuit required, protected with Class A Ground-Fault Circuit-Interrupter (GFCI):

Pump/control	120 V., 20 A, 60 Hz
--------------	---------------------

INSTALLATION NOTES

Each pump is supplied with a grounding type plug-in cord. Locate the outlet behind the whirlpool, and within 24" (61cm) of the pump.

Floor support under whirlpool must provide for a minimum of 80 lbs./square foot (390 Kg./square meter) loading.

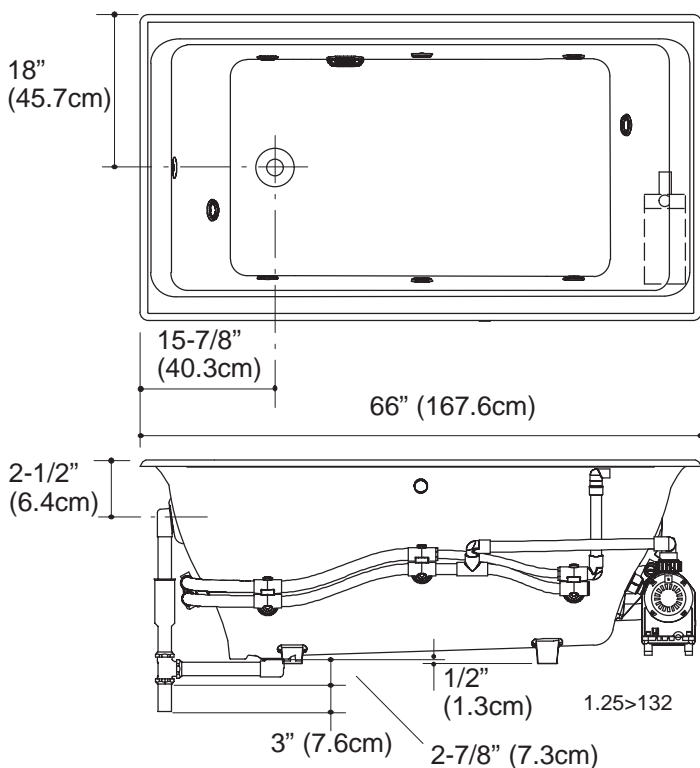

No change in measurements if connected with drain illustrated.

Cut-out for drop-in	64-1/2" (163.8cm) x 34-1/2" (87.6cm)
---------------------	--------------------------------------

Cut-out for undermount	K-587 template required
------------------------	-------------------------

Minimum access panel:

Pump/control	20" (50.8cm) W x 15" (38.1cm) H	required
--------------	---------------------------------	----------

PUMP/CONTROL ACCESS

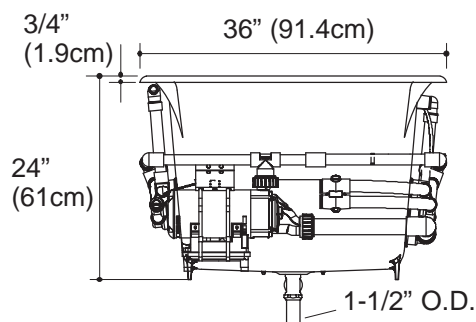

PRODUCT DIAGRAM

K-856 Tea-For-Two™ 5.5' Bath Whirlpool

Page 2 of 2

1015643-4-A

THE BOLD LOOK
OF **KOHLER**®