

KOHLER®

SERVICE KIT INSTRUCTIONS

VALVE BODY SERVICE KIT
1033302, 1013843, 1013844,
1042244

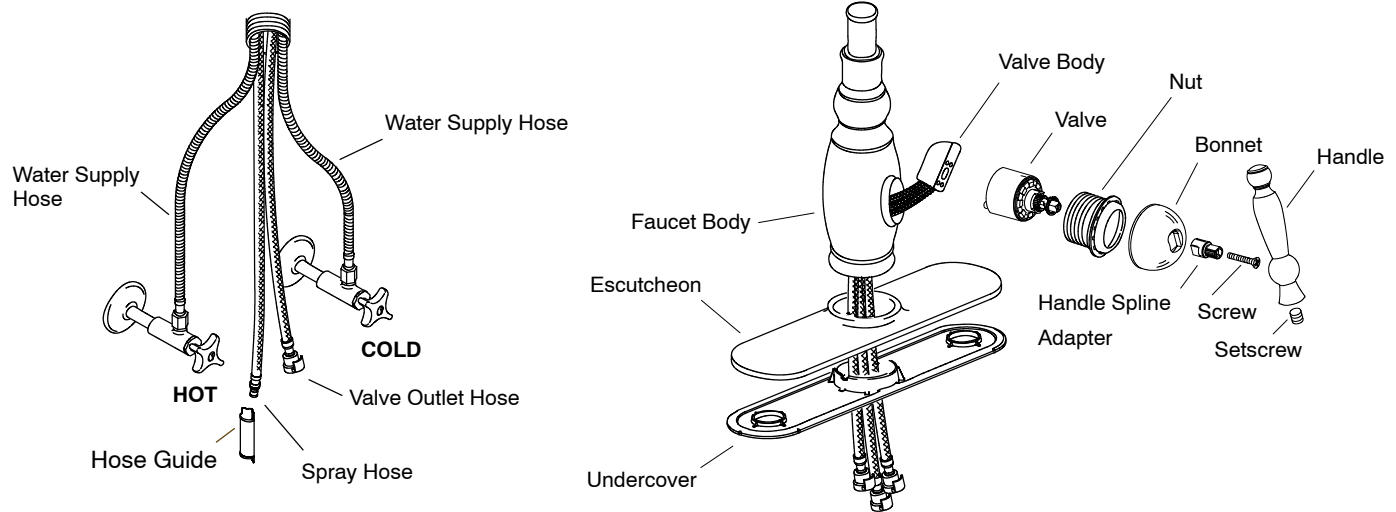

Tool Requirements



Pliers



Blade Screw-
driver

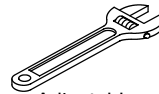

Adjustable
Wrench

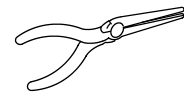

Needle Nose Pliers

Remove the Old Valve Body

NOTE: Depending upon the amount of space in the area under your sink, it may be easier to remove the entire faucet assembly for servicing.

NOTE: This installation is easier if performed with two people, particularly if performed with the faucet installed.

- Turn off the hot and cold water supplies.
- Disconnect the water supply hoses and spray hose quick connect.
- Pull the spray assembly out until the braided hose is past the handle.
- Using a pliers, pull the hose guide out of the spout body from below.
- Remove the setscrew, handle, screw, handle spline adapter, bonnet, nut, and valve.
- Push up on all three hoses from underneath the faucet assembly until the valve body is clear of the faucet body. If needed use a needle nose pliers to pull the valve assembly out.
- Pull the hoses clear of the faucet body. It may be necessary to push the hoses from below to help them through the faucet body.

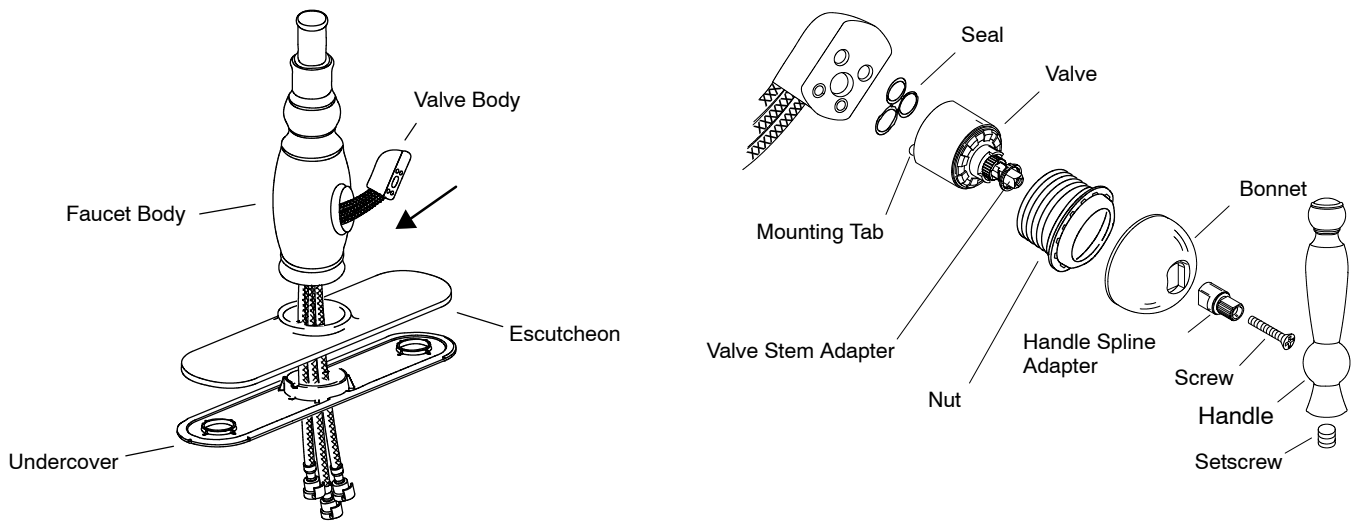

Install the New Valve Body

NOTE: Do not use excessive force when installing the hoses. Excessive force may damage the hoses.

- Push the valve body into the faucet body until it stops.
- Hold the valve body in place using light pressure and pull the hoses down.
- The valve body will rotate into the faucet body. Continue applying downward pressure until the flat face of the valve body is in a vertical position.
- Push the spray hose back through the threaded shank.
- Run the spray hose through the hose guide (shown on previous page) and reinstall.
- Slide the hose up and down to make sure it moves freely.
- Position the valve so the two tabs are positioned in the valve mounting holes. Make sure that the seal is in place on the valve.
- Place the nut over the valve and tighten. Slide the valve stem adapter onto the valve stem through the opening in the bonnet.
- Secure the bonnet and valve stem adapter with the supplied screw.
- Position the handle on the valve stem adapter and secure with the setscrew.
- Connect the quick connect hose and supply hoses.
- Turn on the water supply and check for leaks.

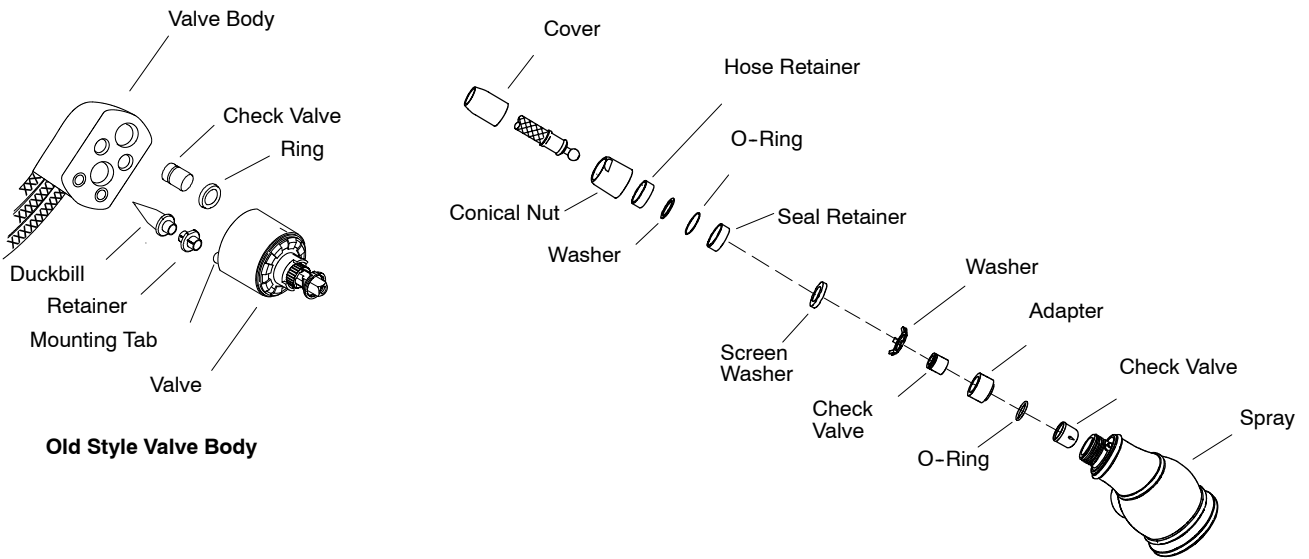

Install Check Valve in Spray (If Required)

NOTE: If your faucet had a check valve between the old valve body and valve, the check valve supplied with the kit needs to be installed inside the spray.

- Pull the spray assembly out until the braided hose is past the handle.
- Use a wrench to loosen the conical nut at the spray and disassemble the components.
- Starting at the spray, remove and discard the existing check valve. Install the check valve, O-ring, adapter, second check valve and washer. Make sure that the check valves are installed with the arrow pointing at the spray.
- Install the conical nut, hose retainer, washer , O-ring, seal retainer, and screen washer on the hose end. Install the spray on the hose.
- Turn on the water and check for leaks and spray operation.

USA: 1-800-4-KOHLER
Canadá: 1-800-964-5590
México: 001-877-680-1310
kohler.com

THE BOLD LOOK
OF **KOHLER**®

©2004 Kohler Co.

1033303-9-B