

\*\*订购时请说明颜色编号  
\*\*Color code must be specified when ordering

73164T-7 挂墙式恒温花洒龙头 73110T-7 挂墙式恒温浴缸花洒龙头	
安装之前	BEFORE YOU BEGIN
<p>所有的资料是按最新出版的产品资料编写而成。科勒公司保留任何时候不经通知即可改变产品特性、包装或产品可供类型的权利。</p> <p>说明书包括重要的安装、保养及清洁方面的内容，请把这些资料交给用户阅读。</p> <p><b>注意事项：</b></p> <ol style="list-style-type: none"><li>1. 最小供水压力：0.05MPa(0.5bar)。</li><li>2. 推荐冷热供水的静态压力：0.3MPa(3bar)。</li><li>3. 如果供水压力大于0.5MPa(5bar)，安装减压阀。</li><li>4. 热供水温度最低：50℃；最高：80℃。</li><li>5. 推荐的热供水温度：65℃。</li><li>6. 温度的设定基本范围为：20℃到49℃。</li><li>7. 安全限位温度：38℃。</li><li>8. 最高混合温度：49℃。</li><li>9. 花洒最高工作温度及环境温度：60℃。请特别注意花洒同花洒连接的臂管须远离浴霸，否则可能损坏花洒及其密封件，甚至对使用者造成伤害。</li></ol>	<p>All information is based on the latest product information available at the time of publication. Kohler Co. reserves the right to make changes in product characteristics, packaging, or availability at any time without notice. Please leave these instructions for the consumer. They contain important information.</p> <p><b>NOTES:</b></p> <ol style="list-style-type: none"><li>1. Minimum supply pressures: 0.05MPa(0.5bar).</li><li>2. Recommended supply static pressures: 0.3MPa(3bar) on hot and cold water.</li><li>3. Supply pressure greater than 0.5MPa(5bar): install a pressure reducer.</li><li>4. Hot water temperatures, minimum: 50°C, maximum:80°C.</li><li>5. Recommended hot water temperature: 65°C (energy-saving).</li><li>6. Setting range, approximately: 20°C to 49°C.</li><li>7. Safety stop at: 38°C.</li><li>8. Maximum mixed water temperature: 49°C.</li><li>9. The highest environment temperature for handshower &amp; showerhead is 60°C. Please keep handshower, showerhead and shower arm away from heater, or it may become damaged and cause injury to the user.</li></ol>
安装尺寸	ROUGH-IN DIMENSIONS
	73164T-7

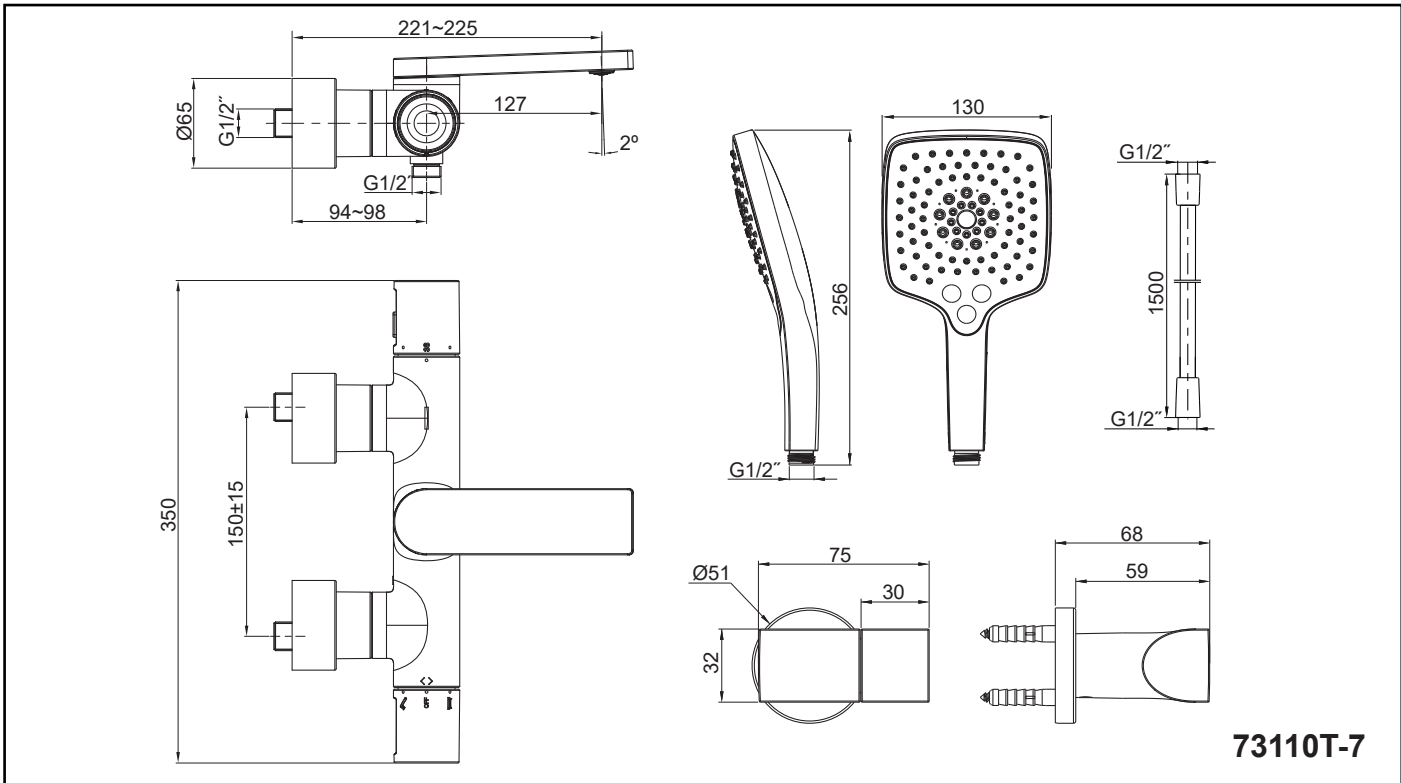

## 安装步骤

### 如何安装水龙头

为使安装顺利，G1/2"内螺纹管道配件(1)应已安装好，预留150mm的间距，保持水平，并垂直于装修好的墙面。彻底冲洗供水管，以清除管路中的杂质。

在螺纹上缠绕足够的密封胶带或涂合适的密封膏，安装两个接头(2)到冷热供水管上。

调节两个接头，使它们的中心距离为150mm并保持同一水平。它们凸出墙面的尺寸应该在40到47mm之间。将装饰罩组件(3)旋到接头(2)上，使其贴紧墙壁。

情形一：当接头(2)凸出墙面的距离是40~43mm时，将滤网(5)装到接头内。将垫片(7)装到螺母(6)内。

情形二：当接头(2)凸出墙面的距离是43~47mm时，将滤网(5)装到接头内。扔掉垫片(7)。

将龙头的螺母旋到接头上，用扳手锁紧螺母。后推并向右旋转装饰罩(4)，松开装饰罩，使其盖住螺母。

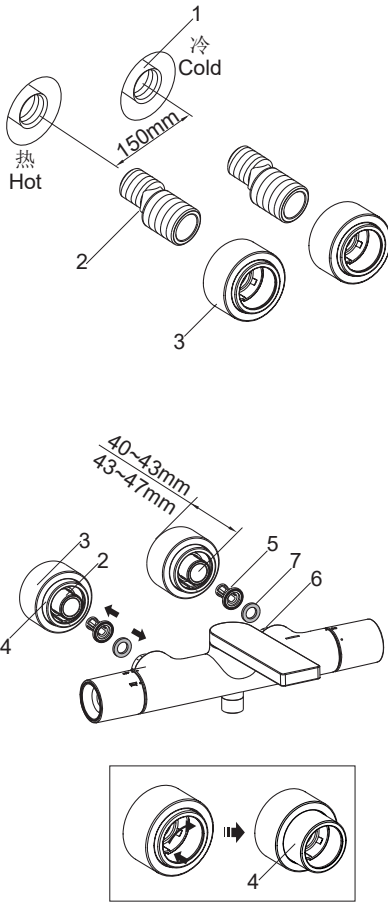

## INSTALLATION

### How to Install the Faucet

To perform installation, installer must provide G1/2" female supply fittings(1), spaced 150mm apart, horizontal and vertical to finished wall. Flush the water supply pipes thoroughly to remove debris.

Apply enough tape or suitable sealant on threads of offset connectors(2). Install the two offset connectors into the hot and cold supply pipes.

Adjust the center-to-center distance between the connectors to 150mm and horizontal. They should extend 40 to 47mm beyond the finished wall. Thread the escutcheon kits(3) onto the offset connectors(2) until they are against the finished wall.

Case 1: When the connector extends 40 to 43mm beyond the finished wall. Put the filters(5) into the connectors. Put the washer(7) into the faucet supply nuts(6).

Case 2: When the connector extends 43 to 47mm beyond the finished wall. Put the filters(5) into the connectors. Discard the washer(7).

Thread the faucet supply nuts onto the connectors and tighten by wrench. Push and turn right the escutcheons(4), loosen the escutcheon to cover the supply nut.

# KOHLER®

## SERVICE PARTS

### 零件图

# 柏诗

## COMPOSED

## Wall Mount Thermostatic Shower Faucet

### 73164T-7 挂墙式恒温花洒龙头

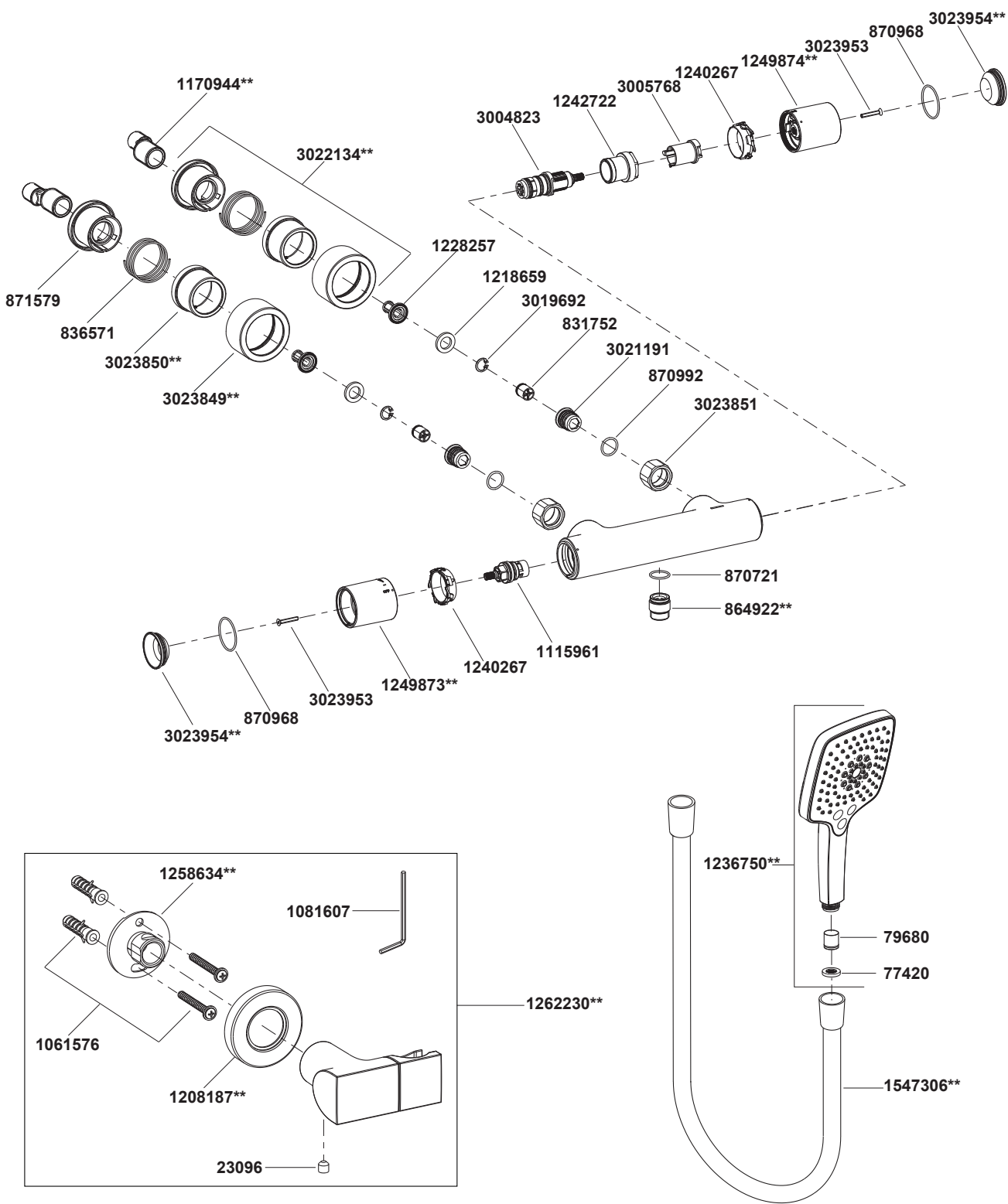

\*\*订购时请说明颜色编号

\*\*Color code must be specified when ordering

使用说明	OPERATION INSTRUCTIONS
<p>慢慢旋转温控把手即右把手，调整温度，安全限位温度为38°C。如想得到更高的温度，按住按钮继续旋转。</p>	<p>The temperature is set by slowly turning the temperature selector(right-hand handle). For safety reasons, there is a stop that limits temperature at 38°C. To get a higher temperature, push the button and continue turning the temperature selector counter-clockwise.</p>
<p>对于73164T，逆时针旋转左侧把手打开龙头，顺时针旋转关闭龙头。</p>	<p>For 73164T, turn on the faucet by turning left handle counter-clockwise, turn off the faucet by turning clockwise.</p>
<p>对于73110T，顺时针旋转左侧把手切换至手持花洒出水，逆时针旋转切换至浴缸出水口出水。</p>	<p>For 73110T, turn the left handle clockwise for hand-shower, turn counter-clockwise for bath spout.</p>
清洗说明	CLEANING INSTRUCTIONS
<p>适用于所有加工处理过的表面：以中性肥皂水清洗镀层表面，再以干净的软布彻底擦干整个表面，许多清洁剂，比如氨水、去污粉及洁厕灵等，会对电镀表面造成伤害，切忌使用。</p>	<p>All Finishes: Clean the finish with mild soap and warm water. Wipe entire surface completely dry with clean soft cloth. Many cleaners may contain chemicals, such as ammonia, chlorine, toilet cleaner etc. which could adversely affect the finish and are not recommended for cleaning.</p>
<p>有磨损性的清洁用具或清洁剂也不可使用于科勒牌的水龙头及其配件上。</p>	<p>Do not use abrasive cleaners or solvents on Kohler faucets and fittings.</p>

如何安装手持花洒	How to Install the Handshower
<p>先去掉出水口接头保护套(8)。</p>	<p>Remove the guard(8) on the outlet connector.</p>
<p>将垫片(9)装到软管(10)的A端，然后与出水口接头(11)连接。</p>	<p>Put the washer(9) into end A of the hose (10), and then connect to the faucet outlet(11).</p>
<p>将滤网垫片(13)装入到软管的B端，然后将B端与花洒(12)相连接。<b>注意：</b>不要过份拧紧。</p>	<p>Put the screen washer(13) into end B of the hose, connect end B of the hose to the handshower(12) inlet. <b>NOTE:</b> Don't over tighten.</p>
<p>可根据需要将单向阀(14)放入到花洒进水端。</p>	<p>Install the check valve(14) into the handshower if needed.</p>
如何安装花洒托架	How to Install the Bracket
<p>在墙面选一合适的位置来安装托架。避开墙内管道和电线。</p>	<p>Determine a suitable location on the finished wall to install the bracket, make sure it should avoid buried cables and pipes in the wall.</p>
<p>根据底座(16)孔距在墙面标记位置，依据胀塞(15)的直径打两个上下垂直的孔。安装胀塞。旋紧螺钉(17)，使底座固定紧贴墙壁。<b>注意：</b>底座方向应如图所示。</p>	<p>Mark bracket base(16) mounting holes locations on the wall according to the dimension. Drill two holes in the finished wall, the holes should match the anchors(15) and be vertically. Install the anchors. Tighten screws(17) to fix bracket base on the finished wall. <b>NOTE:</b> The bracket base direction as shown.</p>
<p>用六角扳手(19)旋松托架(18)下面的螺钉(20)，使托架能装入底座即可。在托架装饰罩(21)底部涂上一圈密封油灰或密封胶，用六角扳手和螺钉将托架和装饰罩固定到墙壁上。</p>	<p>Loosen the screw(20) in the bottom of the bracket(18) with the hex wrench(19), make the bracket can be installed. Apply a ring of plumber putty or other sealants around the underside of the bracket escutcheon(21). Put the bracket with escutcheon onto the bracket base and lock them by screw and hex wrench. Remove any excess putty or sealant.</p>
<p>去除多余油灰或密封胶。</p>	
安装结果检查	INSTALLATION CHECKOUT
<p>检查并确保所有的衔接处都已拧紧。确保手柄处于关闭位置。打开排水系统和主要供水源，检查并修理有漏水的接口。</p>	<p>Ensure that all coupling nuts are tight. Ensure that the handle is in the off position. Turn on the main water supply, and check for leaks. Repair as needed.</p>
<p>对于73110T，取下花洒(12)，并用工具(22)取下起泡器组件(23)。对于73164T，取下花洒。</p>	<p>For 73110T, remove the handshower (12). Remove the aerator(23) by key(22). For 73164T, remove the handshower.</p>
<p>打开冷热水，让水流出约一分钟以清除杂质。检查渗漏。清洗起泡器。关闭水龙头，装回起泡器组件和花洒。</p>	<p>Run hot and cold water through the faucet for about one minute to remove any debris. Check for leaks. Remove any debris from the aerator assembly. Shut the faucet off, and reinstall the aerator assembly and handshower.</p>



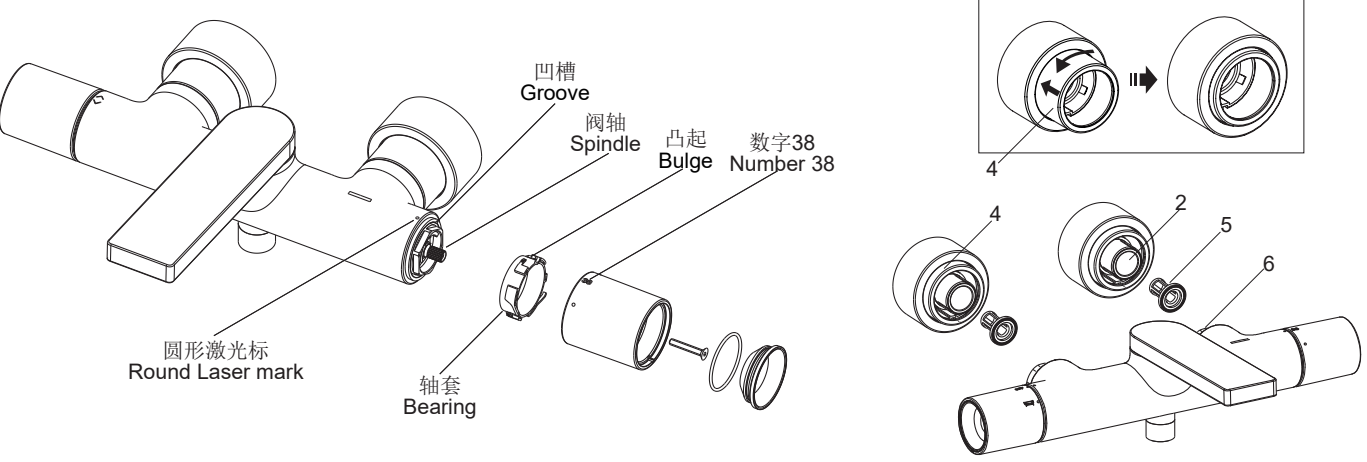

温度测试与调整

温度测试前，应确保供水系统充分且有较高温度。温度把手在38°C位置时，打开龙头让水流出。进行温度测量，出厂时温度设定在36~38°C范围内。如超出这个范围，要进行调整。

调整步骤如下：

取下把手上盖，用螺丝刀取下螺钉和温控把手组件。

在正常水流状态下，由冷水位置开始慢慢转动温控阀轴(保持同一方向)直至获得38°C水流。如果温度超过38°C，回到冷水位置重新调整。温度稳定后，不要转动温控阀轴，将轴套上的凸起对准本体上的凹槽装入。安装温控把手，使得温控把手上的数字38与本体上的圆形激光标对齐。

如图示锁紧螺钉，安装把手上盖。

如何清洗滤网

滤网(5)可起到保护水龙头的作用，但长时间使用后，水垢或杂质可能会堵塞滤网降低水流量。

如果有类似情况发生，先关闭水源，后推并旋转装饰罩(4)，用扳手拧松螺母(6)，卸下龙头取出接头(2)内的滤网。

用热醋清洗滤网。然后按照图示装回。

Verification and Setting

Make sure the water feeds of the faucet have reach the highest temperature by running the water sufficiently. When the selector in position 38°C, the water temperature should be within a range of 36°C to 38°C, as measured by a thermometer. If not, the installer can adjust the setting.

Proceed with the setting as follows:

Remove the handle plug. Uninstall the screw with the screwdriver, remove the handle kit.

Under the normal condition of water flow, slowly turn the temperature selector(always in the same direction) from the cold water position until the water temperature reaches 38°C. If the temperature goes over 38°C, go back to the “cold” setting and reset it. When the temperature is stable, do not turn the cartridge spindle. Make sure the bulge of the bearing aligns with the groove of the body. Insert the bearing. Install the temperature handle. Make sure the number 38 on the temperature handle is aligned with the round laser mark on the faucet body.

Tighten the screw, put on the handle plug as shown.

How to Clear the Filter

The filters(5) protecting the faucet device may get obstructed and reduce water flow.

When this happens, turn off the water supply, push back and rotate the escutcheon(4), loosen the supply nut(6) by wrench, take out the filters in the connectors(2) after removing the faucet.

Clean the filters by soaking them in warm vinegar. Reinstall them as the figure.

如果供水的水质较硬或长时间使用，水垢或杂质会阻塞温控阀上的滤网，流量会降低。需要清理请按照下列步骤进行：

关闭供水系统，使流量阀处于打开位置后进行温控阀的拆卸作业。温控阀是较敏感的配件，要十分小心。

拆卸前确保指示标识与数字38对齐。拆卸把手组件(Fig.1)。

将螺母和塑料套卸下。小心地卸下温控阀(Fig.2)。用热醋进行清洗。

清洗后，将塑料套和螺母(限位组件)装到温控阀上，使塑料套上的定位柱嵌入温控阀的限位槽内(Fig.3)。

将塑料套上的定位柱与龙头本体内孔凹槽对齐，装入温控阀并锁紧螺母(Fig.4)。

**注意：**确保拆卸、安装过程中不要转动温控阀轴。如不小心转动了阀轴，要调整阀轴使外齿上的圆孔标识与相邻的塑料套上的凹槽对齐(Fig.5)，或者按前述方法进行调整。

安装阀轴及温控把手(不要转动温控阀轴)，使参考标识同数字38对齐，拧紧螺钉。安装把手上盖(Fig.1)。

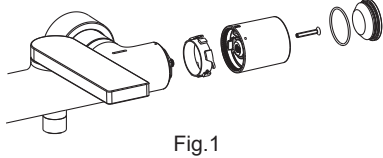

Fig.1

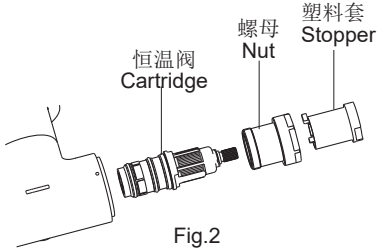

Fig.2

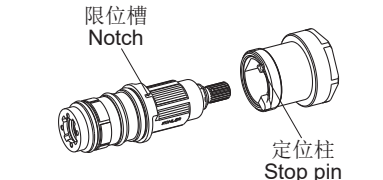

Fig.3

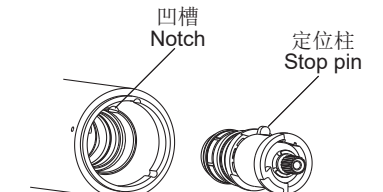

Fig.4

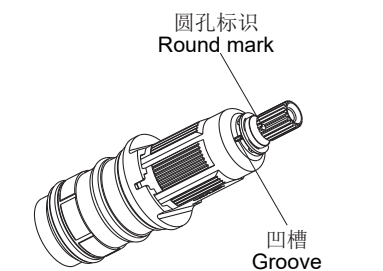

Fig.5

Very hard water can obstruct filters on the thermostatic cartridge and reduce the water flow. Please clean the cartridge as follows:

Shut off the water supply of the faucet and turn on the water flow valve, then proceed to remove the cartridge. The cartridge is sensitive part, please be careful.

Before your action, make sure the reference mark is aligned with number 38. Remove the handle kit(Fig.1).

Unscrew the nut and stopper. Remove the cartridge cautiously(Fig.2). Clean the thermostatic cartridge by soaking it in warm vinegar.

After cleaning, install the “stop assembly” back on the cartridge, adjust the stop pin into the notch(Fig.3).

Install the assembly cartridge and stop in the body, adjust the stop pin into the notch(Fig.4).

**NOTE:** Do not turn the cartridge when reinstalling it. If you turned it accidentally, you should adjust it and be sure that the round mark is correctly in line with the groove(Fig.5), or readjust as per the steps of verification and setting.

Install the bearing and temperature selector (without turning the spindle) lining the number 38 with the reference mark. Tighten the handle with the screw. Put on the handle plug.