

99741T-C9 恒温三出水淋浴柱(硬管连接)

安装之前

所有的资料是按最新出版的产品资料编写而成。科勒公司保留任何时候不经通知即可改变产品特性、包装或产品可供类型的权利。

说明书包括重要的安装、保养及清洁方面的内容，请把这些资料交给用户阅读。

注意事项：

1. 最小供水压力：0.05MPa(0.5bar)。
2. 推荐冷热供水的静态压力：0.3MPa(3bar)。
3. 如果供水压力大于0.5MPa(5bar)，安装减压阀。
4. 热供水温度最低：50°C；最高：80°C。
5. 推荐的热供水温度：65°C。
6. 温度的设定基本范围为：20°C到49°C。
7. 安全限位温度：37°C。
8. 最高混合温度：49°C。
9. 花洒最高工作温度及环境温度：60°C。请特别注意花洒同花洒连接的臂管须远离浴霸，否则可能损坏花洒及其密封件，甚至对使用者造成伤害。

BEFORE YOU BEGIN

All information is based on the latest product information available at the time of publication. Kohler Co. reserves the right to make changes in product characteristics, packaging, or availability at any time without notice.

Please leave these instructions for the consumer. They contain important information.

NOTES:

1. Minimum supply pressures: 0.05MPa(0.5bar).
2. Recommended supply static pressure: 0.3MPa(3bar) on hot and cold water.
3. Supply pressure greater than 0.5MPa(5bar): install a pressure reducer.
4. Hot water temperatures, minimum: 50°C, maximum:80°C.
5. Recommended hot water temperature: 65°C (energy-saving).
6. Setting range, approximately: 20°C to 49°C.
7. Safety stop at: 37°C.
8. Maximum mixed water temperature: 49°C.
9. The highest environment temperature for handshower & showerhead is 60°C. Please keep the handshower, showerhead and shower arm away from heater, or it may become damaged and cause injury to the user.

使用说明

慢慢旋转温控把手即右把手，调整温度，安全限位温度为37°C。如果想得到更高温度，按住按钮继续逆时针旋转。

左把手即切换把手，顺时针转动，头顶花洒出水；逆时针转动，手持花洒或龙头出水口出水。龙头上的切换器处于正常位置时出水口出水，提起切换器手持花洒出水。

HANDLE OPERATION

The temperature is set by slowly turning the temperature selector(right-hand handle). For safety reasons, there is a stop that limits temperature to 37°C. To get a higher temperature, push the button and continue turning the temperature selector counter-clockwise.

Water flow is set by turning the left-hand handle. Turn the left-handle clockwise, water will flow from the showerhead; turn it counter-clockwise, the handshower or spout will work. Water flows out from spout when faucet diverter is in the normal position and it's diverted to handshower when the diverter knob is lifted.

安装尺寸

ROUGH-IN DIMENSIONS

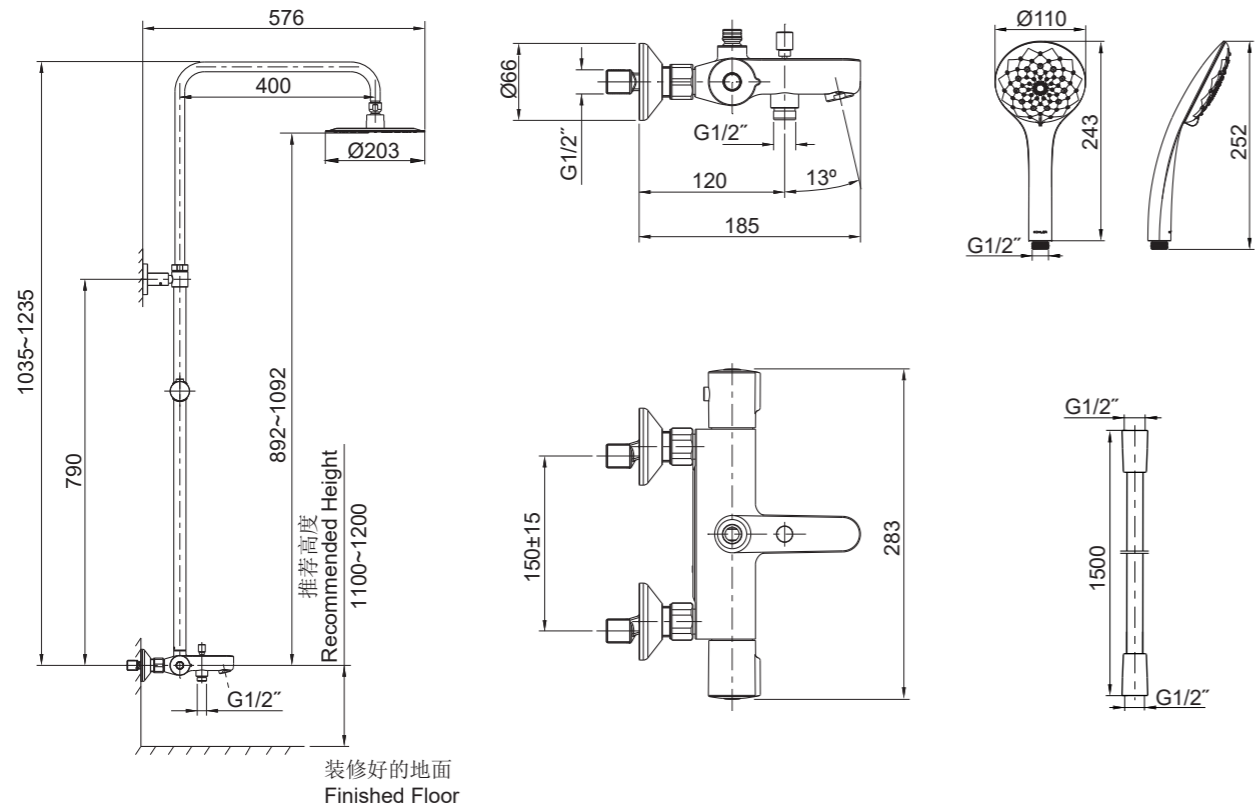

安装步骤

INSTALLATION

如何安装水龙头

为使安装顺利，G1/2"内螺纹管道配件(1)应已安装好，预留150mm的间距，保持水平。管道配件要垂直并不能凸出装修好的墙面。热供水管装在左边。彻底冲洗供水管，以清除管路中的杂质。

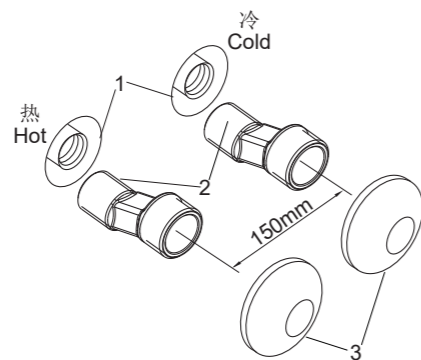

在螺纹上缠绕足够的密封胶带或涂合适的密封膏，安装两个接头(2)到冷热供水管上。调节两个接头，使其中心距离为150mm并保持同一水平。它们凸出墙面29mm。

把装饰罩(3)旋入接头，紧贴墙壁。

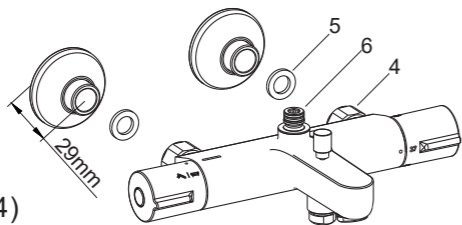

把密封垫片(5)放入水龙头螺母(4)内。保持水龙头出水口(6)朝上，把螺母旋到接头上，并拧紧。

How to Install the Faucet

To perform installation, installer must provide G1/2" female supply fittings(1), spaced 150mm apart and horizontally. The supply fittings should be vertical and not beyond the finished wall. Hot supply pipe must be located on the left. Flush the water supply pipes thoroughly to remove debris.

Apply enough tape or suitable sealant on threads of offset connectors(2). Install the two offset connectors into the hot and cold supply pipes. Adjust the center-to-center distance between the connectors to 150mm horizontally. They should extend 29mm beyond the finished wall.

Thread the escutcheons(3) onto the connectors until they are against the finished wall.

Put washers(5) into supply nuts(4) of the faucet. Keeping the faucet outlet(6) upwards, thread the faucet supply nuts onto the connectors and tighten.

KOHLER®

SERVICE PARTS

零件图

齐悦

JULY

Thermostatic 3-Way Shower Column

99741T-C9 恒温三出水淋浴柱(硬管连接)

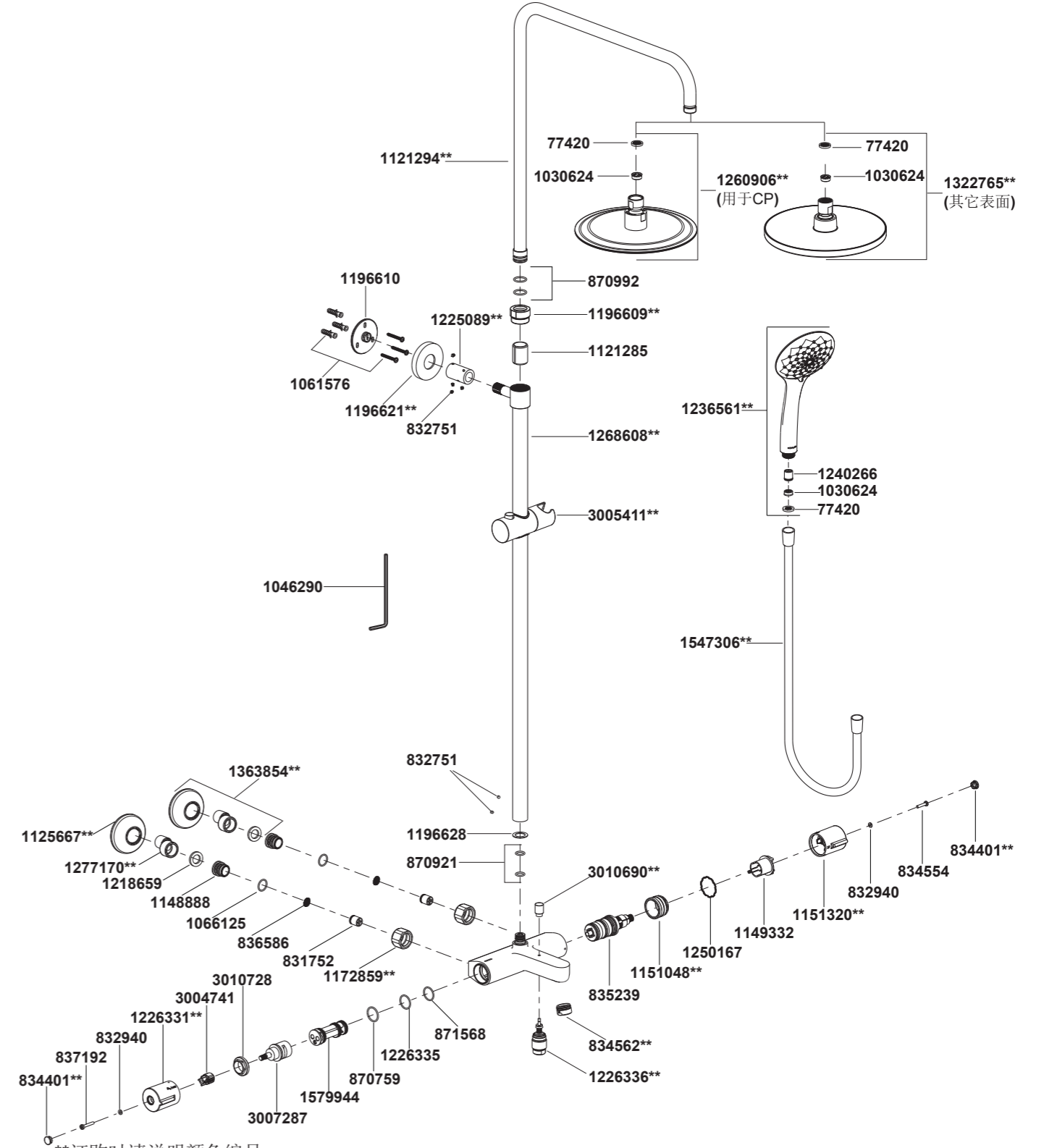

**订购时请说明颜色编号

**Color code must be specified when ordering

清洗说明

适用于所有加工处理过的表面：以中性肥皂水清洗镀层表面，再以干净的软布彻底擦干整个表面，许多清洁剂，比如氨水、去污粉及洁厕灵等，会对电镀表面造成伤害，切忌使用。

有磨损性的清洁用具或清洁剂也不可适用于科勒牌的水龙头及其配件上。

CLEANING INSTRUCTIONS

All Finishes: Clean the finish with mild soap and warm water. Wipe entire surface completely dry with clean soft cloth. Many cleaners may contain chemicals, such as ammonia, chlorine, toilet cleaner etc. which could adversely affect the finish and are not recommended for cleaning.

Do not use abrasive cleaners or solvents on Kohler faucets and fittings.

如何安装淋浴柱

试装淋浴柱组件(12)，以确定上底座(8)安装位置。将连接管(11)与底座连接(注意：底座上的箭头朝上)，并用螺钉(14)锁紧。将连接管另一端套在淋浴柱组件接头(13)上。

将垫片(16)放到龙头出水口(6)上。连接龙头出水口与淋浴柱组件。将淋浴柱组件竖直放置。调整连接管，使淋浴柱组件平行于墙面。用铅笔标记底座孔位。分别拆下滑杆组件和连接管(注意：切勿弄丢螺钉)。

根据胀塞(7)直径在墙面上标记处打孔。放入胀塞，用自攻螺钉(9)固定底座(注意：底座上箭头朝上)。

确认垫片(16)在龙头出水口上。将连接管和装饰罩(10)套在淋浴柱组件的接头上。将淋浴柱组件安装到龙头上。滑动连接管使其套在底座上，用六角扳手(15)和螺钉锁紧固定。旋紧装饰罩直至接触墙壁。保持弯管出水口朝前，且淋浴柱组件平行于墙面，用螺钉将接头和连接管连接，并用六角扳手锁紧。

用六角扳手锁紧螺钉(17)。

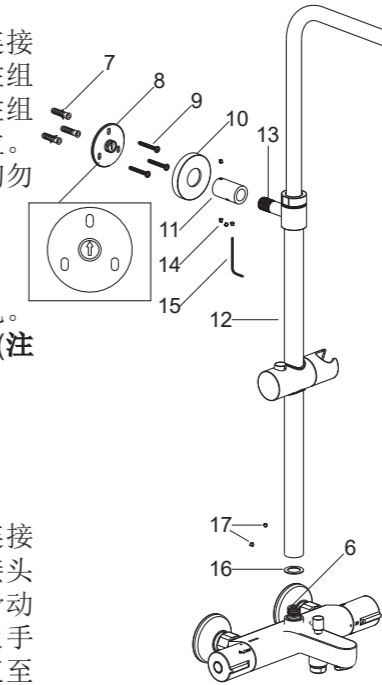

How to Install the Column

Rehearse the shower column kit(12) installation for the base(8) mounting location determination. Connect the tube joint(11) and the base(注意：The arrow in the base is up), tighten them with screws(14). Set the other end of the tube joint on the supporter(13) of shower column.

Put the washer(16) onto faucet outlet(6). Connect the faucet outlet and shower column. Place the column kit upright and parallel to the finished wall. Mark the hole of base with a pencil. Uninstall the shower column kit and tube joint.(注意：Don't lose the screws.)

Drill hole in the finished wall according to the diameter of the anchors(7) and the position of mounting base. Insert the anchor into the hole. Secure the mounting base by self-tapping screws(9). (注意：The arrow in the base is upward).

Ensure the washer(16) on faucet outlet. Install the tube joint and escutcheon(10) onto the supporter of shower column. Connect the shower column kit and faucet. Slide the tube joint onto the base, tighten screws with hex wrench(15). Screw the escutcheon until it against wall. Make sure the outlet of shower column faces the front, and the shower column is parallel to the finished wall. Connect the supporter and tube joint with screw, tighten them by hex wrench.

Tighten the screws(17) with hex wrench.

如何安装手持花洒

安装手持花洒(18)之前，调整切换把手(19)和切换器(20)处于手持花洒出水位置，并打开冷热水源冲掉管路中的杂质。

根据需要将限流器(21)塞入手持花洒水口，将滤网垫片(33)放入软管(22)接头内，用软管连接接头(23)和手持花洒。锁紧所有衔接螺母。

将手持花洒挂在花洒挂架(24)上。

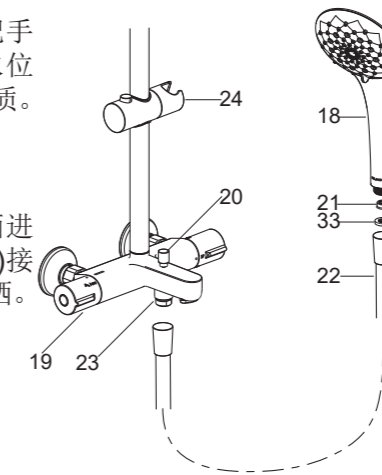

How to Install the Handshower

Ensure that the diverter handle(19) and diverter knob(20) are in the position for handshower. Flush hot and cold water supplies to remove any debris before the handshower(18) is installed.

Put the regulator(21) into the handshower if needed. Put the screen washer(33) into the shower hose(22) connector. Connect the connector(23) and handshower with hose. Tighten all the connectors.

Hang the handshower on the shower bracket(24).

如何安装头顶花洒

装头顶花洒(25)之前, 调整切换把手(19)至头顶花洒出水状态, 打开水源冲掉管路中的杂质。

取出垫片(26), 根据需要将限流器(27)放入到头顶花洒, 再装回垫片。将头顶花洒旋到弯管组件出水口上, 用带状扳手锁紧。

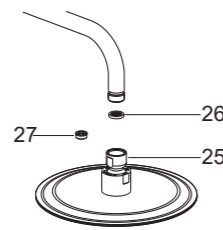

How to Install the Showerhead

Turn the diverter handle(19), run hot and cold water for about one minute to remove any debris before the showerhead(25) is installed.

Take out the washer(26) and install the regulator(27) into the showerhead if needed, reinstall the washer. Tighten the showerhead onto the tube kit outlet with strap wrench.

安装结果检查

检查并确保所有的衔接处都已拧紧, 确保手柄在关的位置。打开排水系统和主要供水源, 检查并修理有漏水的接口。

取下起泡器(28)。打开冷热水, 让水流出约一分钟, 以清除杂质。检查渗漏。关闭水龙头, 装回起泡器。

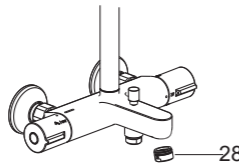

INSTALLATION CHECKOUT

Ensure all connections are tight. Ensure the handle is in the off position. Turn on the drain and main water supply, and check for leaks. Repair as needed.

Remove the aerator(28). Run hot and cold water through the faucet for about one minute to remove any debris. Check for leaks. Shut off the faucet, and reinstall the aerator.

维护与保养

温度测试与调整

温度测试前, 应确保供水系统充分且有较高的温度。温度把手在37°C位置时, 打开龙头让水流出。进行温度测量, 出厂时温度设定在36~38°C范围内。如果超出这个范围, 要进行调整。调整步骤如下:

取下把手上盖, 用螺丝刀取下螺钉温控把手组件(请勿丢失垫片)。

在正常水流状态下, 由冷水位置开始慢慢转动温控阀轴(保持同一方向直至获得37°C水流。如果温度超过38°C, 回到冷水位置重新调整。

温度稳定后, 不要转动温控阀轴, 安装温控把手, 使得温控把手上的数字37与本体上的圆形激光标对齐。确保垫片套在螺钉上, 锁紧螺钉, 安装把手上盖。

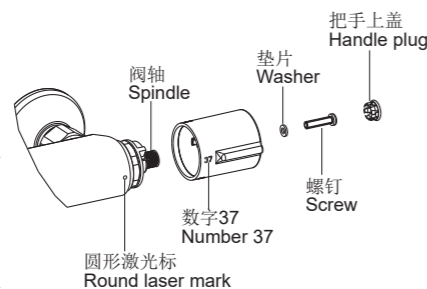

CARE AND MAINTENANCE

Verification and Setting

Make sure the water feeds of the faucet have reach the highest temperature by running the water sufficiently. When the selector in position 37°C, the water temperature should be within a range of 36°C between 38°C, as measured by a thermometer. If not, the installer can adjust the setting. Proceed with the setting as follows:

Remove the handle plug. Uninstall the screw with screwdriver. Remove the handle kit. (Do not lose the washer)

Under the normal condition of water flow, slowly turn the temperature selector (always in the same direction) from the cold water position until the water temperature reaches 37°C. If the temperature goes over 38°C, go back to the "cold" setting and reset it.

When the temperature is stable, do not turn the cartridge spindle. Install the temperature handle. Ensure the number 37 on the temperature handle is aligned with the round laser mark on the faucet body. Tighten the screw with the washer. Install the handle plug as shown.

如何清洗滤网

滤网垫片(29)可起到保护龙头的作用, 但长时间使用后, 水垢或杂质可能会堵塞滤网, 降低水流量。如果有类似情况发生, 卸下龙头, 用六角扳手(12mm)将底座(30, 顺时针)拧下, 取下螺母(31)、滤网垫片(29)以及单向阀(32)。用热醋清洗滤网。然后按照图示装回。(注意: 单向阀必须按原方向装回)。

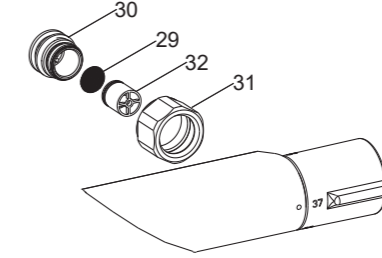

How to Clear the Filter

The filters(29) can protect the faucet, but it may get obstructed and reduce the water flow after a long time of use. If this happens, unscrew the bushes(30, left thread) with a wrench (12mm) and take out the nuts(31), filters(29) and check valves(32) after removing faucet. Clean the filters by soaking them in warm vinegar. Reinstall them as figure. (NOTE: Check valves should reinstall as original orientation).

如何清洗温控阀

如果供水水质较硬或长时间使用, 水垢或杂质会阻塞温控阀上的滤网, 流量会降低。需要清理请按照下列步骤进行:

关闭供水系统, 使流量阀处于打开位置后进行温控阀的拆卸作业。温控阀是较敏感的配件, 要十分小心。

拆卸前确保把手上的数字37与本体上的圆形激光标对齐。取下把手上盖, 用螺丝刀取下螺钉(请勿丢失垫片), 拔出温控把手组件。(Fig.1)

将螺母和塑料套卸下。小心地卸下温控阀(Fig.2)。用热醋进行清洗。

清洗后将塑料套和螺母(限位组件)装到温控阀上, 使塑料套的定位柱嵌入温控阀的限位槽内(Fig.3)。

将塑料套的定位柱与龙头本体孔凹槽对齐, 装入温控阀并且锁紧螺母(Fig.4)。

注意: 确保拆卸、安装过程中不要转动温控阀轴。如不小心转动了阀轴, 要调整阀轴使外齿上的圆孔标识与相邻的塑料套上的凹槽对齐(Fig.5), 或者按前述方法进行调整。

安装温控把手(不要转动温控阀轴)使数字37同圆形激光标对齐, 确保垫片套在螺钉上, 锁紧螺钉, 安装把手上盖(Fig.1)。

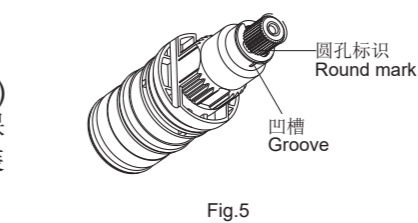
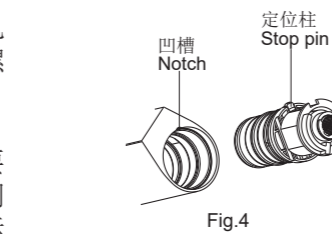
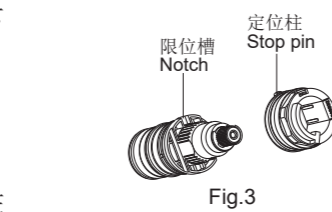
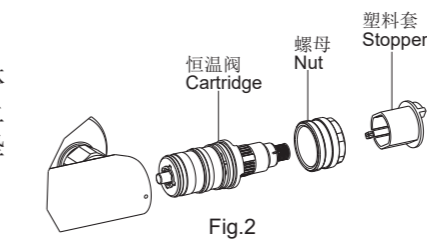
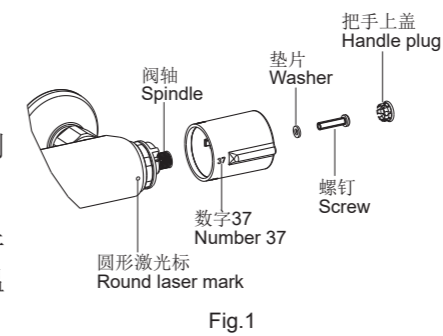

How to Clear the Thermostatic Cartridge

Very hard water can obstruct filters on the thermostatic cartridge and reduce water flow. Please clean the cartridge as follows:

Shut off the water supply of the faucet and open the water flow handle, then proceed to remove the cartridge. The cartridge is a sensitive part, please be careful.

Before your action, make sure the number 37 on the handle is aligned with the round laser mark on the faucet body. Remove the handle plug. Uninstall the screw with screwdriver(Do not lose the washer). Remove the handle kit. (Fig.1)

Unscrew the nut and stopper. Remove the cartridge cautiously(Fig.2). Clean the thermostatic cartridge by soaking it in warm vinegar.

After cleaning, install the "stop assembly" back on the cartridge, adjust the stop pin and fit it into the notch(Fig.3).

Install the assembly cartridge and stop in the body, adjust the stop pin into the notch(Fig.4).

NOTE: Do not turn the cartridge when reinstalling it. If you turn it accidentally, please adjust it and be sure that the round mark is correctly in line with the groove(Fig.5), or readjust it per the steps of verification and setting.

Install the temperature selector (do not turn the spindle). Make sure the number 37 is aligned with the round laser mark. Tighten handle with the screw with the washer. Install the handle plug(Fig.1).