

Record your model number: \_\_\_\_\_

**⚠ WARNING: Risk of scalding.** High water temperature can cause severe burns. Verify that the delivered water is set at or below 120°F (49°C). Refer to the temperature adjustment steps in the trim installation instructions.

Follow all local plumbing and building codes.

Your product may appear different than the one illustrated. The installation procedure is the same.

**1A. Backing Board**

**1B. Sealant Tape**

**2A.** 4" (102 mm) to the finished wall surface.

**2B.** 3-3/16" (81 mm) to the finished wall surface.

**3A.** Install a backing board at the correct depth from the finished wall surface.

**4A.** Position the G3/4 inlet ports on the left.

**5A.** G3/4 Hot Supply

**5B.** G3/4 Cold Supply

**6A.** To invert the hot and cold supply lines, use a 12 mm socket to swap the filter cartridges.

**7A.** Connect G1/2 piping for the shower fittings. Connect only to the top or bottom port for each valve.

**8A.** Install the supplied plugs to unused outlets.

**9A.** Check all connections for leaks.

**10A.** Complete the finished wall within the MIN and MAX lines. Install the trim following the instructions packed with the trim.

**Maintenance**

**11A. Clean the Filters:** Remove the trim parts.

**11B.** Remove the cartridges. Note the hot and cold positions for reinstallation.

**11C.** Rinse debris from the filters, then reinstall all parts.

**Need help?** Contact our Customer Service.

• Email: [technicalsupport@kohler.co.uk](mailto:technicalsupport@kohler.co.uk)

• 0800 001 4466

1

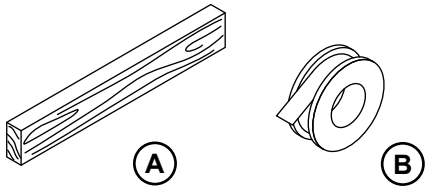

2

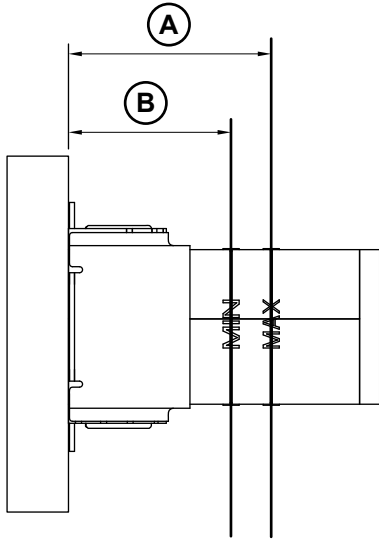

3

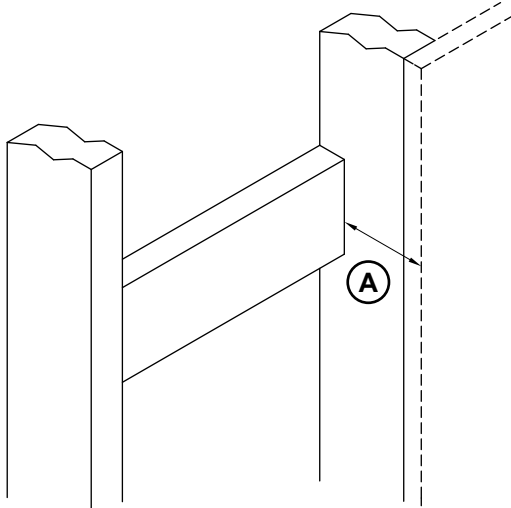

4

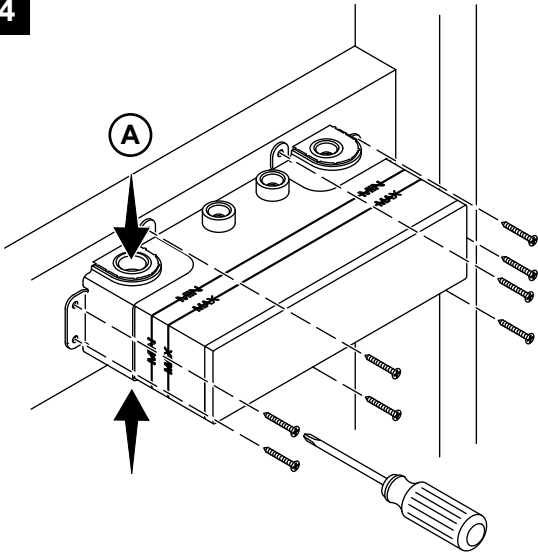

5

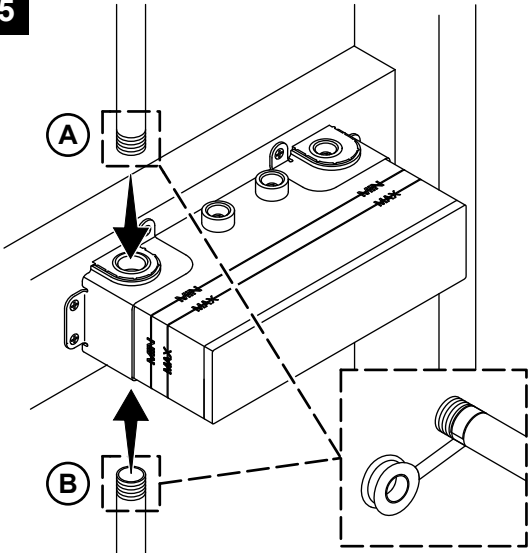

6

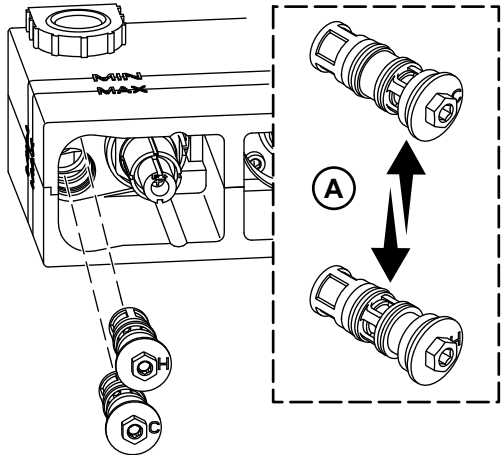

This product is covered under the KOHLER® Taps and Shower Valves Five-Year Limited Guarantee. For a hardcopy of guarantee terms, contact Customer Service.

