

1428547-W2

Record your model number: _____

Follow all local plumbing and building codes.

Follow steps 1-4 for elbow installations. Follow steps 5-8 for shower bar installations.

3A. Cap installation.

3B. Handshower hose installation.

4A. Periodically rinse debris from the screen washer.

The following steps apply to shower bar installations.

7A. Cap installation.

7B. Handshower hose installation.

8A. Periodically rinse debris from the screen washer.

Need help? Contact our Customer Service.

- Email: technicalsupport@kohler.co.uk

- 0800 001 4466

This product is covered under the **KOHLER® Showerheads, Shower Fittings, Bathroom Accessories, and Wastes Two-Year Limited Guarantee.** For a hardcopy of guarantee terms, contact Customer Service.

1

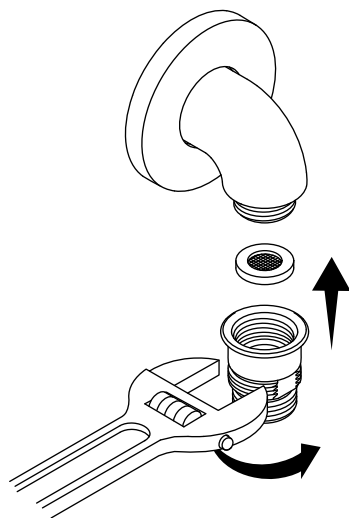

2

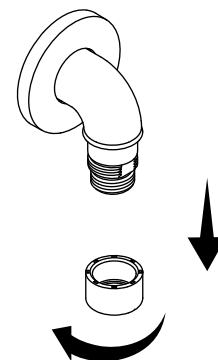

3

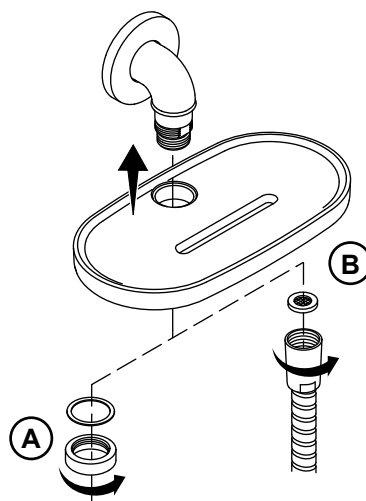

4

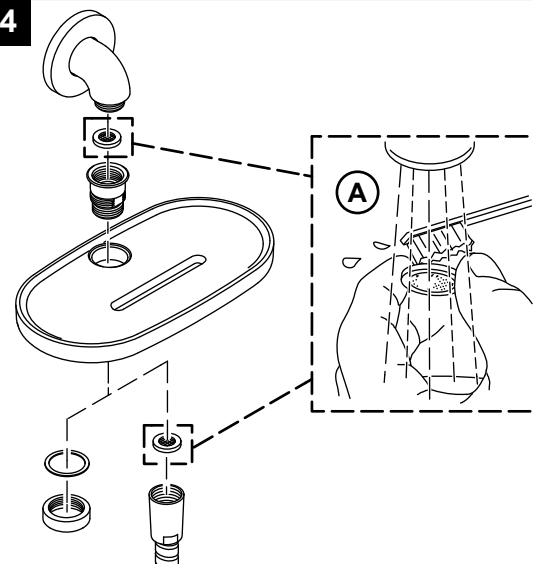

5

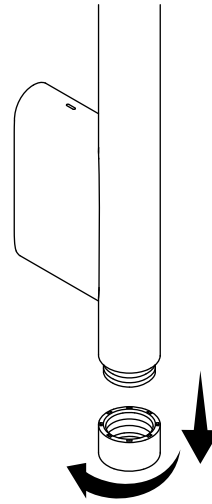

6

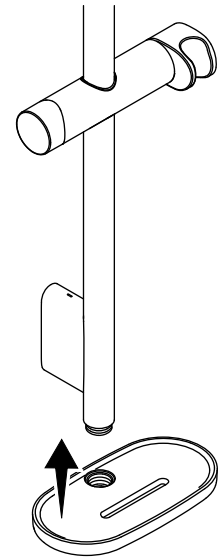

7

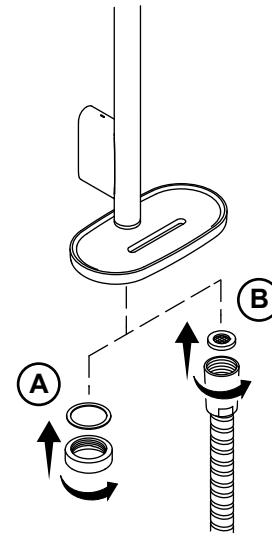

8

