



1430523-W2

Record your model number: _____

Follow all local plumbing and building codes.

1A. Sealant Tape

5A. Check all connections for leaks.

Need help? Contact our Customer Service.

- Email: technicalsupport@kohler.co.uk
- 0800 001 4466

This product is covered under the **KOHLER® Showerheads, Shower Fittings, Bathroom Accessories, and Wastes Two-Year Limited Guarantee**. For a hardcopy of guarantee terms, contact Customer Service.

1

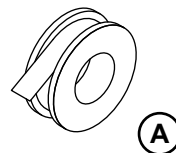

2

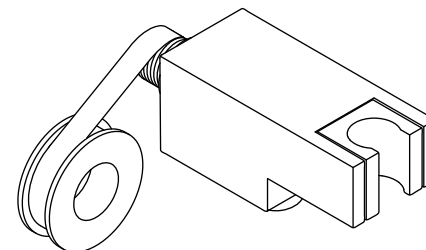

3

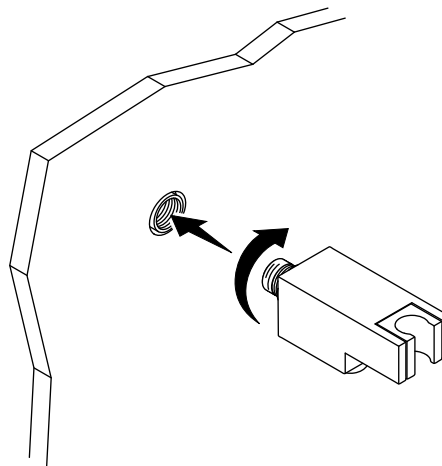

4

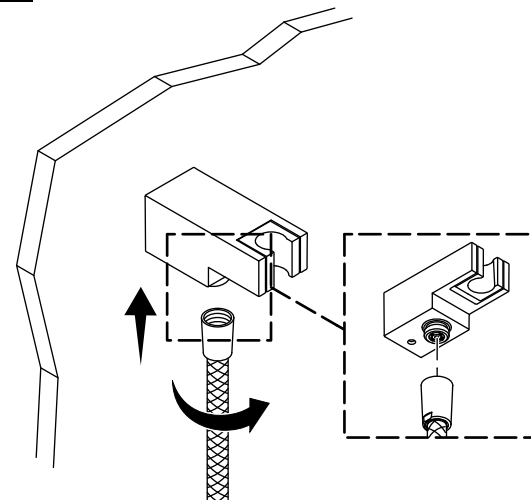

5

