

25778T 晨雨 头顶/手持二合一花洒 2.5 GPM  
25778T 2-IN-1 MULTIFUNCTION SHOWER COMBO 2.5 GPM

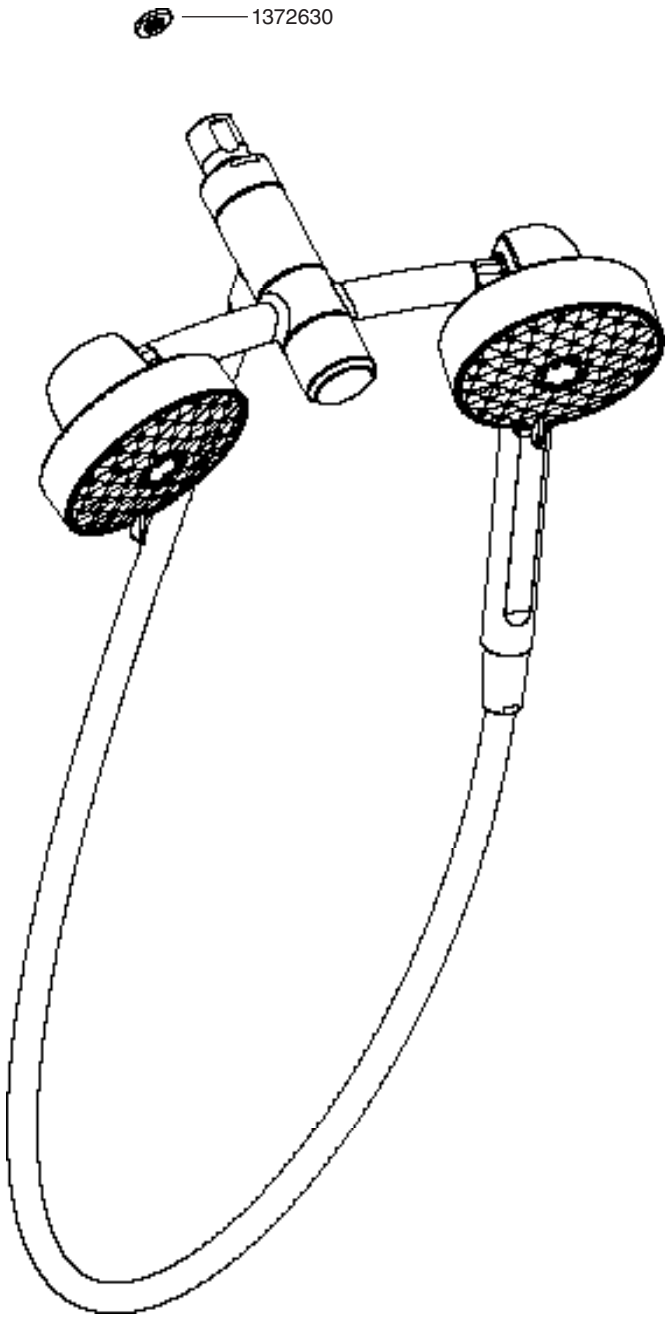

25778T 晨雨 头顶/手持二合一花洒 2.5 GPM

安装之前

所有的资料是按最新出版的产品资料编写而成。科勒公司保留任何时候不经通知即可改变产品特性、包装或产品可供类型的权利。

说明书包括重要的安装、保养及清洁方面的内容，请把这些资料交给用户阅读。

注意事项：

- 1. 一定要先彻底冲洗供水管以清除管道中的杂质。
- 2. 花洒最高工作压力：0.5MPa(5bar)。水压超过0.5MPa(5bar)须安装减压阀。花洒最高工作温度及环境温度：60°C。请特别注意花洒同花洒连接的臂管须远离加热器，否则可能损坏花洒及其密封件，甚至对使用者造成伤害。

BEFORE YOU BEGIN

All information is based on the latest product information available at the time of publication. Kohler Co. reserves the right to make changes in product characteristics, packaging, or availability at any time without notice.

Please leave these instructions for the consumer. They contain important information.

NOTES:

- 1. Flush the water supply pipes thoroughly to remove debris.
- 2. The highest working pressure for spray is 0.5MPa(5 bar). If it exceeds 0.5MPa(5 bar), a pressure reducer is needed. The highest water and environment temperature is 60°C. Please keep handshower, showerhead and the shower arm away from heater, or it may become damaged and cause injury to the user.

安装尺寸

单位：毫米

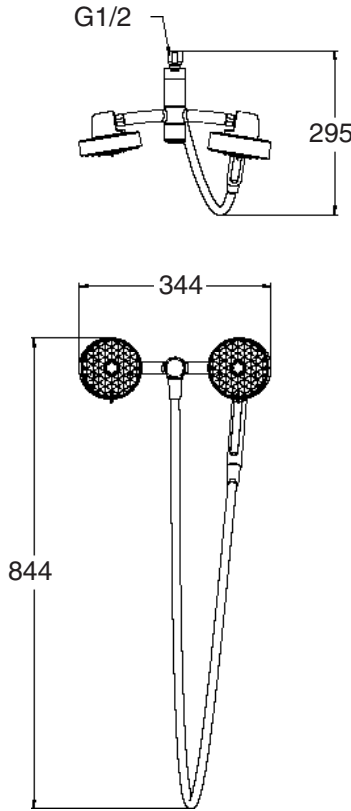

ROUGH-IN DIMENSIONS

Unit: mm

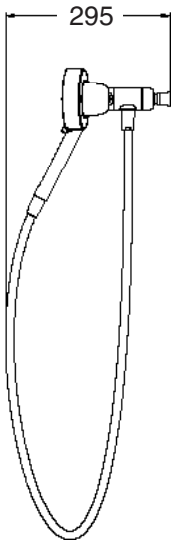

安装步骤

INSTALLATION

打开水源通过花洒臂（1，客户自备）冲洗掉供水管内杂质。

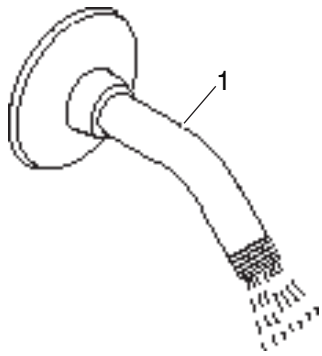

Flush the water supplies through the shower arm(1, not supplied).

将密封胶带缠绕在花洒臂螺纹上。

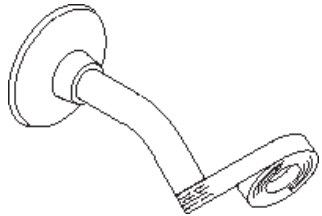

Apply sealant tape to the exposed end of the shower arm.

将垫圈(2)放入头顶花洒(3)中，并使用合适的扳手拧紧头顶花洒。

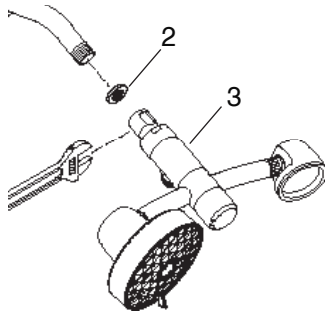

Put the washer(2) into the showerhead(3) and tighten the showerhead with a suitable wrench.

**注：**请勿在未经允许的情况下将调节器从球形接头上拆下，以免损坏产品。

**NOTE:** Please do not remove the regulator from ball joint without authorization, to avoid the damage of product.

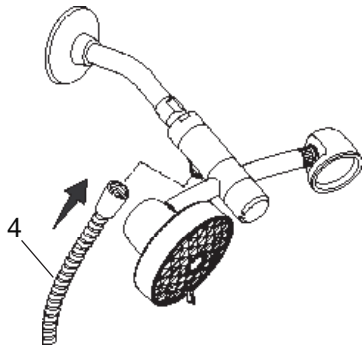

将软管(5)的一端连接到头顶花洒，另一端连接到手持花洒(6)。

Connect the one end of hose(4) to showerhead and another end to handshower(5).

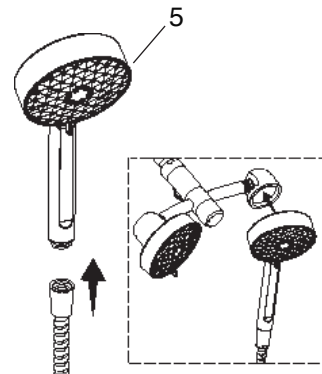

打开水源，检查是否存在任何泄漏情况。

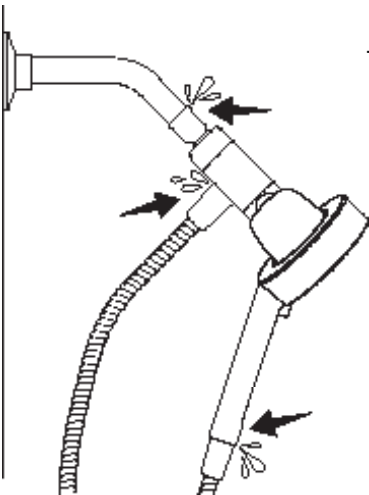

Turn on water supply and check all leakage.

操作说明

OPERATION INSTRUCTION

转动分水器旋钮，可在头顶花洒、手持花洒或组合模式之间切换。

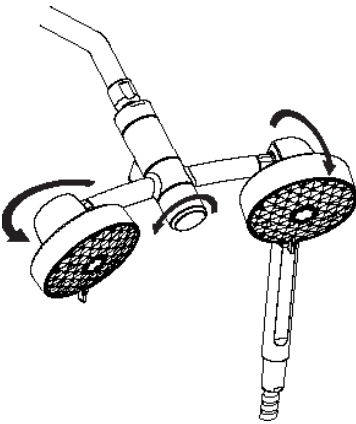

Turn the diverter knob to change between showerhead, handshower, or combination mode.

淋浴后应关闭淋浴供水阀门总开关，以免软管因长期受压而导致使用寿命缩短。

Isolate the water supplies of valve after showering to avoid long term pressure retention of the hose which may result in a shorter service life.

清洗说明

CLEANING INSTRUCTIONS

适用于所有加工处理过的表面：以中性肥皂水清洗镀层表面，再以干净的软布彻底擦干整个表面，许多清洁剂，比如氨水、去污粉及洁厕灵等，会对电镀表面造成伤害，切忌使用。

All Finishes: Clean the finish with mild soap and warm water. Wipe entire surface completely dry with clean soft cloth. Many cleaners may contain chemicals, such as ammonia, chlorine, toilet cleaner etc. which could adversely affect the finish and are not recommended for cleaning.

有磨损性的清洁用具或清洁剂也不可使用于科勒牌的水龙头及其配件上。

Do not use abrasive cleaners or solvents on Kohler faucets and fittings.

标准要求

STANDARD

淋浴器加施的水效标识表明本产品的水效等级等性能符合GB 28378-2019《淋浴器水效限定值及水效等级》的要求，是产品符合性的一种标识。

The water efficiency label applied to the shower indicates that the water efficiency grade and other performance of the product meet the requirements of GB 28378-2019 "Minimum Allowable Values of Water Efficiency and Water Efficiency Grades for Showers" which is a marking of product conformity.