

1597457-K2

Record your model number: \_\_\_\_\_

**Read all instructions before installing or using this product.**

Follow all local plumbing and building codes.

Turn OFF the water supplies.

**1A. Sealant Tape**

**2A.** Using the O-ring insert the faucet assembly into the bathroom sink faucet hole.

**3A.** From the underside of the bathroom sink, slide the washer to the faucet. Tighten the nut.

**4A.** Connect the shower hose to the faucet.

**5A.** Turn ON the water supply and check for leaks. Make the necessary adjustments if required.

## Aerator Cleaning and Maintenance

**6A.** Remove the aerator from the spout. Periodically rinse debris from the aerator.

**7A.** Open the handles to flush debris from the faucet. Turn OFF the water and reinstall the aerator.

**Need help?** Contact our Customer Care Center.

- Indonesia, Philippines, Vietnam: +(86) 21-2606-2572
- Care and cleaning: [kohlerasiapacific.com/careandclean](http://kohlerasiapacific.com/careandclean)

This product is covered under the **KOHLER® PVD Lifetime Limited Warranty for PVD Components, Three-Year Limited Warranty for Other Components**, found in the packed Compliance Certification.

1

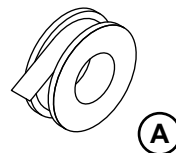

2

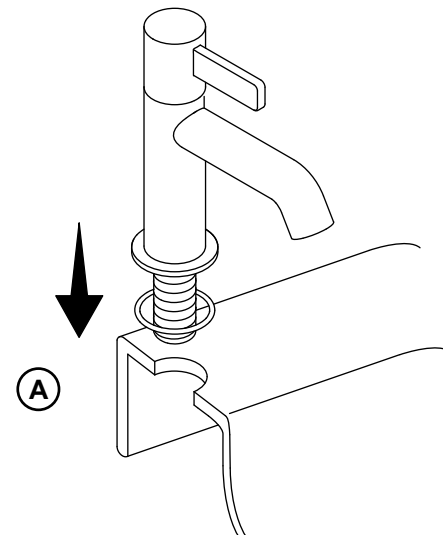

3

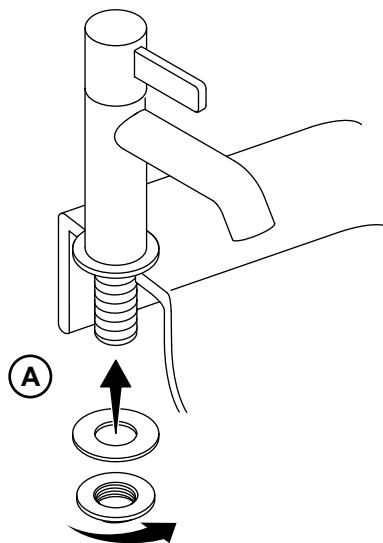

4

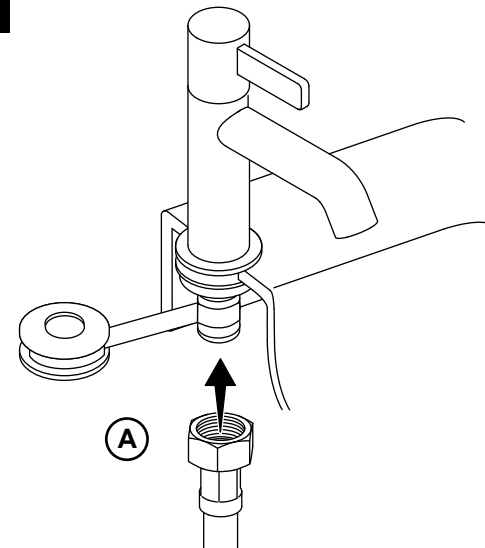

5

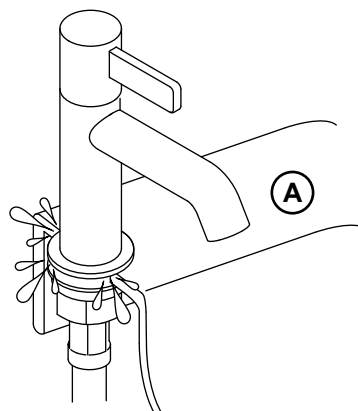

6

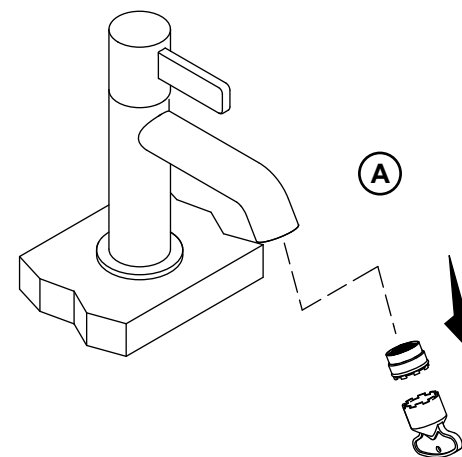

7

