

1597460-K2

Record your model number: _____

Read all instructions before installing or using this product.

Follow all local plumbing and building codes.

Turn OFF the water supplies.

1A. Sealant Tape

2A. Remove the cap from the screw hole. Using the hexagonal wrench (supplied) unthread the screw.

2B. Remove the handle and ring from the shower valve.

3A. Thread the inlet and outlet pipes to the valve. Finish the wall.

4A. Slide the escutcheon on to the sleeve of the shower valve so that the escutcheon is flush.

5A. Install the ring and handle on the shower valve.

5B. Using the hexagonal wrench (supplied) thread the screw. Insert the cap to the screw hole.

Need help? Contact our Customer Care Center.

- Indonesia, Philippines, Vietnam: +(86) 21-2606-2572
- Care and cleaning:** kohlerasiapacific.com/careandclean

This product is covered under the **KOHLER® PVD Lifetime Limited Warranty for PVD Components, Three-Year Limited Warranty for Other Components**, found in the packed Compliance Certification.

1

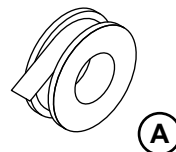

2

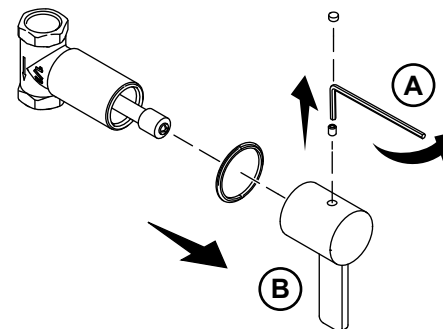

3

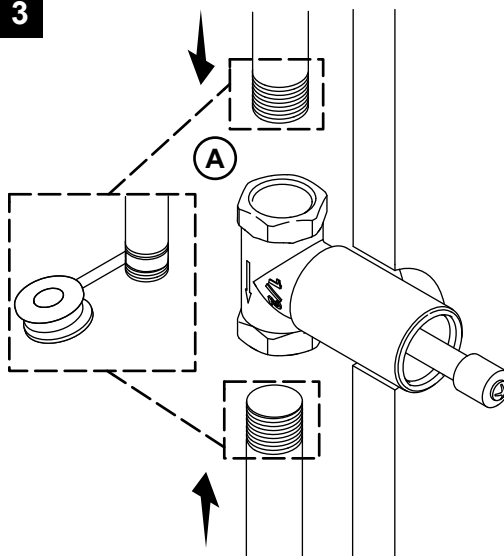

4

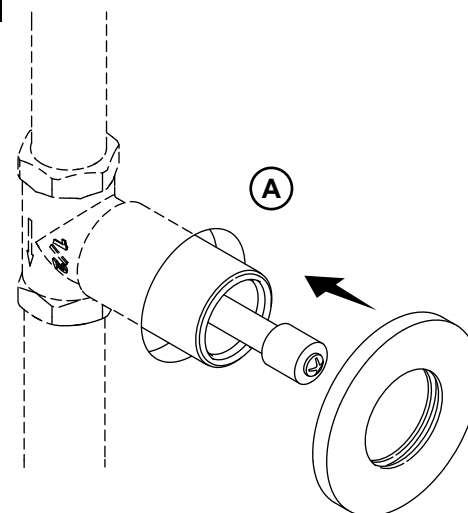

5

