

BEFORE YOU BEGIN

安装之前

- Please confirm whether your installation area and the divider you're going to install in compliance with requirement stated in related shower door installation instructions before you start.
 - The divider could be installed to finished floor or unfinished floor, but you need to ensure that the wall is finished and the floor should be level. If the floor is not level enough, use thinned slurry (with the proportion of 10:1) to fix the divider and ensure it is level and the bottom part is sufficiently supported.
 - Pre-cut the divider before it comes out of factory.
 - Make sure the floor drain is prepared around the divider installation area.
- 安装前请参照相关淋浴房说明书确认安装区域及您将安装的挡水条是否符合淋浴房安装要求。
 - 挡水条可以安装在完工地面或未完工地面上,但墙面应已完工,地面必须平整,无隆起。如果遇到不平地面,可以用较稀的水泥浆(约 10:1)将挡水条放上以确保水平且挡水条底部应得到良好支撑。
 - 挡水条出厂前底面已预先切平。
 - 挡水条包围的区域内应有地漏装置。

ROUGHING-IN

尺寸图

Reference Value
参考值

K-702096T/K-702097T

Unit: mm
单位:毫米

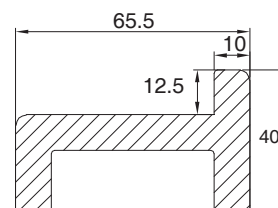
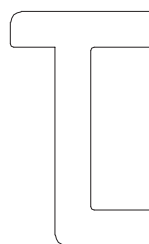
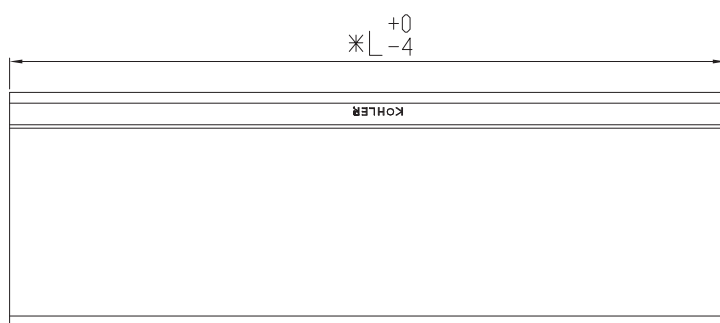

SKU	DESCRIPTION 描述	LENGTH "L" 长度	COLOR 颜色
K-702096T-*	1200x40mm	1200	0/7
K-702097T-*	1200x40mm	1600	0/7

ZHONGSHAN KOHLER SHOWER CO., LTD. NO13-1, XINGYE ROAD, ZHONGSHAN TORCH
 DEVELOPMENT ZONE, ZHONGSHAN, GUANGDONG, CHINA POST CODE: 528437
 中山科勒卫浴有限公司 广东省中山市中山火炬开发区兴业路 13-1 号 邮编:528437

K-702098T/K-702099T

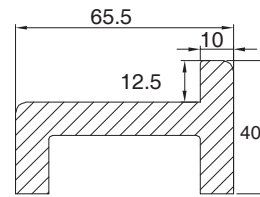
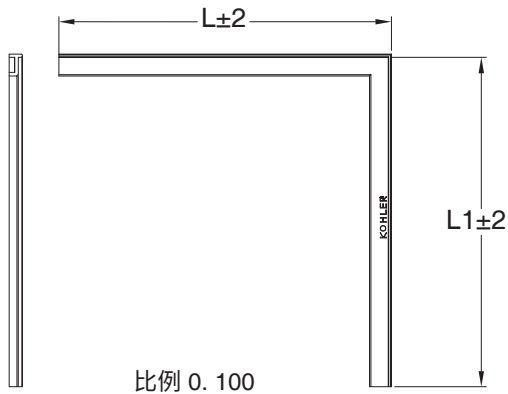

SKU	DESCRIPTION 描述	LENGTH "L" 长度	COLOR 颜色
K-702098T-*	1000×1000×40mm	1000×1000	0/7
K-702099T-*	1450×1100×40mm	1450×1100	0/7

科勒公司保留随时变更图中标示尺寸的权利，无需另行通知。
Kohler reserves the right to change marked dimensions without prior notice.

INSTALLATION

安装

1A. For finished floor (above-the-ground installation) Place the divider side end against the wall and lay it down to the floor levelly.

1A. 完工地面安装情况（地上安装）
将挡水条端面靠墙水平安放在地板上。

1B. For unfinished floor (sunk-in installation) Place the divider side end against the wall and lay it down to the floor levelly. Then lay the tills properly.

1B. 未完工地面安装（埋入安装）
将挡水条断面靠墙水平安放在地面上，然后铺地砖。

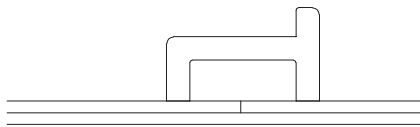

above-the-ground installation
地上安装

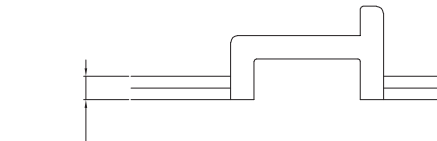

Not deeper than 7mm
埋入深度不超过 7mm

sunk-in installation
埋入安装

2. Prepare Silicone tube. Cut the top off the Silicone tube at the first notch or as shown picture.

2. 准备胶枪。在第一个刻痕处或图示之处将硅密封胶注射筒的顶端削去。

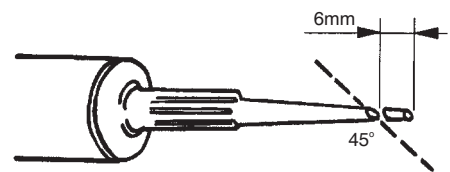

3. Apply silicone sealant evenly to the contact part between the divider and the wall, also to the contact area between the inner part of the divider and the floor for above-the-ground installation.

3. 挡水条和墙面接触处均涂上密封胶，对地上式安装还必须在挡水条内边和地面接触处均涂上密封胶密封。

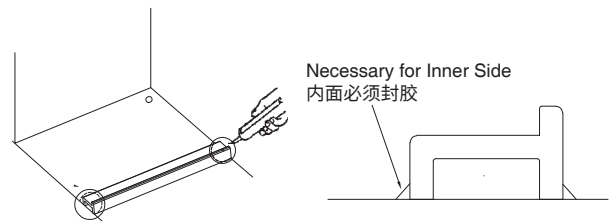

4. Install Shower Doors. Follow the instructions supplied with the Door pack.

4. 按照淋浴门的安装说明安装淋浴门。

- When cleaning-up after installation, do not use abrasive cleaners as they may scratch and dull the surface. Use warm water and liquid, non-abrasive detergent to clean the surface.
 - Stubborn stains, paint or tar can be removed with white spirit. Do not use cleaner's containing petroleum distillates, do not use solvent based cleaners.
 - Plaster can be removed by scraping with a soft wood edge. Do not use metal scrapers, wire brushes, or other metal tools.
 - Avoid harsh chemicals and disinfectants, do not use acetone or alcohol, do not use solvent based cleaners.
 - Always read the label instructions on any cleaning product before applying it to marble surface.
 - Wipe out the receptor with soft cloth after each use to prevent a build-up of soap and scum.
- 在安装后进行清洗时，请勿使用磨损性清洁剂，因为它们会产生刮痕，使表面暗淡无光。请用温水和无磨损作用的液体清洁剂清洗表面。
 - 不易去除的污渍、油漆或沥青可以用白酒 (White Spirit) 除去。不要使用含有汽油溶剂的清洁剂，不要使用以溶剂为主的清洁剂。
 - 灰泥可用软的木片薄缘刮去，不要使用金属刮刀、钢丝刷或其他金属工具。
 - 避免使用腐蚀性强的化学制剂或消毒剂，不要使用丙酮或酒精，不要使用以溶剂为主的清洁剂。
 - 在人造大理石表面使用清洁剂之前，一定要仔细阅读清洁剂使用说明。
 - 每次使用后，将本装置用软布擦干，以防止皂液和污垢沉积。