

### BEFORE YOU BEGIN

Thank you for choosing Kohler. You have just purchased the best bath drain your money can buy. Kohler drains work smoothly and reliably, and keep their gleaming finishes. For easy installation, follow these step-by-step instructions.

Carefully read these instructions before you attempt to remove your old drain or install your new one. Make sure you have the proper tools and materials listed on the following page to complete the job. This will help you avoid unnecessary expense resulting from improper installation.

Your new Kohler drain has been designed for easy installation using common household tools.

### 安装之前

感谢您购买品质卓越的浴缸排水。科勒排水工作通畅、可靠，光洁持久。请遵循以下安装步骤，完成便捷安装。

在拆除旧排水准备安装新排水时请仔细阅读以下说明。请使用以下列出的工具和材料完成安装，以免安装失误造成不必要的损失。

只要使用普通家用工具即可安装科勒浴缸排水。

### INSTALLATION

### 安装

- |                         |                           |
|-------------------------|---------------------------|
| 1....Plug Assy.**       | 9....Drain Body Assy.     |
| 2....Strainer           | 10..Overflow Gasket Thick |
| 3....Drain Gasket Thin  | 11..Overflow Gasket Thin  |
| 4....Drain Gasket Thick | 12..Overflow Cover        |
| 5....Drain Pipe         | 13..Joint Nut             |
| 6....Drain Pipe Gasket  | 14..Control Assy.**       |
| 7....Drain Pipe Nut     |                           |
| 8....Protective Cover   |                           |

- |             |             |
|-------------|-------------|
| 1....塞子组件** | 9....排水本体组件 |
| 2....水漏     | 10..溢水口密封圈  |
| 3....硅胶密封圈  | 11..橡胶平垫圈   |
| 4....橡胶密封圈  | 12..溢水盖板    |
| 5....排水管    | 13..压紧螺母    |
| 6....排水管密封圈 | 14..控制钮组件** |
| 7....排水管螺母  |             |
| 8....护罩     |             |

\*\*注：以标注\*\*组件为该产品的维修零配件。  
\*\*Note: Components marked with \*\* are defined as service parts.

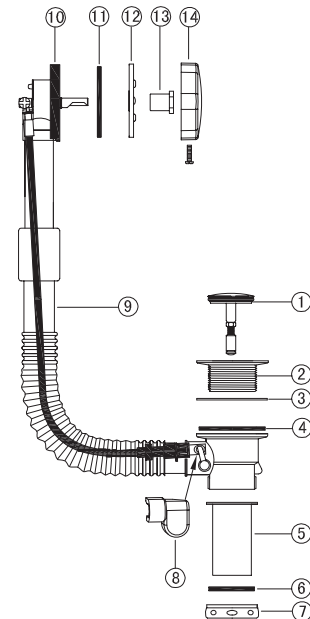

零件号 Part No.	零件描述 Description
1100460	塞子组件 Plug Assy.
1100473	控制钮组件 Control Assy.

-* include: -*包括:		
-CP-Polished Chrome -抛光镀铬	-AF-French Gold -法金表面	-BN-Brushed Nickel -拉丝镍
-BV-Brushed Bronze -拉丝镀铜	-SN-Polished Nickel -抛光镀镍	

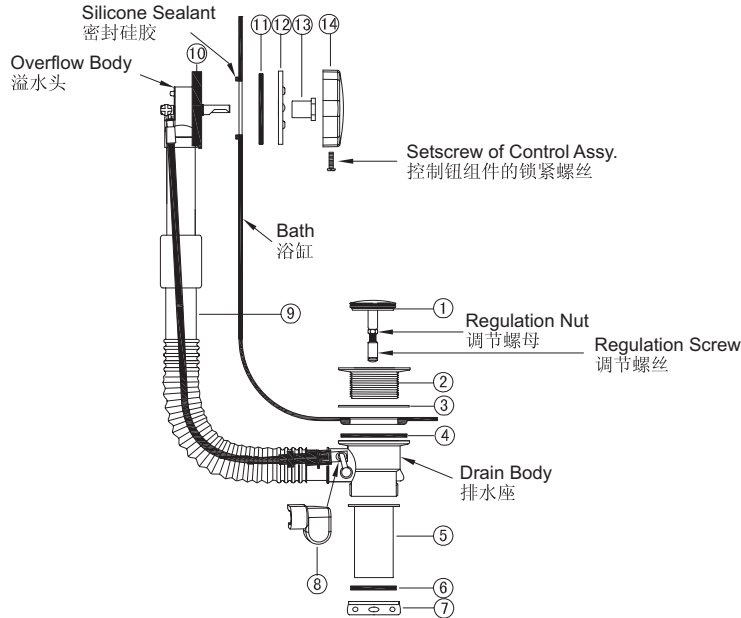

Unpack drain and ensure that the Control Cable is not twisted or tangled.  
Please place the bath on wooden brackets or bricks to ensure the drain assy. located under the bath.

#### Installation steps:

- 1) Fit Drain Gasket Thin ③ to Strainer ②.
- 2) Insert Strainer ② into bath drain hole from inside.
- 3) Fit Drain Gasket Thick ④ to Drain Body Assy. ⑨ and make sure Drain Body Assy. ⑨ is located under the bath drain hole.
- 4) Thread Strainer ② into drain body of Drain Body Assy. ⑨. **Do not overtighten.**
- 5) Apply silicone sealant to the outside wall of overflow hole. (As shown tight above.)
- 6) Slide Overflow Gasket Thick ⑩ onto the overflow body of Drain Body Assy. ⑨. Place the assembly to the back of bath overflow and make proper adjustment to align two positions( to insert overflow body into the pipe will leave 100 mm for adjustment). Ensure the assembly is placed center.  
Put another piece of Overflow Gasket Thin ⑪ onto Overflow Cover ⑫ and spin Joint Nut ⑬ onto Overflow Body. Ensure Control Cable is not twisted or tangled before proceeding with spinning as it will lead to improper operation of the pop-up mechanism.
- 7) Place Strainer ② and drain body of Drain Body Assy. ⑨ to center and tighten Strainer ② with pliers. **Do not overtighten.**
- 8) Adjust Plug Assy. ① by turning Control Assy. ⑭ to the 'Up' position and then set Plug Assy. ① height with use of regulation screws and then make it locked.
- 9) Fix Drain Pipe ⑤, slide in Drain Pipe Gasket ⑥ and tighten with Drain Pipe Nut ⑦.
- 10) Check connections for leakage. Only proceed bath installation after the bath drain functions properly.

If Plug cannot be lifted to the working height, please try to adjust the control cable to see if it is twisted or tangled or make adjustment with the regulation screws of Plug Assy. ①.

打开排水包装，确保控制线没有扭曲打结。  
请将浴缸放置在木架或砖墙上保障排水配件在浴缸底下。

#### 安装步骤:

- 1) 将硅胶密封圈③垫于水漏②处。
- 2) 从浴缸的内侧将水漏②插入浴缸排水口。
- 3) 将橡胶密封圈④垫于排水本体组件⑨的排水座上并置于浴缸排水口下部。
- 4) 把水漏②旋入排水本体组件⑨的排水座中，注意在此时不要将螺纹旋得太紧。
- 5) 从浴缸的外面朝溢水口处涂一圈密封硅胶。(如图)
- 6) 将溢水口密封圈⑩套在排水本体组件⑨的溢水头上，然后放在浴缸溢水口的背面，上下调节排水本体组件⑨的溢水头与浴缸溢水口的位置(溢水头铜管插入波纹管可调距离100mm)，并确保它与浴缸溢水口位置中放置。  
再将另一块橡胶平垫圈⑪垫于溢水盖板⑫里，把压紧螺母⑬旋入溢水头，在拧紧压紧螺母⑬前请确保控制线没有扭曲打结。  
控制线打结或扭曲会造成提拉式排水工作失灵。
- 7) 将水漏②和排水本体组件⑨的排水座置中放置，用钳子来旋转水漏②。不要过分拧紧——用钳子紧至适合松紧。
- 8) 旋转控制按钮组件⑭来提升塞子组件①到放水的位置，然后使用塞子组件①的调节螺丝调节塞子高度，且用塞子组件①的调节螺母固定。
- 9) 安装排水管⑤，垫上密封圈⑥后套上排水管螺母⑦旋紧。
- 10) 确保各连接处无渗漏，在检查并确认浴缸排水工作正常后才可进行浴缸的下步安装。

如果塞子不能够提升到工作高度的话，需要调节控制线看它是否扭曲打结或用塞子组件①的调节螺丝调节。