

## BEFORE YOU BEGIN

## 开始之前

- Congratulation on your purchase of this high quality Bathroom Accessory. Before proceeding with the installation, please carefully read this installation instruction in order to ensure proper care and assembly of this accessory.
- Please keep this installation instruction for future reference.

- 首先恭喜您购买到了高档的卫浴产品，为了使您正确保护和组装产品，在您安装之前请仔细阅读此说明书。
- 请保留此说明书以备参考。



Prior to drilling into walls, check there are no hidden electrical wires, cables or water supply pipes with the aid of an electronic detector. If you use power tools do not forget:

1. Wear eye protection.
2. Unplug equipment after use.



警告：在钻孔之前，请借助电子探测仪确认墙内是否有电源线，通讯光缆或者水管之类的东西。如果使用电钻的话请勿忘记以下两点：

1. 请戴上防护镜。
2. 用完设备后关掉电源。

## INSTALLATION

## 安装说明

**NOTE:** There is no provision for later adjustment if the resulting pilot holes are not Level.

- Level the shower basket or template in desired position.

注意：如果试装孔不水平，则本说明书中不提供后期调整的说明。

- 在需要的位置水平调整角篮或钻孔模板。

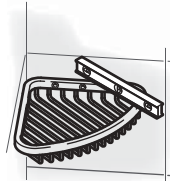

- Mark the 4 screw locations.

- 标记四个螺丝的钻孔位置。

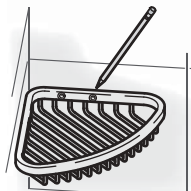

上海科勒国际贸易有限公司  
上海市外高桥保税区新灵路106号2号楼324室 邮编：200131

- Using a 5/16" drill bit, drill pilot holes at the marked screw locations.

- 使用8mm钻头在标记的位置上钻安装孔。

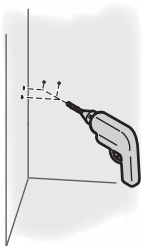

- Insert an anchor (provided) into each drilled hole.

- 在每一个安装孔中插入安装螺丝（附带）。

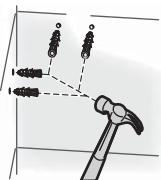

- Apply silicone sealant in the 4 drilled holes.

- 使用硅胶密封四个安装孔。

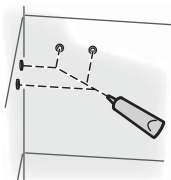

- Secure the shower basket with the 4 screws (provided).

- 使用四个螺丝（附带）固定角篮。

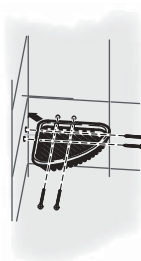

## CARING FOR YOUR PRODUCTS

## 保养须知

The accessories should be washed with warm water and a soft cloth or sponge. Do not use abrasive cleaners or cleaners containing bleach.

为了更好地保养本品，请您用温水和软毛巾(或海绵)擦拭，含有腐蚀性或漂白剂的洗洁剂对本品有害。