

Installation Instructions

Wall-Mount Lavatory

K-35309K

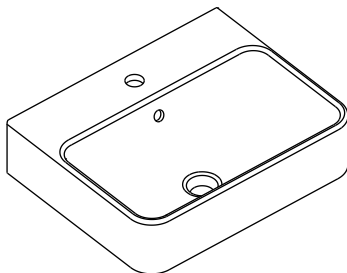

K-35313K

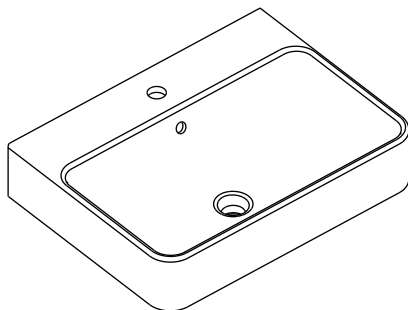

KOHLER®

Thank You for Choosing Kohler Company

Thank you for choosing Kohler. Kohler craftsmanship offers you a rare combination of proven performance and graceful sophistication that will satisfy you for years to come. The dependability and beauty of your Kohler product will surpass your highest expectations. We're very proud of our products here at Kohler and we know you will be too.

Please take a few minutes to review this manual before you start installation. If you encounter any installation or performance problems, please don't hesitate to contact us. Our phone numbers and website are listed on back cover.

All information in this manual is based upon the latest product information available at the time of publication. At Kohler, we constantly strive to improve the quality of our products. We reserve the right to make changes in product characteristics, packaging or availability at any time without notice.

Thank you for choosing Kohler Company.

Important Information

IMPORTANT NOTICE TO INSTALLERS!: Please leave these instructions for the consumer. They contain important information.

In addition to installation procedures, this manual contains important care and cleaning. Please retain for future reference.

NOTE: Some installation parts might not be provided.

NOTE: The product pictured in the installation steps may differ from the model being installed.

Before You Begin



CAUTION: Risk of personal injury or product damage. Handle with care. Product can break, chip, or cause injury if handled carelessly. Get help lifting the lavatory.



CAUTION: Risk of personal injury. This wall mount lavatory is heavy. Do not attempt to lift or install the wall mount lavatory without assistance.

- ☐ Observe all local plumbing and building codes.
- ☐ Prior to installation, unpack the new lavatory and inspect it for damage. Return the lavatory to its protective carton until you are ready to install it.
- ☐ The walls and the floor must be square, plumb, and level.
- ☐ Fixture dimensions are nominal and conform to tolerances established by Standards TIS.

Tools

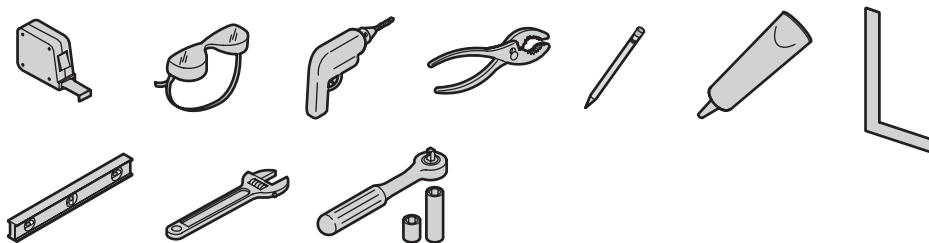

Roughing-In For Wall-Mount Lavatory

Dimensions are approximate.

Unit : mm

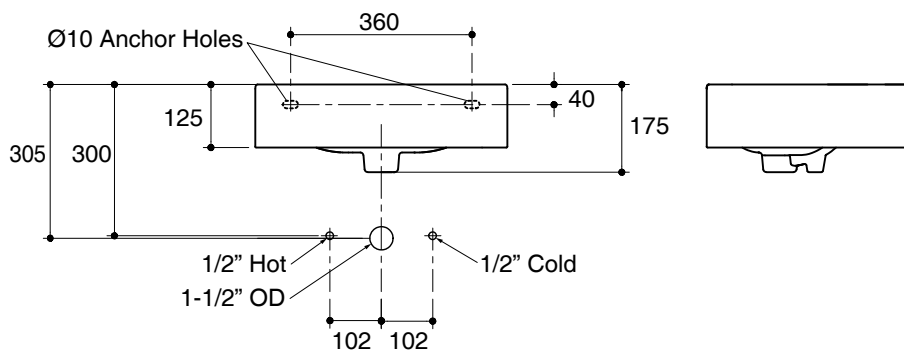
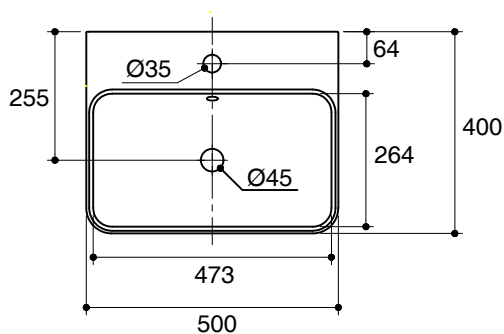

K-35309K

Roughing-In For Wall-Mount Lavatory

Dimensions are approximate.
Unit : mm

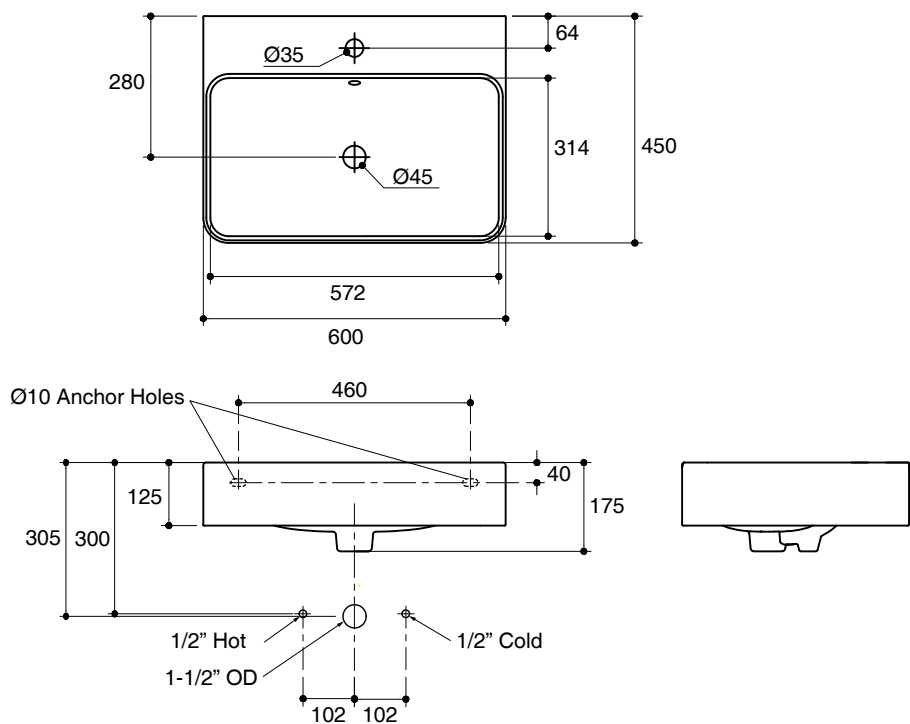

K-35313K

Prepare The Site

NOTE: Install the 1/2" water supply lines and 1-1/2" drain piping according to the roughing-in information.

IMPORTANT: Roughing-in may vary by product type. To avoid potential issue, verify all related product roughing-in information prior to install.

Install Wall-Mount Lavatory

- 1** Mark the centerline on the floor.

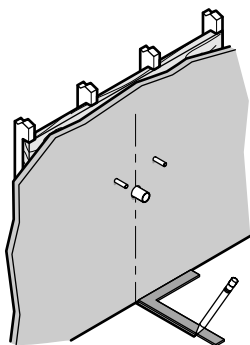

- 2** Drill 10 mm anchor holes as marked position, then insert anchors.

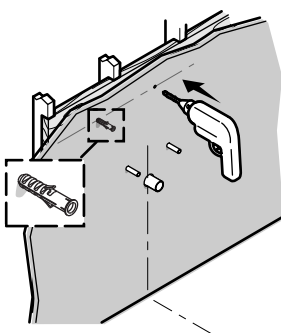

- 3** Install the faucet and drain to the lavatory.

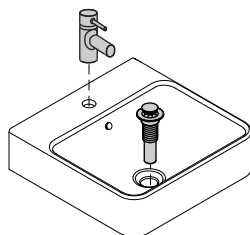

- 4** Install the lavatory to the wall with studs, then tighten the nuts to secure the lavatory.

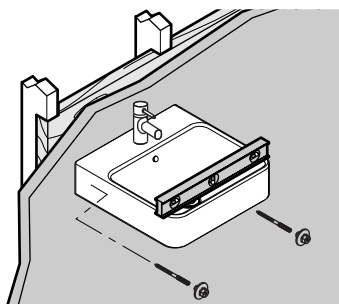

- 5** Apply silicone between the lavatory edges and finished wall immediately wipe away any excess silicone.

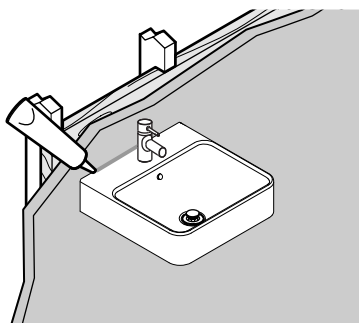

Care and Cleaning

For best results, keep the following in mind when caring for your product :

- Carefully read the cleaner product label to ensure the cleaner is safe for use on the material.
- Always test your cleaning solution on an inconspicuous area before applying to the entire surface.
- Wipe surfaces clean and rinse completely with water immediately after cleaner application. Rinse and dry any overspray that lands on nearby surfaces.
- Do not allow cleaners to sit or soak on the surface.
- Use a soft, dampened sponge or cloth. Never use an abrasive material such as a brush or scouring pad to clean surfaces.
- Be careful not to leave staining materials in contact with the surface for extended periods of time.
- The ideal cleaning technique is to rinse thoroughly and blot dry any water from the surface after each use.



ASIAN EMERGING MARKETS

Asia Customer Service Centre, Kohler Asia Pacific Limited

No.158, Jiang Chang San Road, Zhabei District, Shanghai, PRC. 200436.

Tel: +(86) 21 2606 2572 Fax: +(86) 21 6107 8900

1601970-K2-A