

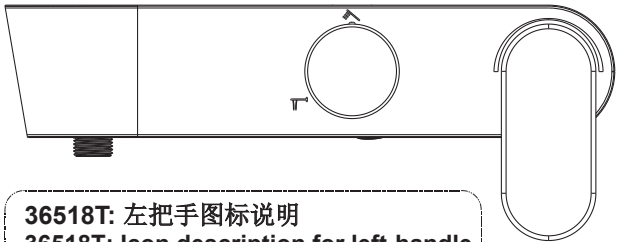

	<div> <div>36517T-4</div> <div>挂墙式花洒龙头</div> </div> <div> <div>36518T-4</div> <div>挂墙式浴缸花洒龙头</div> </div>
<div> <div>安装之前</div> <div> <p>所有的资料是按最新出版的产品资料编写而成。科勒公司保留任何时候不经通知即可改变产品特性、包装或产品可供类型的权利。</p> <p>说明书包括重要的安装、保养及清洁方面的内容，请把这些资料交给用户阅读。</p> <p>注意事项：</p> <ol style="list-style-type: none"> 1.切断供水管路。 2.检查供水管路有无损坏。如需要，进行替换。 3.彻底冲洗供水管，以清除管路中的杂质。 4.花洒最高工作压力：0.5MPa(5bar)。水压超过0.5MPa(5bar)时必须安装减压阀。花洒最高工作温度及环境温度：60℃。请特别注意花洒同花洒连接的臂管须远离浴霸，否则可能损坏花洒及其密封件，甚至对使用者造成伤害。 5.淋浴器加施的水效标识表明本产品的水效等级等性能符合GB 28378-2019《淋浴器水效限定值及水效等级》的要求，是产品符合性的一种标识。 </div> </div>	<div> <div>BEFORE YOU BEGIN</div> <div> <p>All information is based on the latest product information available at the time of publication. Kohler Co. reserves the right to make changes in product characteristics, packaging, or availability at any time without notice.</p> <p>Please leave these instructions for the consumer. They contain important information.</p> <p>NOTES:</p> <ol style="list-style-type: none"> 1. Shut off the water supplies to the fitting. 2. Inspect the supply tubing for damage. Replace as needed. 3. Flush the water supply pipes thoroughly to remove debris. 4. The highest working pressure for handshower & showerhead is 0.5MPa(5bar). If it exceeds 0.5MPa(5bar), a pressure reducer is needed. The highest water and environment temperature is 60°C. Please keep handshower, showerhead and shower arm away from heater, or it may become damaged and cause injury to the user. 5. The water efficiency label applied to the shower indicates that the water efficiency grade and other performance of the product meet the requirements of GB 28378-2019 "Minimum Allowable Values of Water Efficiency and Water Efficiency Grades for Showers" which is a marking of product conformity. </div> </div>
<div> <div>使用说明</div> <div>  <div>36517T</div> </div> </div> <div> <p>轻轻打开右把手，顺时针旋转把手为热水，逆时针旋转把手为冷水。</p> <p>只对于36518T: 左把手即切换把手，旋转切换把手至手持花洒标志，手持花洒出水；旋转至浴缸标志，出水口出水。</p> </div>	<div> <div>OPERATION INSTRUCTIONS</div> <div>  <div> <div>36518T: 左把手图标说明</div> <div>36518T: Icon description for left-handle</div> <div>  <div>手持花洒 Handshower</div> </div> <div>  <div>浴缸出水口 Bath spout</div> </div> </div> </div> </div> <div> <p>Lift the right handle gently. Turn clockwise for hot water; turn counter-clockwise for cold water.</p> <p>Only for 36518T: Turn the diverter handle(left-handle) to the handshower logo, handshower will work; turn it to the bath logo, spout will work.</p> </div>



**订购时请说明颜色编号

**Color code must be specified when ordering

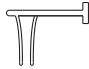
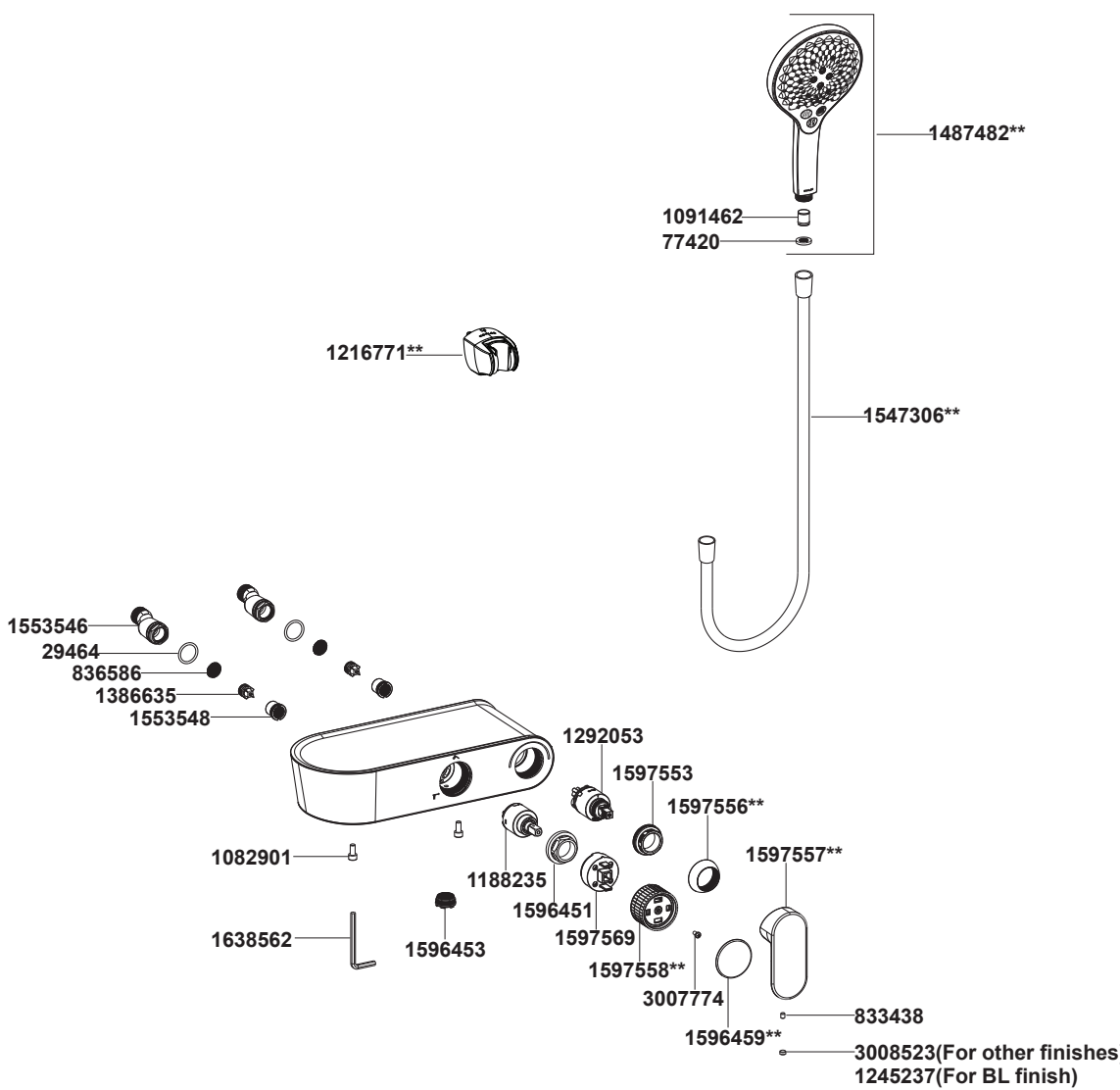
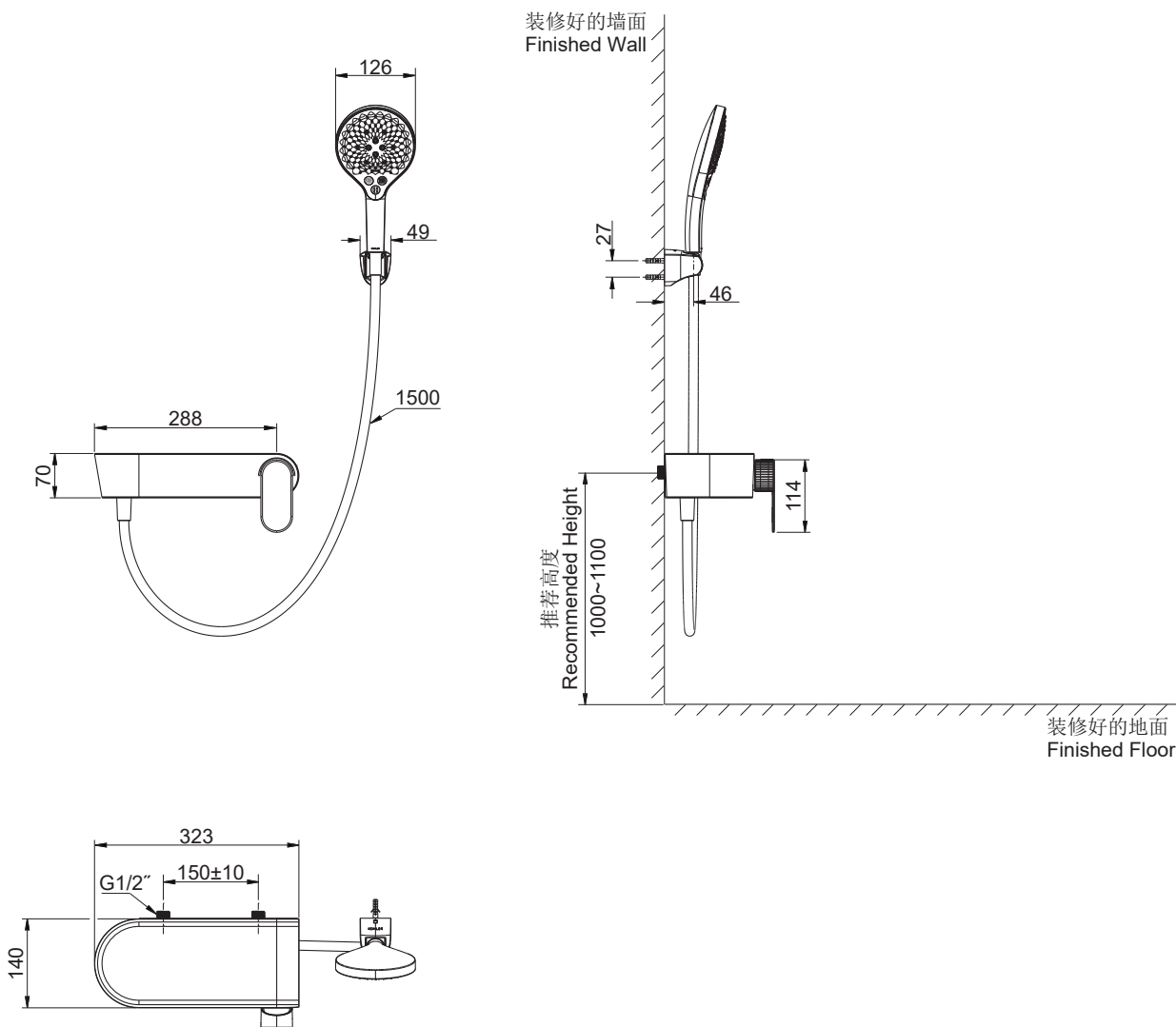
36517T-4 挂墙式花洒龙头

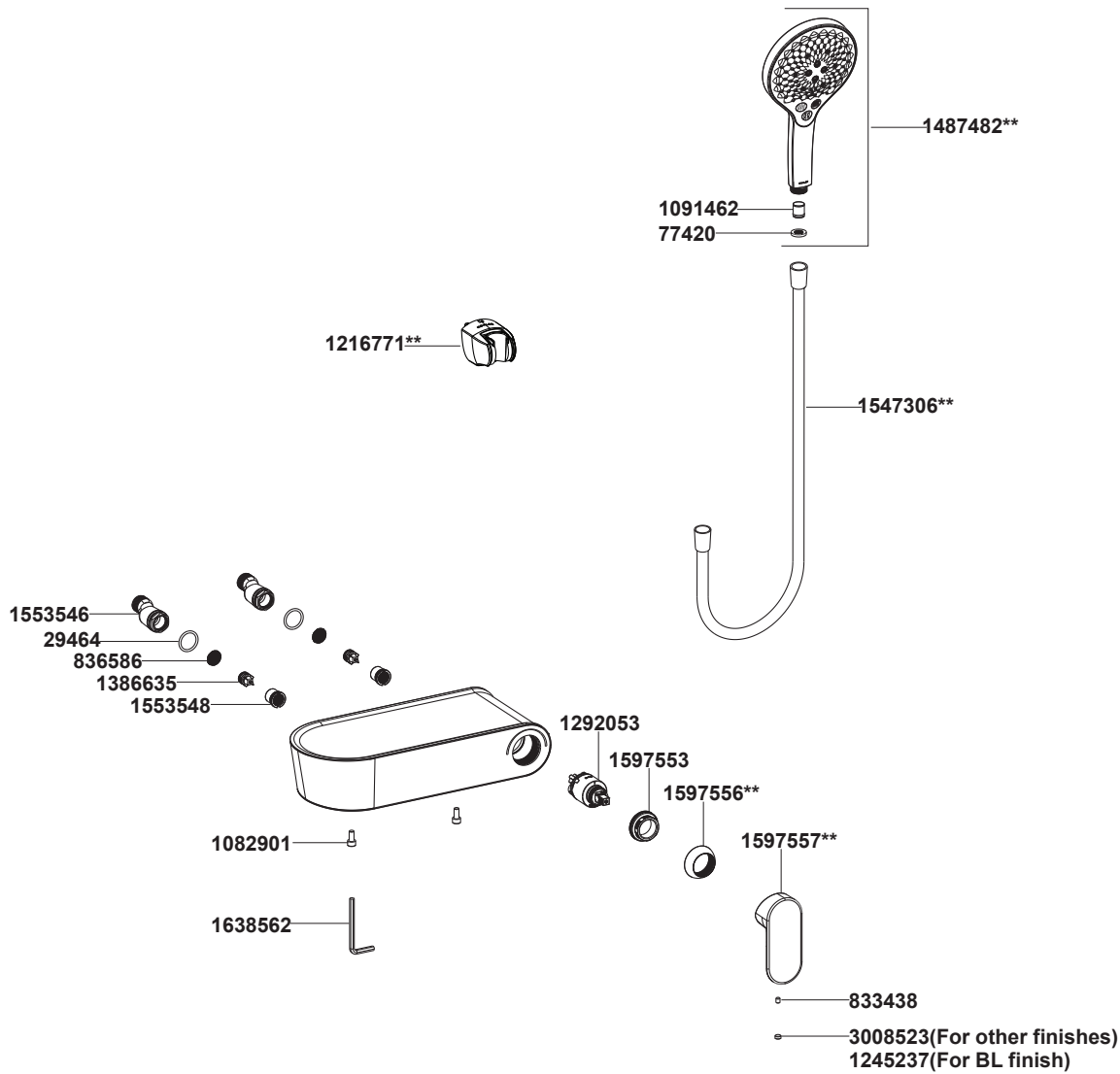

**订购时请说明颜色编号
**Color code must be specified when ordering

安装尺寸 (36518T)

ROUGH-IN DIMENSIONS (36518T)

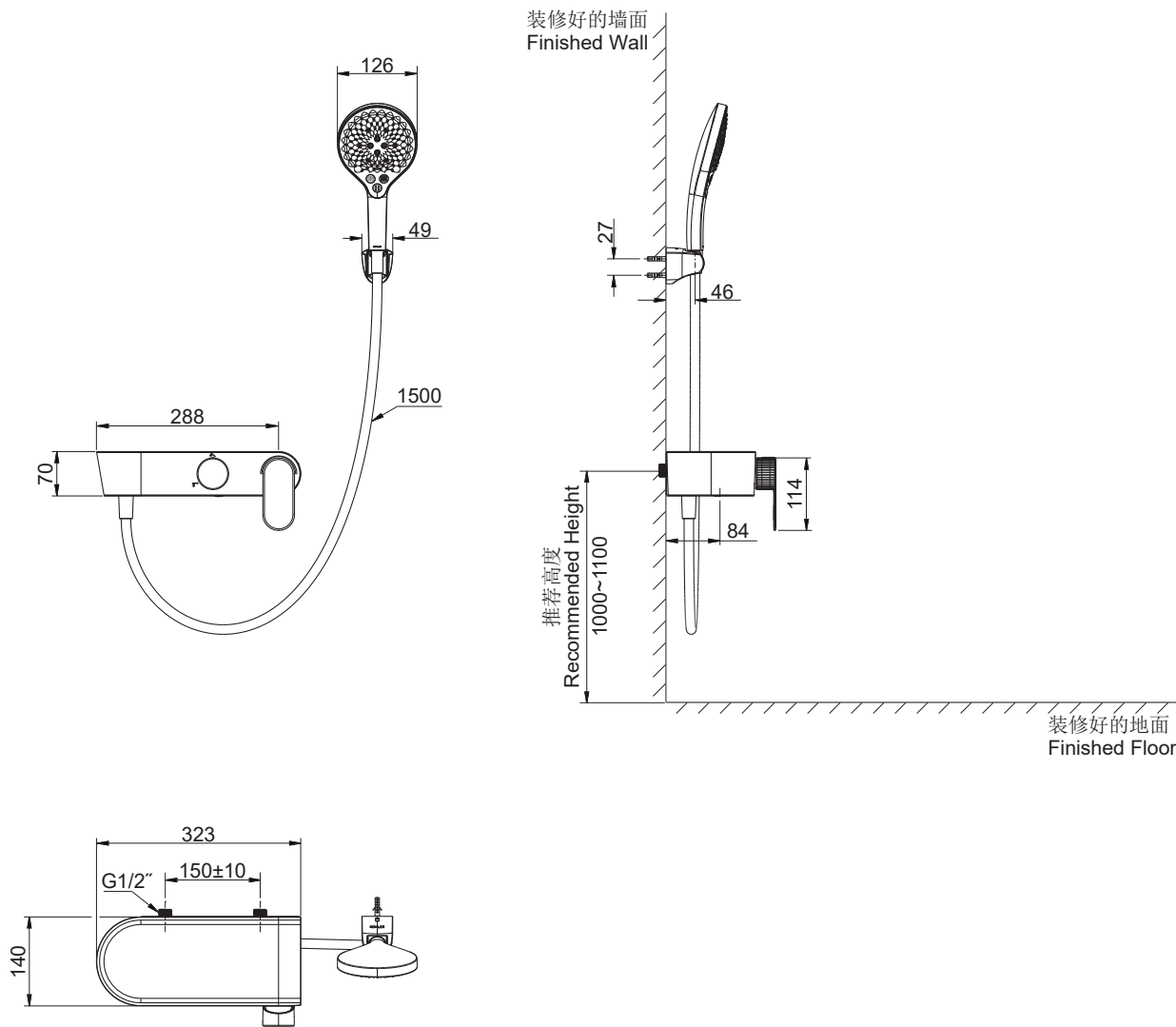

安装步骤

如何安装水龙头

为使安装顺利，G1/2"内螺纹管道配件(1)应已安装好，预留150mm间距，保持水平。管道配件要垂直并不能凸出装修好的墙面。热供水管装在左边。彻底冲洗供水管，以清除管路中的杂质。

在两个接头(2)涂上密封胶或缠绕足以密封的密封胶带，旋入冷热水管中。调节两个接头，使其中心距离为150mm，并保持同一水平。它们凸出墙面的尺寸应该在34到44mm之间。

用5mm六角扳手(3)调整两个紧固螺钉(4)，将龙头本体插入两个进水接头，使本体贴紧墙面。

用5mm六角扳手锁紧两个紧固螺钉。

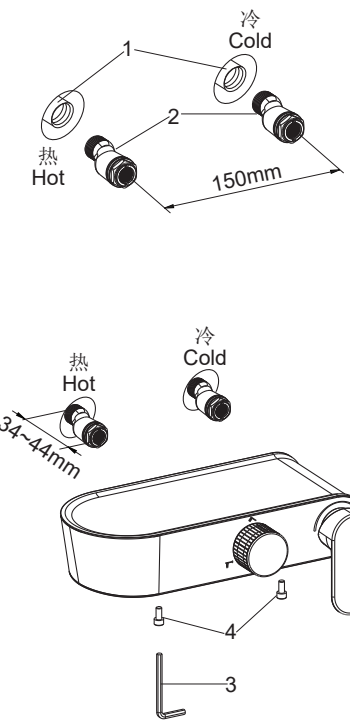

INSTALLATION

How to Install the Faucet

To perform installation, installer must provide G1/2" female supply fittings(1), spaced 150mm apart and horizontally. The supply fittings should be vertical and not beyond the finished wall. Hot supply pipe must be located on the left. Flush the water supply pipes thoroughly to remove debris.

Use appropriate thread sealants or thread tape on the threads of offset connectors(1). Install two offset connectors into the hot and cold supply pipes. Adjust the center-to-center distance between the connectors to 150mm horizontally. They should extend 34 to 44mm beyond the finished wall.

Adjust two screws(4) with 5mm hex wrench (3). Install the faucet body to the connectors until it is against the finished wall.

Tighten two screws with 5mm hex wrench.

如何安装手持花洒

安装手持花洒(5)前，旋转左把手至手持花洒出水状态，打开冷热水源冲掉管路中的杂质。

根据需要将单向阀(6)塞入手持花洒进水口，将滤网垫片(7)放入软管(8)接头内，用软管连接接头(9)和手持花洒。锁紧所有衔接螺母。

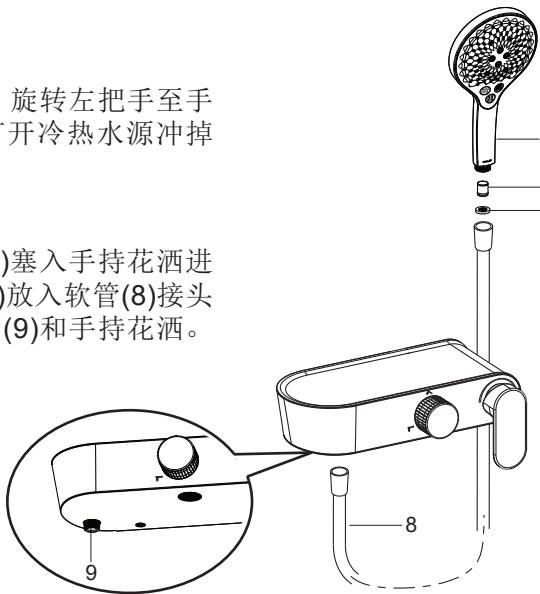

How to Install the Handshower

Ensure it is in the position for handshower (5). Flush hot and cold water supplies to remove any debris before the handshower is installed.

Put the check valve(6) into the handshower if needed. Put the screen washer(7) into the hose(8). Connect the connector(9) and handshower with hose. Tighten all the connectors.

如何安装托架

在墙面选一合适的位置来安装托架。根据孔距在墙面标记钻孔的位置，依据胀塞(10)直径打孔，安装胀塞。

旋紧螺钉(11)，使底座(12，平面朝上)固定紧贴墙壁。将托架(13)扣在底座上，使凸台嵌入豁口。

把手持花洒挂在托架上。

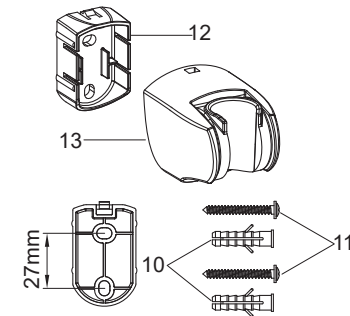

How to Install the Bracket

Determine a suitable location on the finished wall to install the bracket. Mark the mounting hole locations of the bracket base on the wall according to the dimension. Drill two holes on the finished wall, the holes should match the anchors(10). Install the anchors.

Tighten the screws(11) to secure the bracket base(12, flat side upward). Put the bracket(13) onto the bracket base and locked by stopper.

Hang the handshower on the bracket.

安装结果检查

检查并确保所有衔接处都已拧紧，确保把手在关闭位置。

打开水源，使其流入阀芯。检查所有连接处是否漏水，根据需要修理之。

如何清洗滤网

滤网可起到保护龙头的作用，但长时间使用后，水垢或杂质可能会堵塞滤网，降低水流量。如果有类似情况发生，关闭水源，卸下花洒软管。

用5mm六角扳手(3)旋出两个紧固螺钉(4)，卸下龙头。将滤网垫片(14)、单向阀(15)和滤芯(16)从进水接头(2)上旋出。用热醋清洗滤网。然后依次装回。

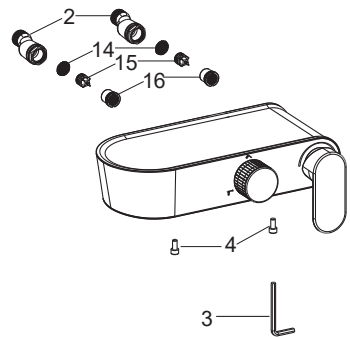

如何更换切换阀芯

如需更新切换阀芯，拆卸后按如下步骤装回。

将切换阀芯(17)装回龙头本体，保持阀芯初始位置，即阀芯杆凹点和三角对齐，如图所示。**注意：**装入阀芯时确保阀芯杆凹点和出水口标识对齐。接着安装阀螺母(18)，建议拧紧扭矩1.5-2.0NM。

依次将适配衬套(19)、左把手(20)装入龙头本体。**注意：**适配衬套和左把手的凸起均朝上，适配衬套背面有HB(对于36518T)。

锁紧螺钉(21)，安装把手上盖(22)。

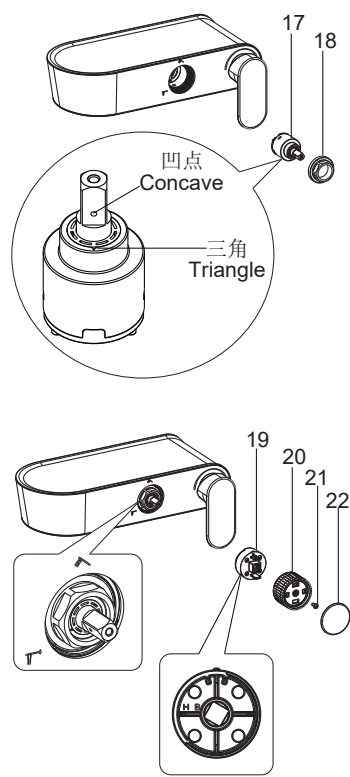

INSTALLATION CHECKOUT

Make sure that all connections are tight, the handles are in closed position.

Turn on the water supply. Run water through the valve. Check for leakage. Repair as needed.

How to Clear the Filter

The filters can protect the faucet, but it may get obstructed and reduce water flow after a long time of use. If this happens, turn off the water supply, uninstall the shower hose.

Unscrew two screws(4) with 5mm hex wrench(3) to uninstall the faucet. Unscrew the washer(14), check valve(15) and filters (16) from the connectors(2). Clean the filters by soaking them in warm vinegar. Reinstall them in turn.

How to Replace the Diverter Valve

If you need to update the diverter valve, reinstall it according to the following steps.

Install the diverter valve(17) into the faucet body, keep the initial position of the valve (Align the concave point and triangle of the valve rod as shown in the figure). **NOTE:** When installing the valve, ensure that the concave point of the valve rod is aligned with the bath spout icon. Install the valve nut(18). The recommended locking torque for the screw is 1.5~2.0NM.

Install the adapter(19) and left handle(20) into the faucet body in sequence. **NOTE:** The bulge of the adapter and left handle are facing upwards, and there is HB(for 36518T) on the back of the adapter.

Tighten the screw(21) and install the handle cover(22).

清洗说明

适用于所有加工处理过的表面：以中性肥皂水清洗镀层表面，再以干净的软布彻底擦干整个表面，许多清洁剂，比如氨水、去污粉及洁厕灵等，会对电镀表面造成伤害，切忌使用。

有磨损性的清洁用具或清洁剂也不可使用于科勒牌的水龙头及其配件上。

CLEANING INSTRUCTIONS

All Finishes: Clean the finish with mild soap and warm water. Wipe entire surface completely dry with clean soft cloth. Many cleaners may contain chemicals, such as ammonia, chlorine, toilet cleaner etc. which could adversely affect the finish and are not recommended for cleaning.

Do not use abrasive cleaners or solvents on Kohler faucets and fittings.