

Wall-Mount Bath Shower Faucet

8612T-1 72727T-9 挂墙式浴缸花洒龙头
8614T-1 72728T-9 挂墙式花洒龙头

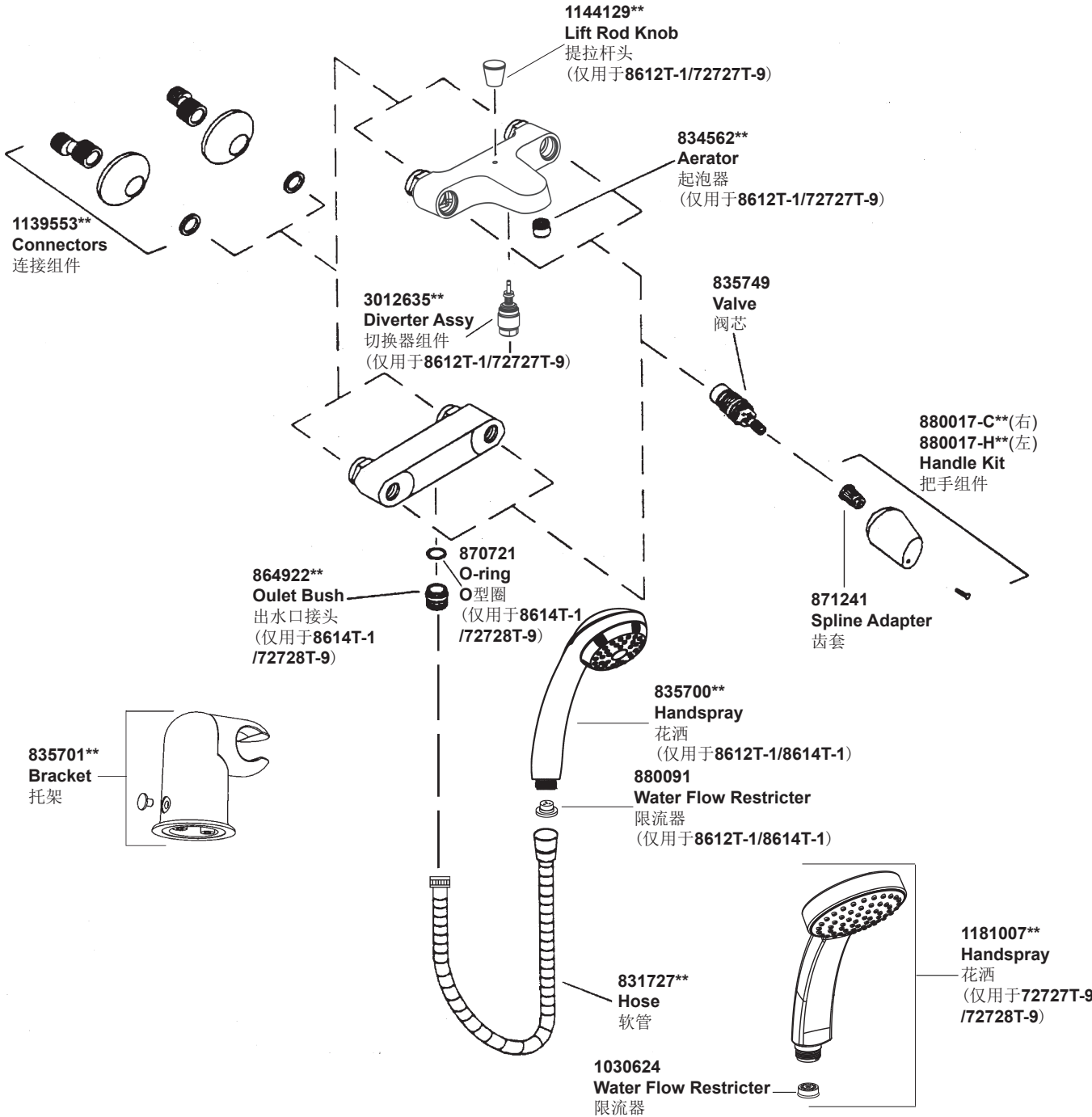

**订购时请说明颜色编号
**Color code must be specified when ordering

Wall-Mount Bath Shower Faucet

8612T-1 72727T-9 挂墙式浴缸花洒龙头
8614T-1 72728T-9 挂墙式花洒龙头

安装之前

所有的资料是按最新出版的产品资料编写而成。科勒公司保留任何时候不经通知即可改变产品特性、包装或产品可供类型的权利。

说明书包括重要的安装、保养及清洁方面的内容，请把这些资料交给用户阅读。

注意事项：

- 一定要先彻底冲洗供水管以清除管道中的杂质。
- 切换器正常工作的最小压力为0.05MPa(0.5bar)。
- 花洒最高工作压力：0.5MPa(5bar)。水压超过0.5MPa(5bar)须安装减压阀。花洒最高工作温度及环境温度：60℃。请特别注意花洒同花洒连接的臂管须远离浴霸，否则可能损坏花洒及其密封件，甚至对使用者造成伤害。

使用说明

逆时针旋转两个把手为开，顺时针旋转为关。

安装尺寸

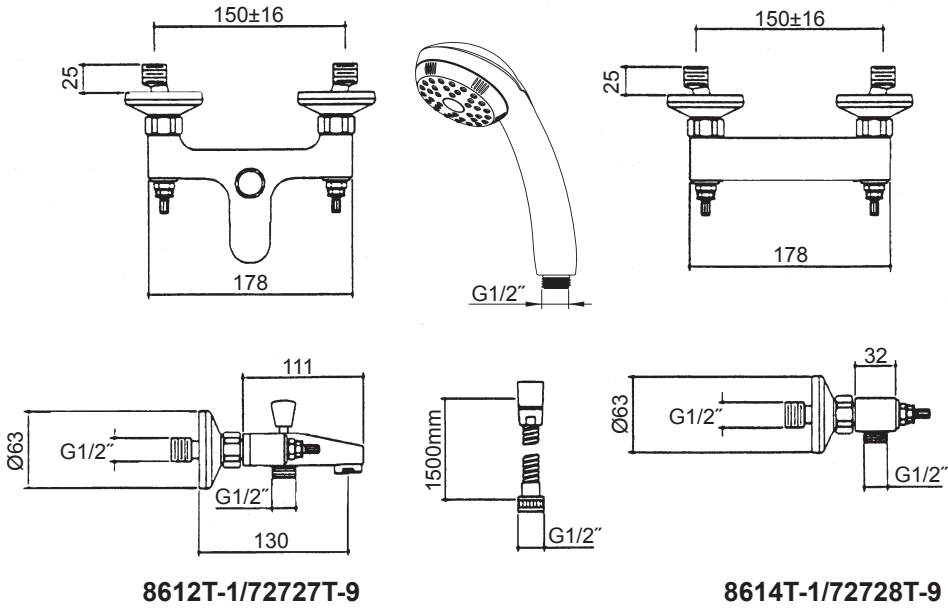

BEFORE YOU BEGIN

All information is based on the latest product information available at the time of publication. Kohler Co. reserves the right to make changes in product characteristics, packaging, or availability at any time without notice. Please leave these instructions for the consumer. They contain important information.

NOTES:

- Flush the water supply pipes thoroughly to remove debris.
- The minimum inlet water pressure for the diverter is 0.05MPa(0.5bar).
- The highest working pressure for handspray is 0.5MPa(5bar). If it exceeds 0.5MPa(5bar), a pressure reducer is needed. The highest water and environment temperature is 60℃. Please keep handspray, showerhead and the shower arm away from heater, or it may become damaged and cause injury to the user.

HANDLE OPERATION

Both handles open with one-quarter turn counter-clockwise.

ROUGH-IN DIMENSIONS

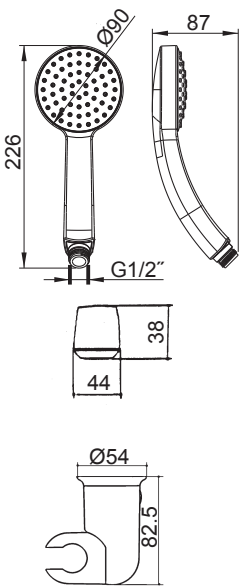

安装步骤

如何安装水龙头

在两个接头(1)缠上螺纹密封胶带，然后旋进冷热供水管中。

调节两个接头使其中心距离为150mm并保持同一水平。

将装饰罩(2)旋入接头紧贴装修后的墙壁。

把密封垫片(4)装进螺母(5)后，旋接螺母到接头，并拧紧。

将垫圈(9)装入浴缸软管(6)两端。然后把限流器(3)装入花洒(8)，淋浴软管的一端接到水龙头的花洒接头(7)，另一端接花洒。

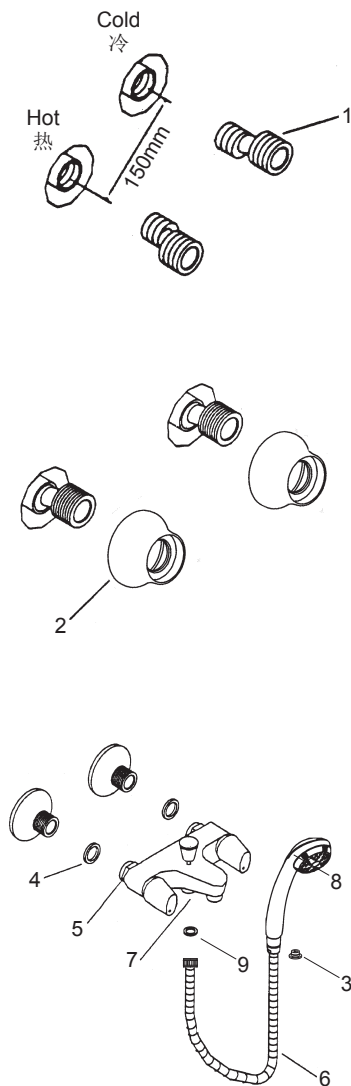

INSTALLATION

How To Install The Faucet

Install the two offset connectors(1) into the hot and cold supply pipes. Use thread tape on pipe threads.

Adjust the center-to-center distance between the connectors to150mm and level.

Thread the trim caps(2) onto the connectors so that the trim cap contacts the finished wall.

Insert washer seals(4) into supply nuts(5) of the faucet. Thread the faucet supply nuts(5) onto the connectors and tighten.

Install the restrictor(3) into the handspray(8) inlet. Seals(9) provided with hose must be installed in each end. Connect the shower hose(6) to faucet shower outlet(7) and handspray.

如何安装托架

先将固定销(11)从托架(10)上扣下，把塑料套(13)取出。将托架内腔中的自攻螺钉(12)和胀塞(14)取出。在淋浴软管可及的高度，选择一个安装托架的位置。

在墙壁上标上安装托架底板位置的记号，按记号钻两个洞。将胀塞插入洞中，然后按照图示将自攻螺钉通过塑料套旋入胀塞中，再用螺丝刀拧紧。将托架内壁的凹槽对准塑料套的凸台插入，然后将按钉按入托架的固定孔中。

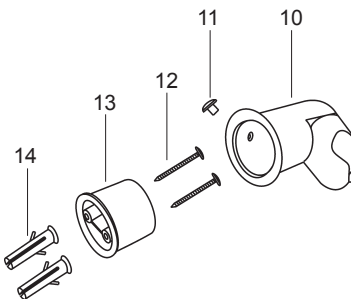

How To Install The Bracket

Take off the locking pin(11) from the bracket(10). Take out the self-tapping screws(12) and anchors(14) from the inside of the bracket by pulling out the plastic sleeve(13).

Mark bracket base mounting hole location on the wall. Drill two holes in the finished wall as required. Press the anchors into the holes and screw the self-tapping screws into the anchors though the sleeve. Tighten them by screwdriver. Aline the bugle of the bracket and the slot of the sleeve. Slide the bracket onto the sleeve and insert the locking pin into the hole of bracket and sleeve.

安装结果检查

检查并确保所有的衔接处都已拧紧。

确保手柄在“关”的位置。

打开排水系统和主要供水源，检查并修理有漏水的接口。

浴缸花洒龙头：

取下花洒(8)和泡器组件(15)。打开冷热水，让水流出约一分钟以清除杂质。检查渗漏。清洗起泡器。关闭水龙头，并装回起泡器组件和花洒。

花洒龙头：

取下花洒(8)。打开冷热水，让水流出约一分钟以清除杂质。检查渗漏。关闭水龙头，并装回花洒。

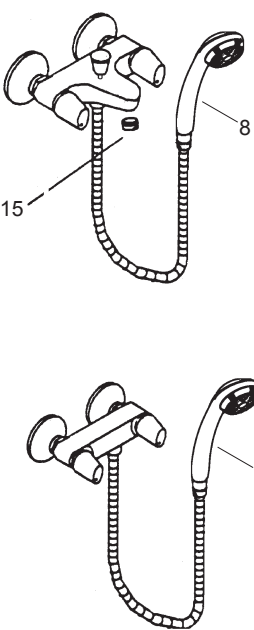

INSTALLATION CHECKOUT

Ensure that all coupling nuts are tight.

Ensure that the handles are in the off postion.

Turn on the main water supply, and check for leaks. Repair as needed.

Bath & Shower Faucet:

Remove the handspray(8) and aerator(15). Run hot and cold water through the faucet for about one minute to remove any debris. Check for leaks. Remove any debris from the aerator assembly. Shut the faucet off, and reinstall the aerator assembly and handspray.

Shower Faucet:

Remove the handspray(8). Run hot and cold water through the faucet for about one minute to remove any debris. Check for leaks. Shut the faucet off, and reinstall the handspray.

清洗说明

适用于所有加工处理过的表面：以中性肥皂水清洗镀层表面，再以干净的软布彻底擦干整个表面，有许多清洁剂，比如氨水、去污粉及洁厕灵等，会对电镀表面造成伤害，切忌使用。

有磨损性的清洁用具或清洁剂也不可使用于科勒牌的水龙头及其配件上。

CLEANING INSTRUCTIONS

All Finishes: Clean the finish with mild soap and warm water. Wipe entire surface completely dry with clean soft cloth. Many cleaners may contain chemicals, such as ammonia, chlorine, toilet cleaner etc. which could adversely affect the finish and are not recommended for cleaning.

Do not use abrasive cleaners or solvents on Kohler faucets and fittings.