

## BEFORE YOU BEGIN

- Congratulation on your purchase of this high quality Bathroom Accessory. Before proceeding with the installation, please carefully read this installation instruction in order to ensure proper care and assembly of this accessory.
- Please keep this installation instruction for future reference.



Prior to drilling into walls, check there are no hidden electrical wires, cables or water supply pipes with the aid of ar, electronic detector. If you use power tools do not forget:

1. Wear eye protection.
2. Unplug equipment after use.

## 安装之前

- 首先恭喜您购买到了高档的卫浴产品，为了使您正确保护和组装产品，在您安装之前请详细阅读此说明书。



警示：在钻孔之前，请借助电子探测仪确认墙内是否有电源线，通讯光缆或者水管之类的东西。如果使用电钻的话请勿忘记以下两点：

1. 请戴上防护镜。
2. 用完设备后关掉电源。

## TOOLS AND ACCESSORIES

## 工具及配件

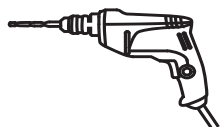

Drill  
电钻



Leveling Instrument  
水平尺



Screw Driver  
螺丝刀



Tape  
卷尺



Hammer  
锤子



Wrench  
扳手



Screw X9  
螺钉9个



Saw  
手工锯



1.5mm Hex Wrench  
1.5mm六角扳手

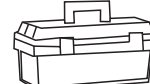

G1/2 & G3/4 Screw Die Machine  
G1/2和G3/4的手动扳牙机

## ROUGHING-IN

## 尺寸图

Reference Value  
参考值

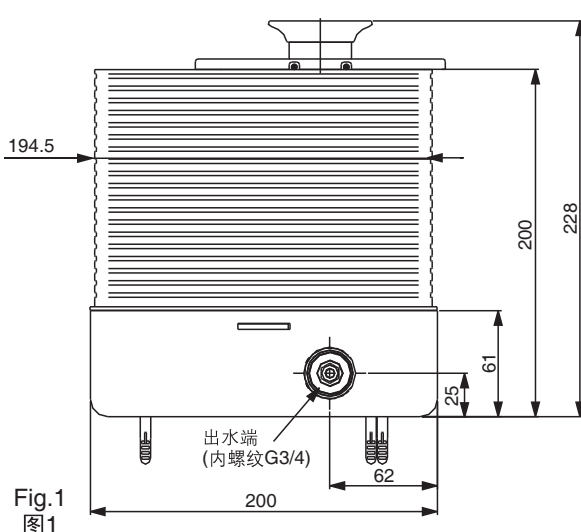
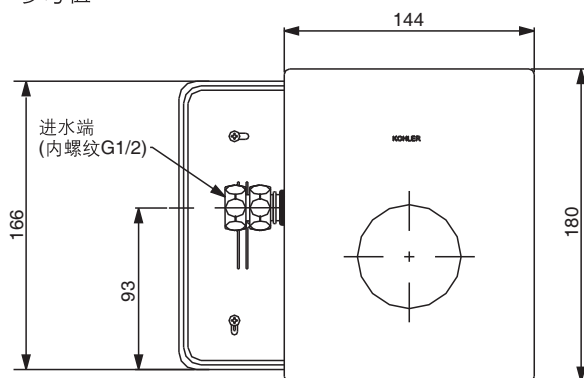

UNIT : mm  
单位：毫米

Fig.1  
图1

Kohler reserves the right to change marked dimensions without prior notice.  
科勒公司保留随时变更图中标示尺寸的权利，无需另行通知。

KOHLER CHINA INVESTMENT CO., LTD NO.158, JIANG CHANG SAN ROAD,  
JING'AN DISTRICT, SHANGHAI, PRC POST CODE: 200436  
科勒(中国)投资有限公司 上海市静安区江场三路158号 邮编：200436

## SPECIFICATIONS

## 规格

SKU	K-77691K-G/K-77692K-G/K-77693K-G
Flush Volume 冲水量	0.5L, 1L, 2.5L
Minimum Water Pressure 最低水压	0.05MPa(Dynamic Pressure 动压)
Maximum Water Pressure 最高水压	0.75MPa(Static Pressure 静压)
Water Temperature 工作水温	1°C~50°C

## INSTALLATION

## 安装

### 1. Drill wall

### 1. 凿毛坯墙施工法

Draw lines and drill the wall according to Fig.2. The horizontal distance between the bottom of plate and the top surface of urinal is advised to be 230mm. Depth can be adjusted as desired.

根据下图2在毛坯墙上画线，并按尺寸开凿毛坯墙。建议安装面板底部与小便器顶部平面之间的水平距离为230mm。深度请客户根据实际情况调整。

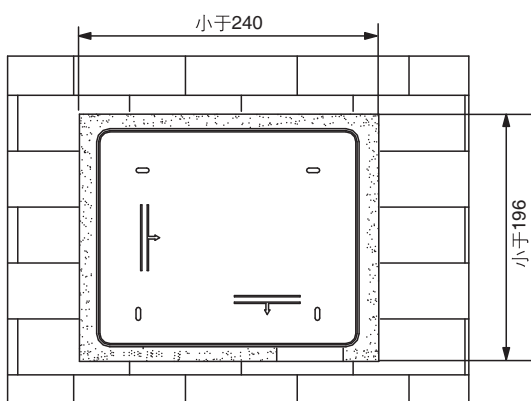

Fig.2  
图2

### 2. Fix box

### 2. 固定盒子

- Insert the box as shown in Fig.3. Adjust and fix the box with 4 screws.
- Cut the inlet and outlet pipes as shown (G1/2 female thread for inlet pipe)

- 按图3嵌入盒子，调整其位置后，使用4个螺钉固定。
- 按盒子标识线切割进、出水管(进水管为G1/2内螺纹)。

**Note:** The inlet and outlet pipes shall be cut level and clean and ensure its proper vertical and horizontal level.

注意：切割后的进、出水管需保证端面平整、光洁、水平度和垂直度。

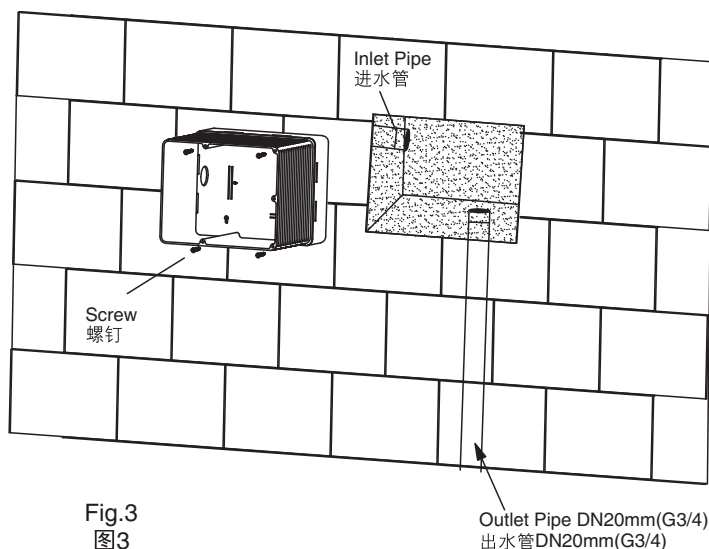

Fig.3  
图3

### 3. Cut box

Cut the excessive part of the box as shown.

### 3. 切割盒子

如图所示：切除盒子凸出墙面部分。

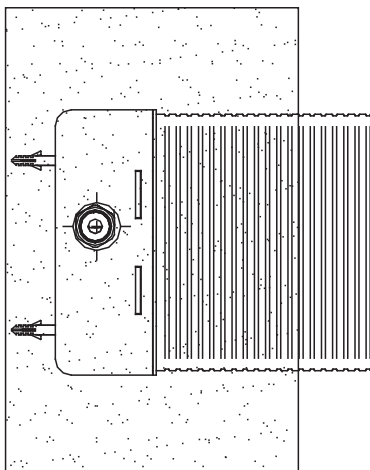

Fig.4  
图4

### 4. Install valve assembly

Fix valve assembly onto inlet and outlet pipes with wrench as shown in Fig.5.

### 4. 安装阀体组

根据图5所示，将阀体组用扳手安装在进水管上。

#### Fix onto inlet pipe

- Process inlet pipe thread and fix inlet pipe connector.
- Put seal onto the nut.
- Tighten valve assembly and inlet connector with wrench.

#### 进水端安装

- 加工进水管螺纹，并安装进水管接头组；
- 将垫片放入螺母内；
- 用扳手锁紧阀体组与进水接头。

#### Fix onto outlet pipe

- Put nut and seal onto outlet pipe.
- Tighten valve assembly and outlet connector with wrench.

#### 出水端安装

- 将出水螺母、锥形垫片套入出水管外；
- 用扳手锁紧阀体组与出水接头。

**Note:** Clean waste in the supply pipe before fixing inlet pipe.

注意：安装进水管前，请将供水管内的污垢清理干净。

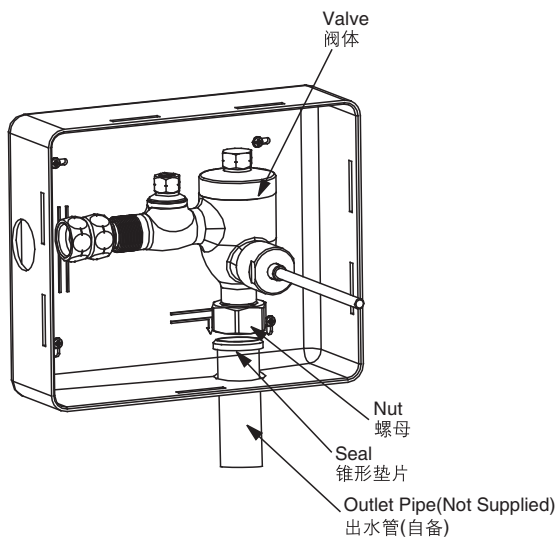

Fig.5  
图5

## 5. Cut and fix tile

Cut tiles as shown in Fig.6.

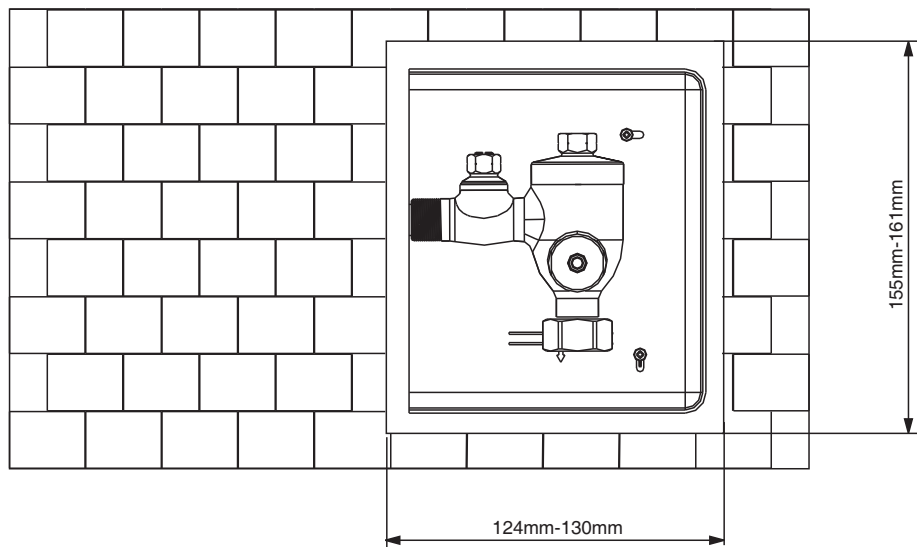

Fig.6  
图6

## 5. 切割瓷砖口并贴瓷砖

根据图6的尺寸切割瓷砖。

## 6. Fix bottom board

- Tighten the 6 screws on the bottom board.
- Cut the rod connector according to the depth into the tile ( $17.8^{+1}_0$ ).
- Fix the rod connector to the valve rod.

**Note:** Do not overtighten the nut to avoid deforming or damaging the bottom board.

- Test run and check the valve after installation.
- Water continues running at flush valve: Check whether the rod is still too long. Continue press the rod with the button to make the valve continue working.
- No water or too little water running from the valve: Check whether the rod is too short.
- Connect the manufacturer for any other problems.

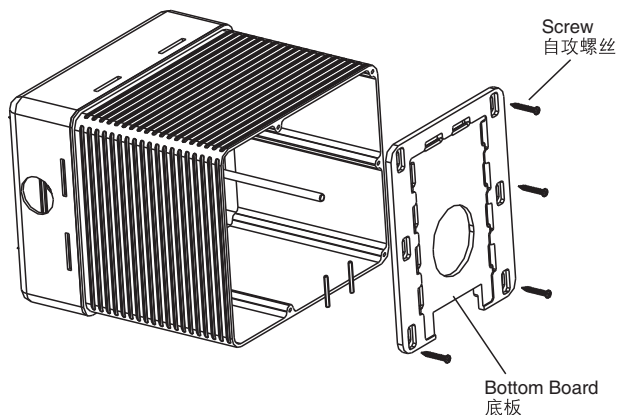

Fig.7  
图7

## 6. 固定底板

- 用6个自攻螺钉锁紧底板;
- 根据盒子安装深度, 切割推杆长度( $17.8^{+1}_0$ );
- 安装推杆接头于阀体组上。

注意: 锁紧后的自攻螺钉不可致使底板变形、破裂等异常出现。

- 安装完成后再次试运行工作, 检查产品工作状态:
- 冲洗阀不止水, 确认是否推杆接头切割后, 仍然较长。使按钮持续按压推杆, 致使冲洗阀持续工作;
- 冲洗阀不出水或者流量较小, 确认是否推杆接头切割后, 推杆接头较短, 按压按钮无法触碰推杆接头。
- 如果是其它问题, 请及时联系厂家。

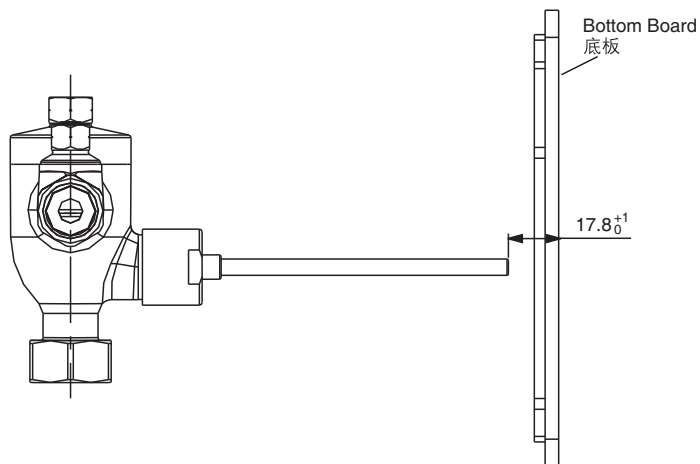

Fig.8  
图8

## 7. Fix faceplate

- Put the faceplate onto the bottom board.
- Pull the faceplate downwards.
- Tighten the rod with L wrench.

**Note:** When removing the faceplate, unscrew the screw 3mm out and push the faceplate 3.5mm upwards to remove it.

## 7. 固定面板组

- 将面板扣在底板上;
- 将扣好的面板下拉;
- 用L型扳手锁紧顶丝。

注意：维修需拆卸面板组时，顶丝退出面板组外3mm，然后将面板组沿墙面向上推移3.5mm左右即可将面板组从墙上取出。

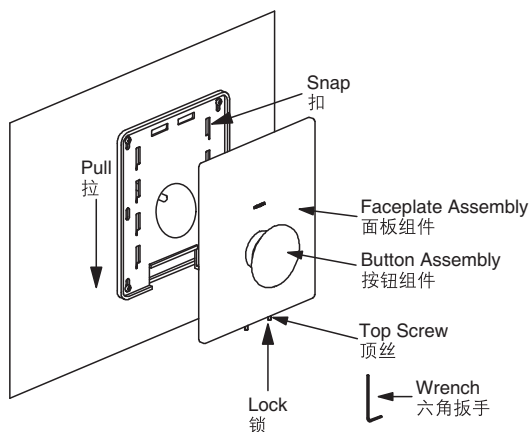

Fig.9  
图9

## 8. Maintenance

Test run and check the valve after installation. Leakage at inlet connector:

- Refer to Fig.7 to check whether the seal is properly installed, nut is tightened and whether the inlet pipe is at proper vertical and horizontal level.
- Leakage at outlet connector: Check whether the surface is smooth, the seal is twisted and the nut is tightened.
- Water cannot be stopped: Press the rod to check whether it can be restored, there is wastes inside and valve assembly is blocked.

## 8. 维修说明书

安装阀体组后，按压推杆使冲洗阀试运行工作，检查冲洗阀的各个连接部位能否密封，能否止水等异常出现：

- 进水接头处漏水，参照图7确认垫片是否安装好、螺母是否锁紧及进水管端面平整度和垂直度。
- 出水螺母连接漏水，需确认出水管外径表面光洁度、锥形垫片是否扭曲及出水螺母是否锁紧。
- 冲洗阀不止水，需按压杆，确认是否可正常回位、主体内是否有杂物、活体组件移动是否卡阻。