

- 97498T Towel Ring
- 97499T Robe Hook
- 97500T Double Robe Hook
- 97502T Vertical Toilet Paper Holder
- 97503T Covered Toilet Paper Holder

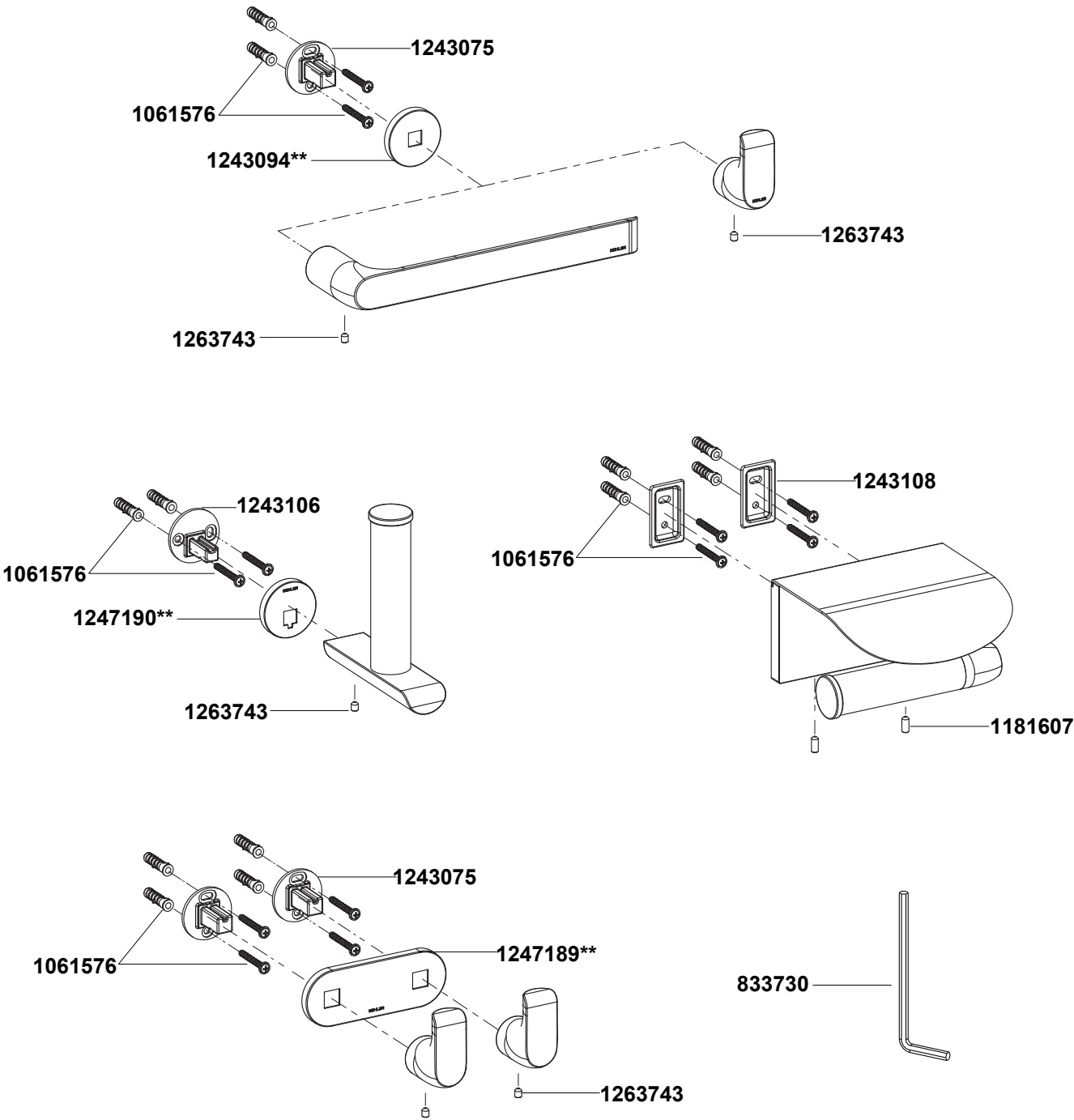

**Color code must be specified when ordering

- 97494T 18" Towel Bar
- 97495T 24" Towel Bar
- 97496T 24" Double Towel Bar
- 97497T 24" Double Towel Shelf
- 97498T Towel Ring
- 97499T Robe Hook
- 97500T Double Robe Hook
- 97502T Vertical Toilet Paper Holder
- 97503T Covered Toilet Paper Holder

BEFORE YOU BEGIN

All information is based on the latest product information available at the time of publication. Kohler Co. reserves the right to make changes in product characteristics, packaging, or availability at any time without notice.

Please leave these instructions for the consumer. They contain important information.

NOTE:

These products should be located and mounted to a wall. While it is possible to mount them to any surface, a stud or concrete mounted product will yield the best results.

DANGER: (Risk of personal injury)

These products are not designed or intended for use as a grab bar or support bar. Do not install where the product might be used as a grab or support bar.

ROUGH-IN DIMENSIONS

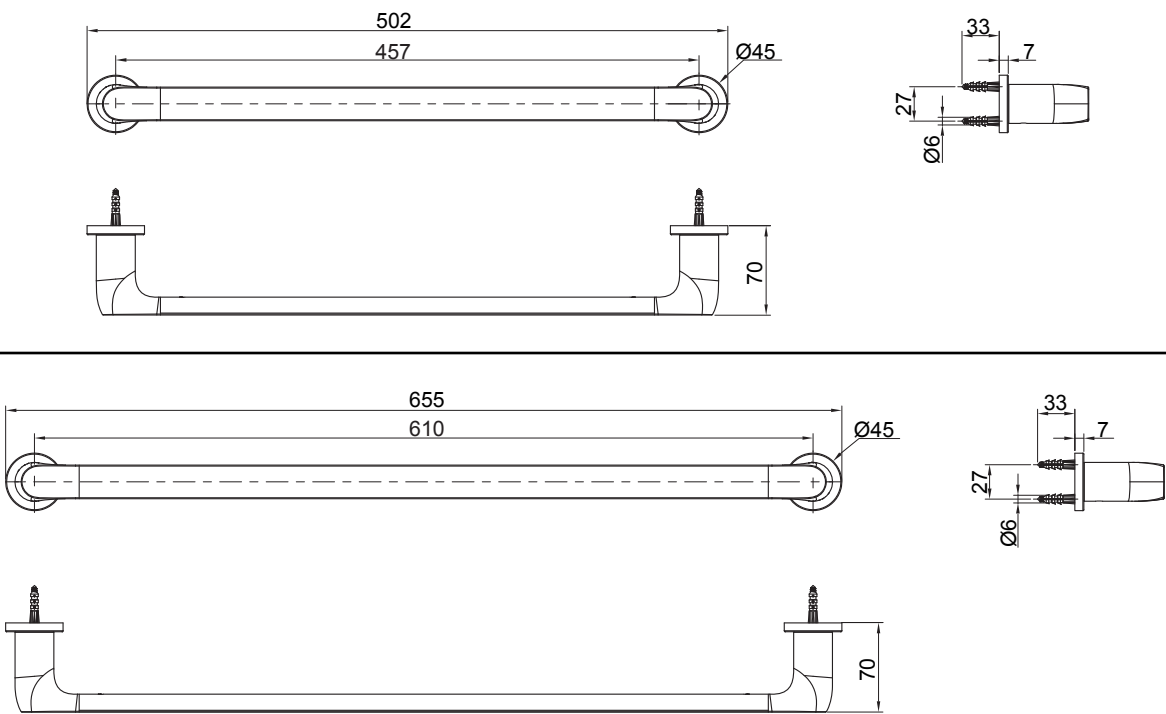

97494T

97495T



AVID

- 97494T 18" Towel Bar**
97495T 24" Towel Bar
97496T 24" Double Towel Bar
97497T 24" Double Towel Shelf

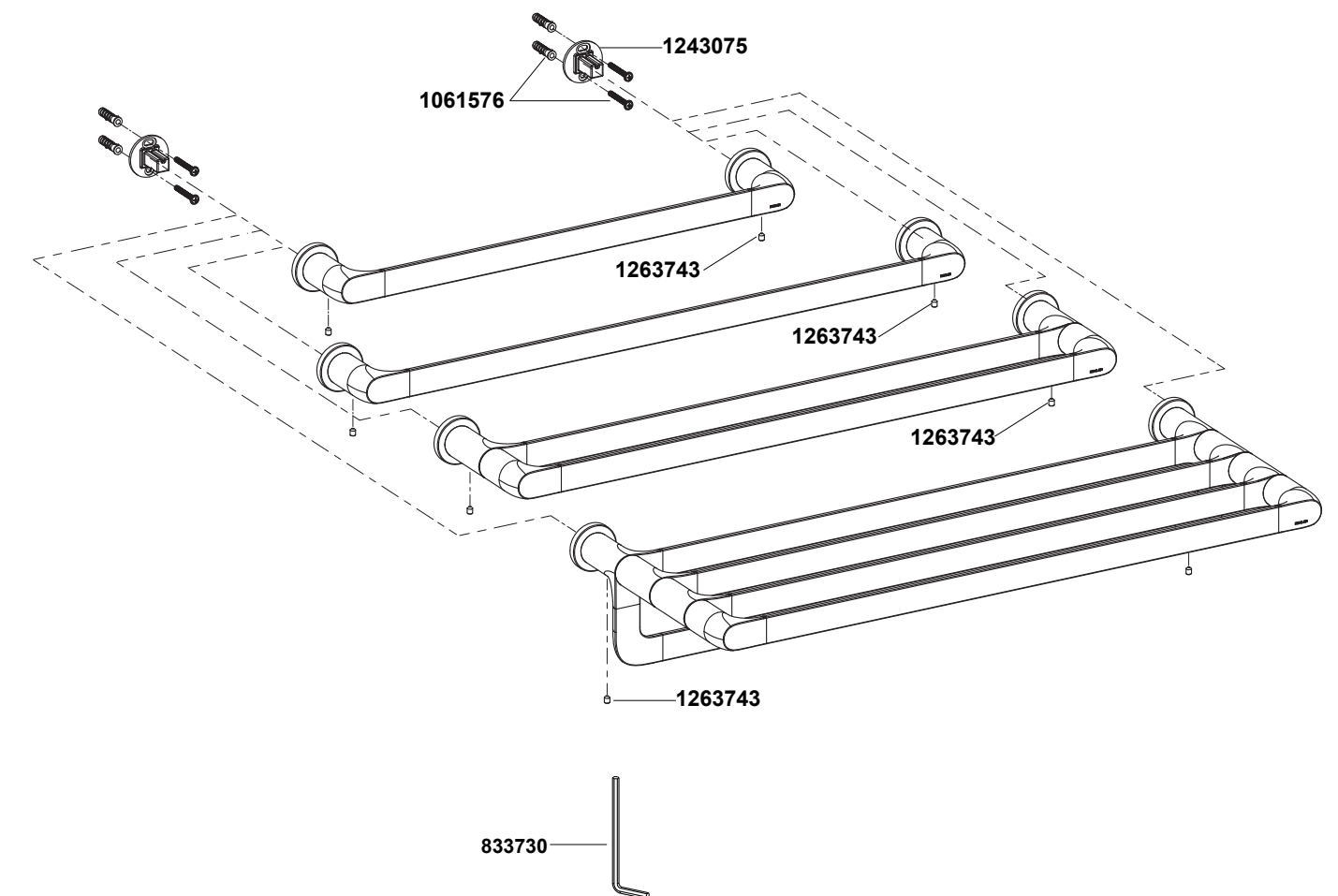

**Color code must be specified when ordering

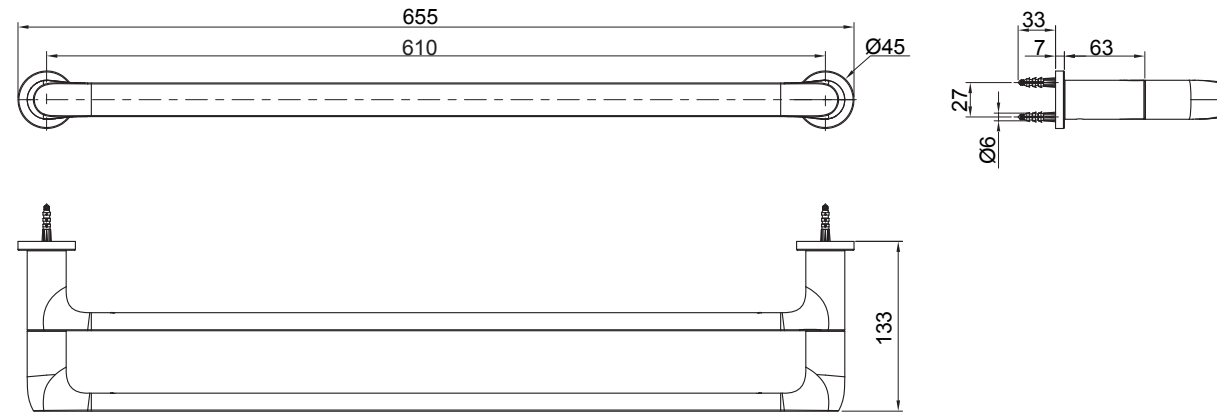

97496T

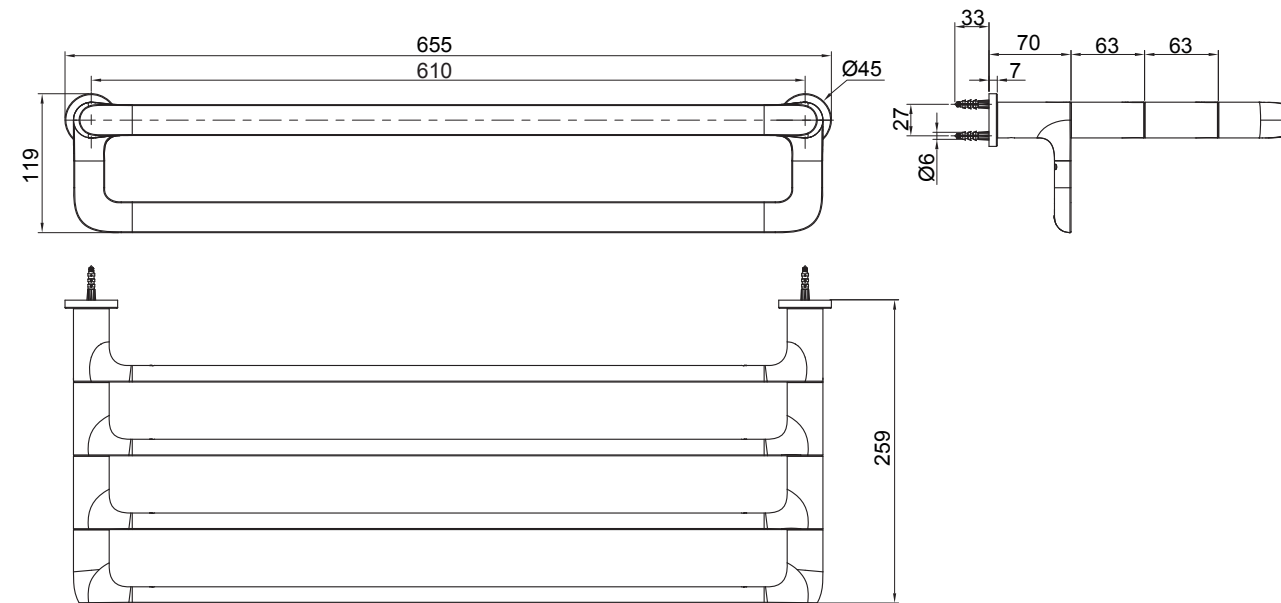

97497T

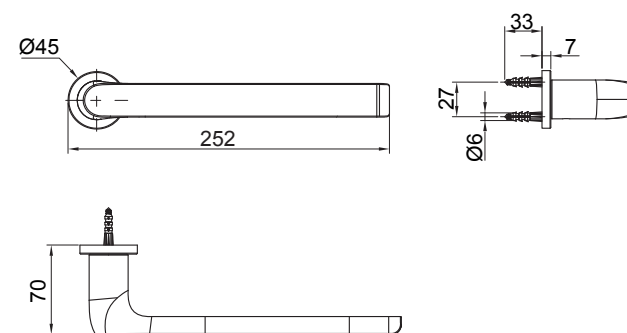

97498T

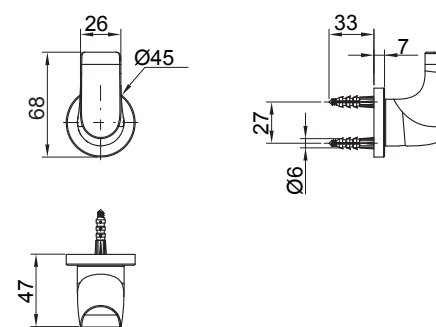

97499T

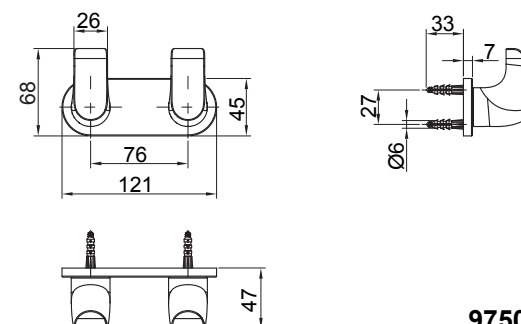

97500T

INSTALLATION CHECKOUT

Ensure that all connections are tightened.

Ensure all setscrews face straight down.

CLEANING INSTRUCTIONS

All Finishes: Clean the finish with mild soap and warm water. Wipe entire surface completely dry with a clean soft cloth. Many cleaners may contain chemicals, such as ammonia, chlorine, toilet cleaner etc. Which could adversely affect the finish and are not recommended for cleaning.

Do not use abrasive cleaners or solvents on Kohler faucets and fittings.

INSTALLATION

Install The Single/Double Towel Bar&Towel Shelf



Select a location on the vertical wall to stick the templet, ensure the templet is horizontal. Drill hole in the finished wall as required.

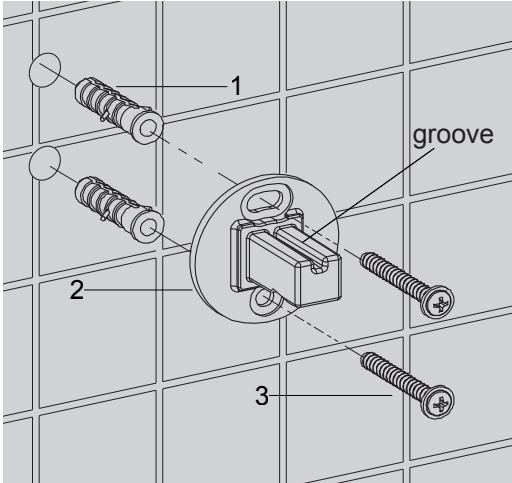

Press the anchor(1) into the hole. Orienting the groove of the bracket upward. Secure the bracket(2) with the self-tapping screw(3).

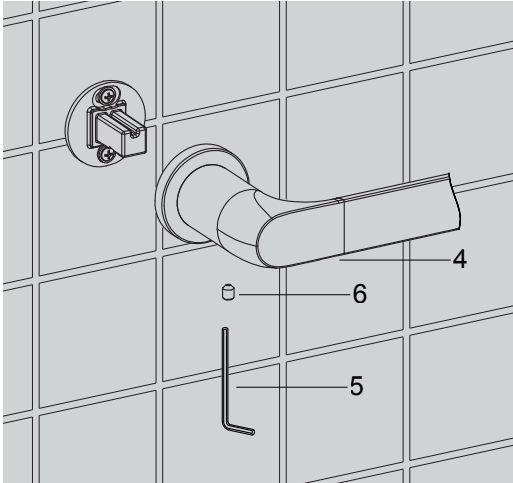

Slide the main body(4) onto the bracket. Orient the screw hole downward. Tighten the screw(6) with the hex wrench(5).

Install The Double Robe Hook

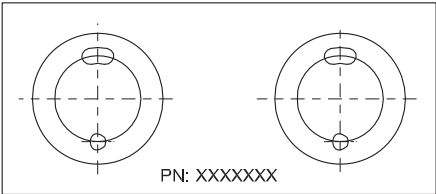

Select a location on the vertical wall to stick the templet, ensure the templet is horizontal. Drill hole in the finished wall as required.

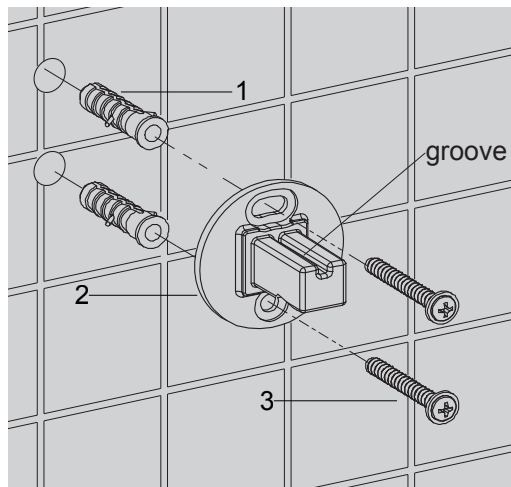

Press the anchor(1) into the hole. Orienting the groove of the bracket upward. Secure the bracket(2) with the self-tapping screw(3).

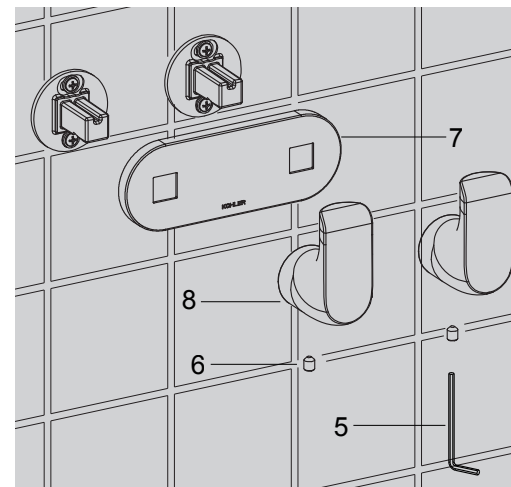

Slide the escutcheon(7) onto the bracket. Keep "KOHLER" logo on escutcheon is on positive direction. Slide the robe hook(8) onto the bracket. Orient the screw hole of the robe hook downward. Tighten the screw(6) with the hex wrench(5).

Install The Covered Toilet Paper Holder

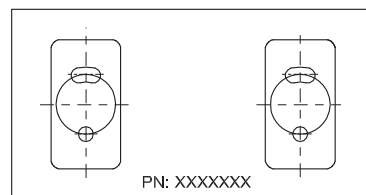

Select a location on the vertical wall to stick the templet, ensure the templet is horizontal. Drill hole in the finished wall as required.

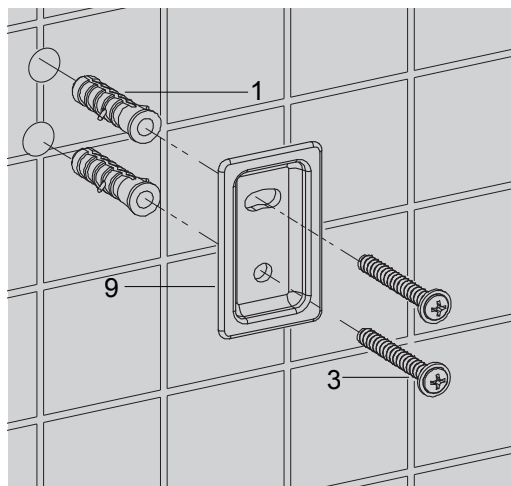

Press the anchor(1) into the hole. Orienting the large slotted mounting hole of the bracket upward, the smaller hole of the bracket downward and two screw holes are vertical. Secure the bracket(9) with the self-tapping screw(3).

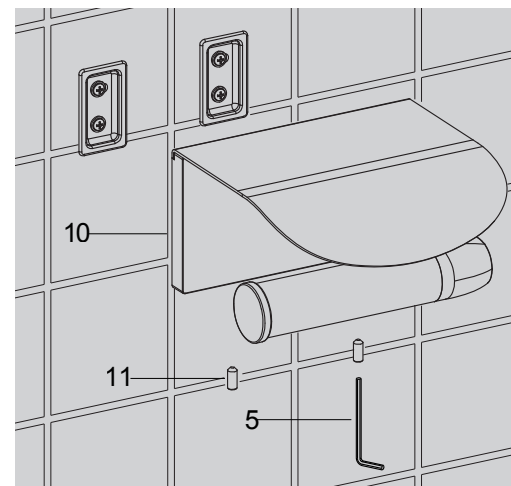

Slide the main body(10) onto the bracket. Orient the screw hole downward. Tighten the screw(11) with the hex wrench(5).

Install The Robe Hook/Towel Ring/Vertical Toilet Paper Holder

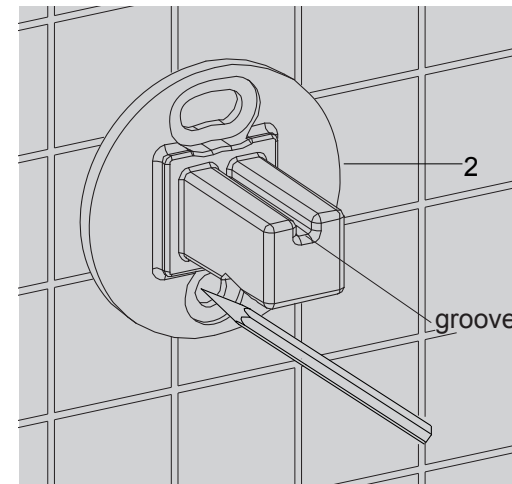

Select a location on the vertical wall to install the bracket. Mark anchor(1) mounting hole location on wall, ensure the groove of bracket(2)(12) upward. Drill hole in the finished wall as required.

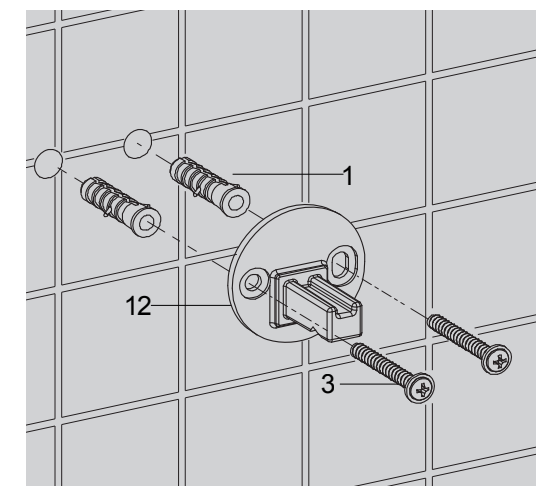
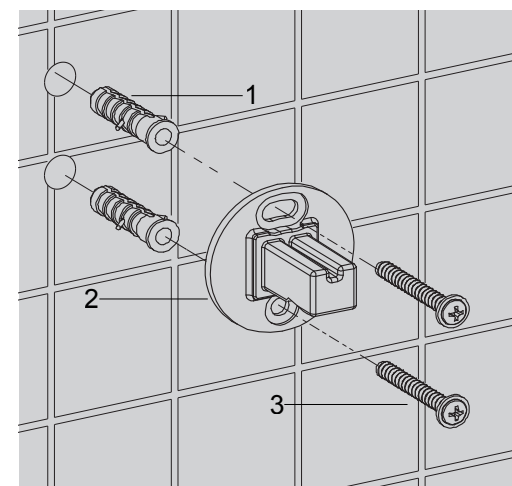
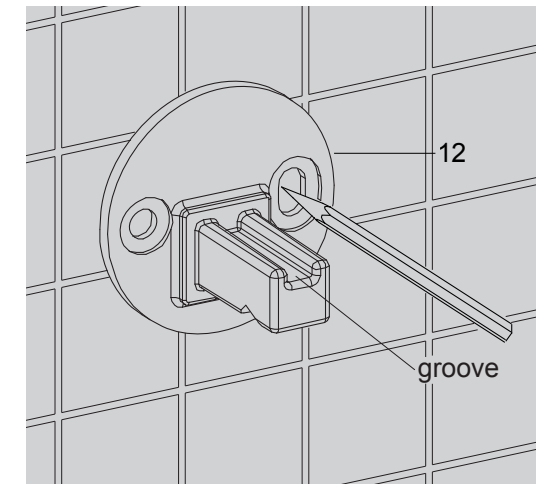

Press the anchor(1) into the hole. Orienting the groove of the bracket upward. Secure the bracket(2)(12) with the self-tapping screw(3).

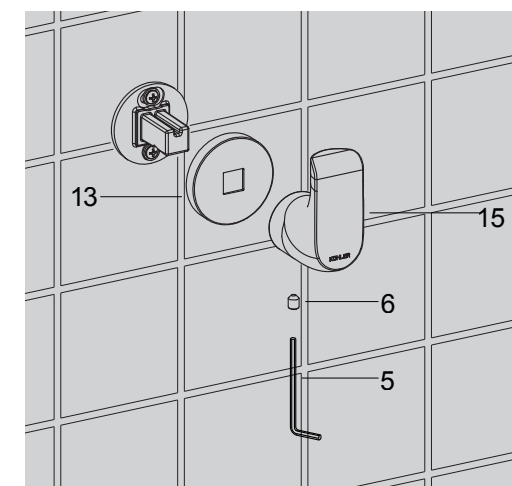

Slide the escutcheon(13)(14) onto the bracket. Orient the gap of escutcheon(14) downward. Slide the main body(15)(16) onto the bracket and keep the screw hole downward. Tighten the screw(6) with the hex wrench(5).

