

19774/19774A-4ND SINGLE LEVER TALL LAVATORY FAUCET

BEFORE YOU BEGIN

All information is based on the latest product information available at the time of publication. Kohler Co. reserves the right to make changes in product characteristics, packaging, or availability at any time without notice.

Please leave these instructions for the consumer. They contain important information.

NOTES:

- 1. Flush the water supply pipes thoroughly to remove debris.
- 2. Inspect the supply tubing for damage. Replace as necessary.
- 3. Observe local plumbing codes.
- 4. If possible, install this faucet before installing the lavatory.

HANDLE OPERATION

Lift the handle gently. Turn clockwise for hot water, counter-clockwise for cold water.

ROUGH-IN DIMENSIONS

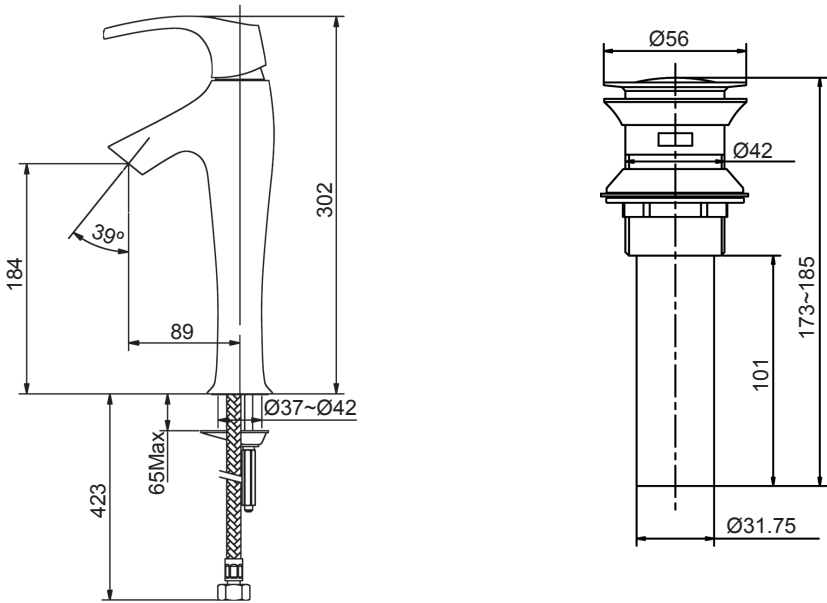

Only for 19774X

INSTALLATION

How To Install The Faucet

Screw the stud(1) to the holes of the faucet bottom. Put the washer(2) into the bottom of body(4) of the faucet through the flexible hoses(3) and the stud. Insert the hoses(3) into the hole of the lavatory. Position the faucet. From underside of the lavatory, fit the bracket(5) and washer(6) on the thread stud and secure the faucet by tightening nut(7).

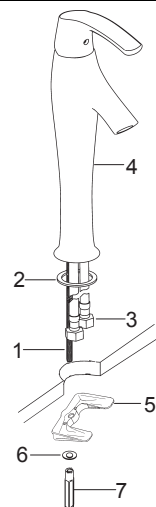

How To Install The Drain(Only for 19774X)

Remove the locknut(13), plastic washer(12), rubber gasket(11) and tailpiece(10) from the drain body. Supply enough tape or sealant to tailpiece thread. Reinstall the tailpiece. Insert the drain body into the lavatory. Put the rubber gasket(Tapered side up), plastic washer and locknut back to the drain body in turn. Tighten the locknut.

NOTE: If needed, apply a ring of plumbers putty or other sealants around the underside of the drain flange(8), instead of using rubber washer(9).

Do not reposition the drain after the locknut is tightened, or you may break the putty or sealant seal.

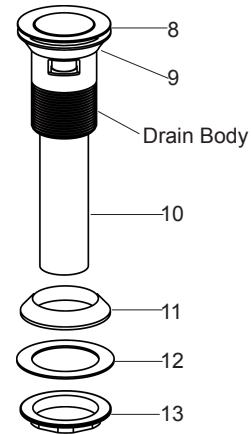

INSTALLATION CHECKOUT

Ensure all coupling nuts are tight. Ensure that handle is in the off position.

Turn on main water supply. Repair as required.

Remove aerator assembly(15) by key(14). Turn faucet handle on and run hot and cold water through spout for about one minute to remove any debris. Check for leaks at this time. Remove any debris from aerator assembly. Shut the faucet off and reinstall aerator assembly.

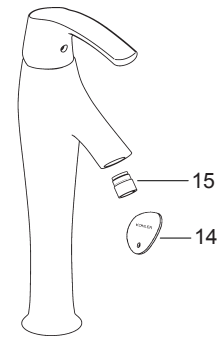

CLEANING INSTRUCTIONS

All Finishes: Clean the finish with mild soap and warm water. Wipe entire surface completely dry with clean soft cloth. Many cleaners may contain chemicals, such as ammonia, chlorine, toilet cleaner etc. which could adversely affect the finish and are not recommended for cleaning.

Do not use abrasive cleaners or solvents on Kohler faucets and fittings.

19774/19774A-4ND SINGLE LEVER TALL LAVATORY FAUCET

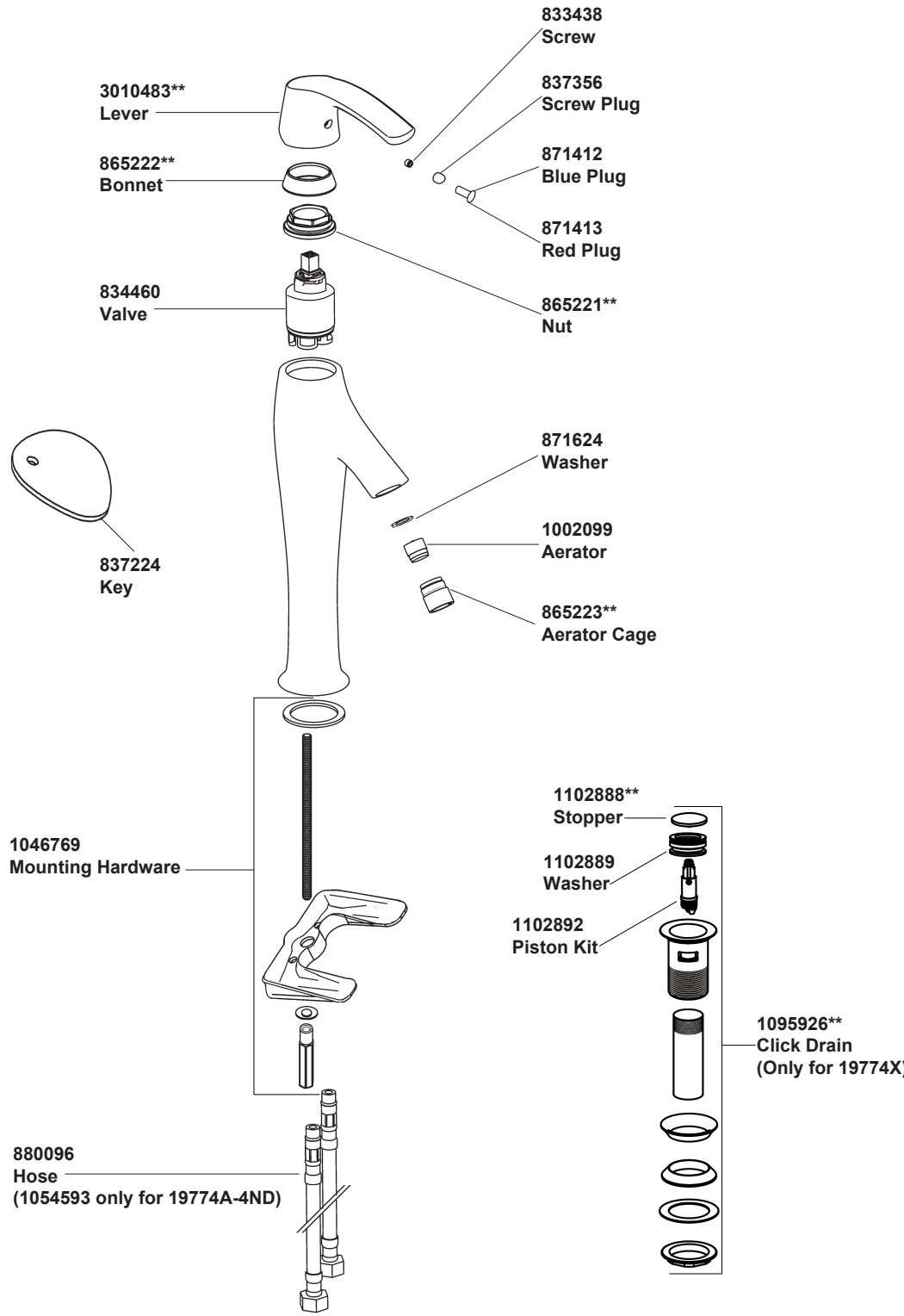

**Color code must be specified when ordering