

BEFORE YOU BEGIN

- Please read these instructions carefully to familiarize yourself with the required tools, materials, and installation sequences. Follow the sections that pertain to your particular installation. This will help you avoid costly mistakes. In addition to proper installation, read all operating and safety instructions.
- All information in these instructions is based upon the latest product information available at the time of publication. Kohler China reserves the right to make changes in product characteristics, packaging, or availability at any time without notice.
- These instructions contain important care, cleaning, and warranty information—**please leave instructions for the consumer.**

安装之前

- 请通读本说明书，以便了解所需工具、材料及安装程序。请遵照相关章节进行安装，以避免由于安装不当而导致不必要的损失。除了有关正确的安装方法之外，还务请详阅所有操作安全说明。
- 本说明书所含一切资料，均以印刷时所有的最新产品为准。科勒中国保留随时更改产品特征、包装或供应情况的权利，恕不另行通知。
- 本说明书包含了有关护理、清洁及保养等重要资料—**请交予用户保存。**

TOOLS AND MATERIALS

- Tape measure
- Screw driver

所需工具及材料

- 卷尺
- 十字螺丝刀

PRODUCT REQUIREMENTS

产品规格

1. Electrical requirement: DC 4 AA alkaline batteries

1. 电气规格：4节5号碱性电池（LR06×4）

2. Dimension requirement: L×W×H=46.5mm × 36.5mm × 83mm.

2. 尺寸规格：长×宽×高 =46.5mm × 36.5mm × 83mm。

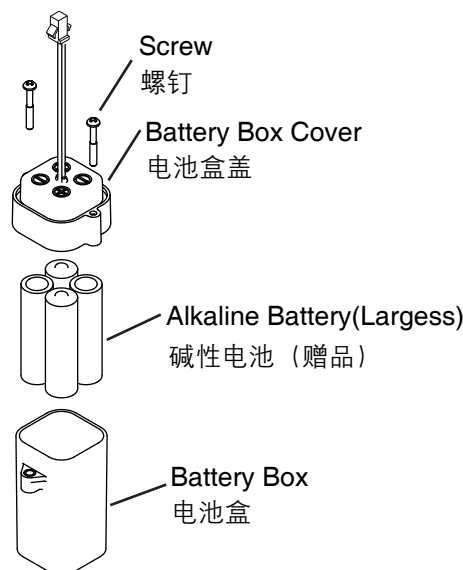

科勒（中国）投资有限公司
中国上海市闸北区江场三路158号 邮编：200436
制造商：上海科勒电子科技有限公司
中国上海市宝山区丰翔路1955号 邮编：200444

INSTALLATION

安装说明

1. Take out battery case assy., and loosen the screws(1). Place 4 AA batteries into the battery case according to negative and positive electrode marks on the battery case cover(2). Tighten the screws on the battery case cover(2).

NOTE: do not mistake the battery electrodes, and do not use the new and used batteries together.

2. Determine the installation location of battery case per rough-in. Drill holes and place sheath in it. Secure the battery case with self-tapping screws and connect each colored connector to the corresponding connector of the same color.

NOTE: Connectors shall face up.

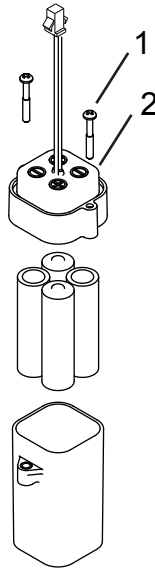

1. 取出电池盒组件，旋松螺钉（1），按电池盒盖（2）上的正负极标示装入4节5号电池，紧锁电池盒盖（2）的螺钉（1）后。

注意：电池极性不能装反，新旧电池不能混用。

2. 在合适的位置打孔，打入膨胀管，用自攻螺钉固定电池盒。将相同颜色接插件分别连接。

注意：接插件位置朝上。

IMPORTANT CONSUMER INFORMATION 用户须知

1. All installation staff should be well familiar with installation instruction.
2. Do not install AC power supply in a location where it might be showered or soaked with water or other liquids.
3. All electrical connection must be compliance with related regulation and codes.

1. 所有参与安装人员都必须熟知安装说明。
2. 电源盒应安装在干燥，不会被水淋湿、浸泡的位置。
3. 所有电路连接必须符合相关规范和条例要求。

产品中有害物质含量的说明

回收提示

本产品超过使用期限或经过维修无法正常使用后，不应随意丢弃，请交由有废弃电器电子产品处理资质的企业处理，正确的处理方法请查阅国家或当地有关废旧电器电子产品处理的规定。

有害物质统计表

部件名称	有害物质名称					
	铅 (Pb)	汞 (Hg)	镉 (Cd)	六价铬 (Cr(VI))	多溴联苯 (PBB)	多溴二苯醚 (PBDE)
电池盒组件	○	○	○	○	○	○
电池	○	○	○	○	○	○
附件类	○	○	○	○	○	○

○：表示该有害物质在该部件所有均质材料中的含量均在GB/T 26572现行有效版本规定的限量要求以下。

×：表示有害物质至少在该部件的某一均质材料中的含量超出GB/T 26572现行有效版本规定的限量要求。

*：表示部分机型含有该部件。

注：本表格提供的信息是基于供应商提供的数据及科勒公司的检测结果。本产品应用环保设计理念，在当前技术水平下，所有有害物质或元素的使用已经控制到了最低程度，科勒公司会继续努力通过改善现有技术来减少这些物质的使用。



本产品的“环保使用期限”为10年，科勒公司根据产品设计特性指定该期限。只有在本产品使用说明书所述的正常情况下使用本产品时，“环保使用期限”才有效。

Description of Content of Hazardous Substances in Product

Reclaim Indication

When the product exceeds service life or is unable to use after repair, do not throw the product away in the normal trash. Please dispose the waste electronic parts through a qualified reclamation enterprise. Make sure the product is handled properly. Disposing of product must be done in accordance with the local or national government law.

Statistics of Contents of Toxic or Hazardous Substances or Elements

Part name	Toxic or Hazardous Substance or Elements					
	Lead (Pb)	Mercury (Hg)	Cadmium (Cd)	Hexavalent Chromium (Cr(VI))	Polybrominated biphenyls (PBB)	Polybrominated Diphenyl Ethers (PBDE)
Battery Box Assy.	○	○	○	○	○	○
Battery	○	○	○	○	○	○
Accessories	○	○	○	○	○	○

- : Indicates that the substance in the material composition is below the high limits of the current requirements in GB/T26572.
- × : Indicates that at least one of the homogeneous substance in the material composition is below the high limits of the current requirements in GB/T 26572.
- * : Indicate only partial product series contains this substance.

Note: the information provided is based on the supplier data and Kohler inspection results. The product is designed not to hurt the environment. Under current technology, all hazardous materials have been used in the smallest amounts possible. Kohler will strive to reduce the use of these hazardous materials used in this product.



The product "service life for environment protection" is 10 years; Kohler Company will specify product service life based on product characteristics. The product "service life for environment protection" is only effective when the product is used as described in the product specification.