

45444T-4 8" 面盆龙头

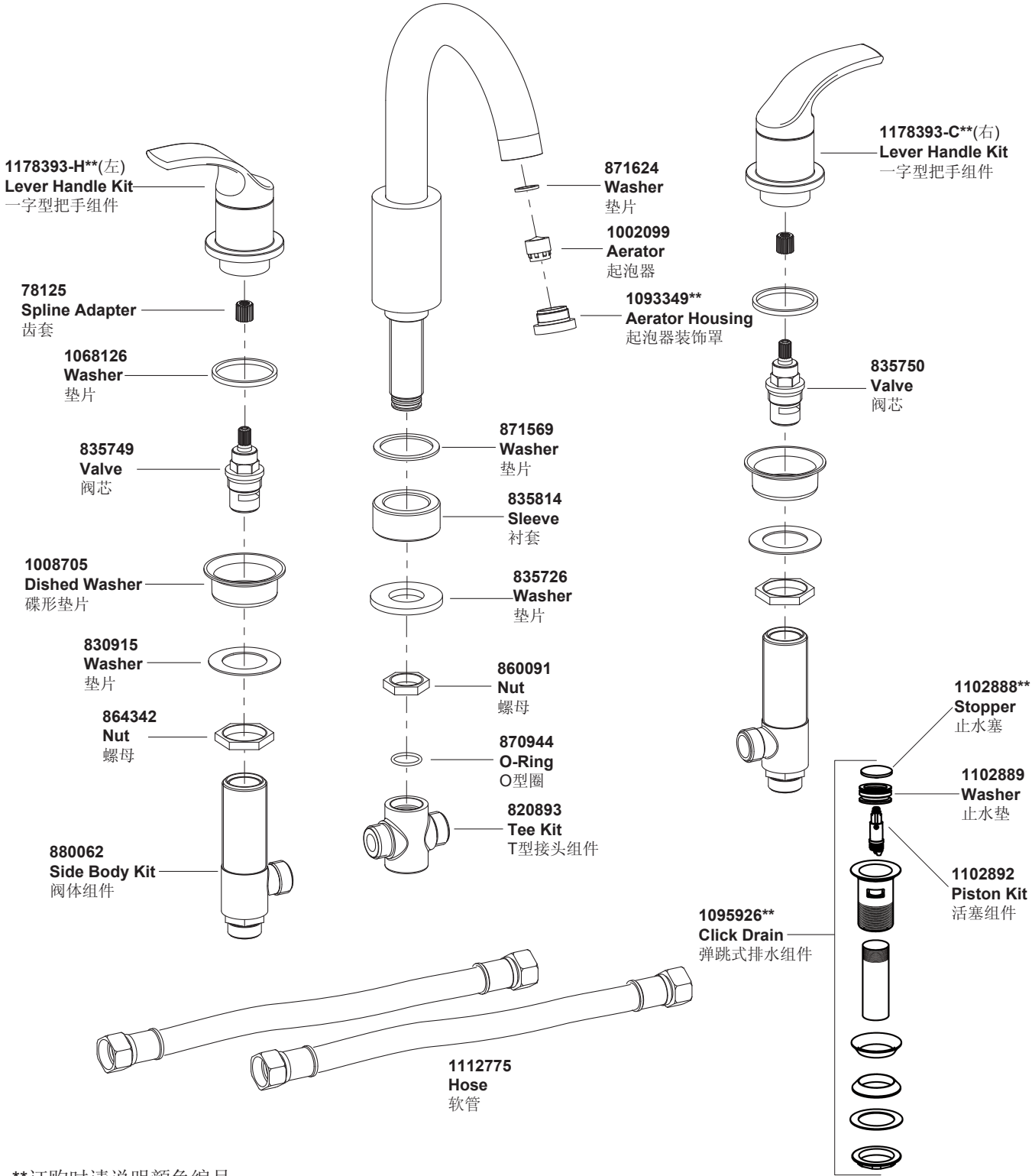

\*\*订购时请说明颜色编号  
\*\*Color code must be specified when ordering

45444T-4 8" 面盆龙头

安装之前

所有的资料是按最新出版的产品资料编写而成。科勒公司保留任何时候不经通知即可改变产品特性、包装或产品可供类型的权利。

说明书包括重要的安装、保养及清洁方面的内容，请把这些资料交给用户阅读。

- 注意事项：
1. 一定要先彻底冲洗供水管以清除管道中的杂质。
  2. 检查供水管有无损坏。如需要，进行替换。
  3. 遵守当地管路安装条例。
  4. 尽可能在安装面盆之前安装水龙头。

BEFORE YOU BEGIN

All information is based on the latest product information available at the time of publication. Kohler Co. reserves the right to make changes in product characteristics, packaging, or availability at any time without notice.

Please leave these instructions for the consumer. They contain important information.

- NOTES:
1. Flush the water supply pipes thoroughly to remove debris.
  2. Inspect the supply tubing for damage. Replace as necessary.
  3. Observe local plumbing codes.
  4. If possible, install this faucet before installing the lavatory.

使用说明

逆时针旋转左把手为开，顺时针旋转右把手为开。

HANDLE OPERATION

Left handle opens with one-quarter turn counter-clockwise. Right handle opens with one-quarter turn clockwise.

安装尺寸

ROUGH-IN DIMENSIONS

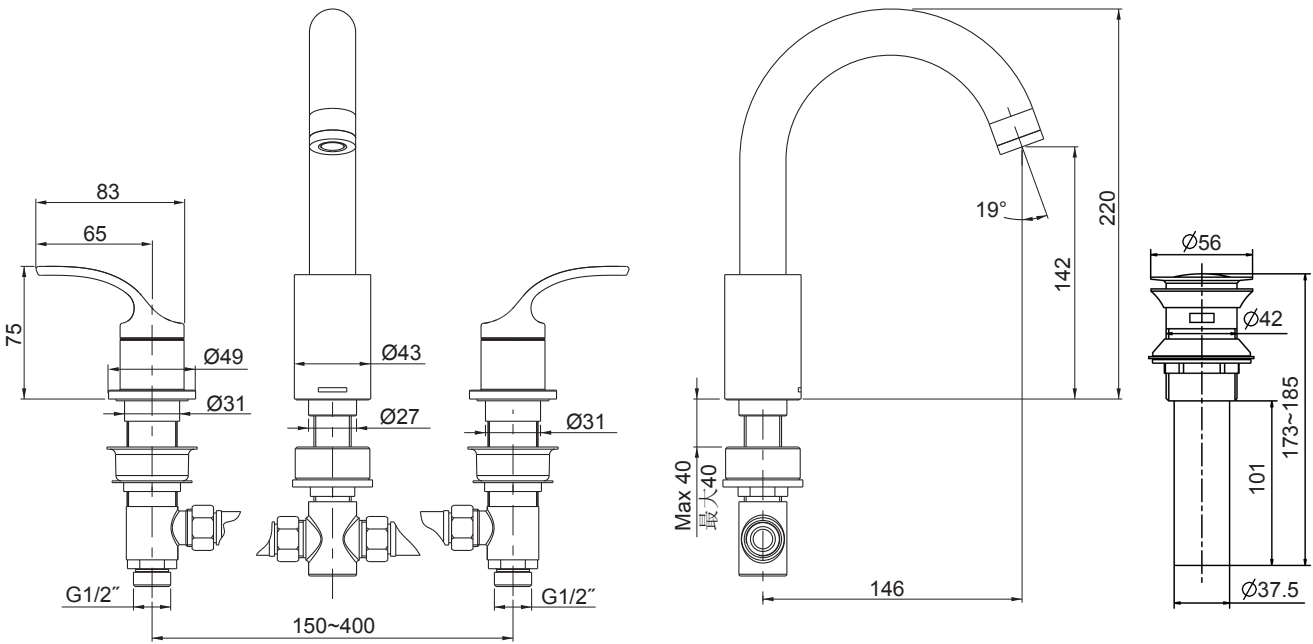

安装步骤	INSTALLATION
<div>如何安装出水口</div> <div>从出水口组件(1)上依次取下螺母(5)和垫片(4)和衬套(3)，垫片(2)留在出水口组件上，并嵌入出水口底部凹槽内。</div> <div>将出水口组件装于面盆中孔。</div> <div>从面盆下方依次将衬套(3)、垫片(4)和螺母(5)安装到出水口组件(1)上，调整出水口位置，锁紧螺母(5)以固定出水口。将T型接头(6)选到出水口底部螺纹上。</div>	<div>How To Install The Spout</div> <div>Remove the parts from spout assembly (1) according to the following order: nut(5), washer(4) and sleeve(3). Washer remains on the spout assembly, inserting in the groove of the spout assembly.</div> <div>Fit the spout assembly to the center hole of lavatory.</div> <div>Reinstall the parts from underside of the lavatory according to the following order: sleeve(3), washer(4) and nut(5). Position the spout. Tighten the nut(5). Screw the center tee(6) to the spout.</div>
<div>如何安装阀体、把手和软管</div> <div>将把手组件(7)从阀体组件(15)上取下来。将垫片(9)嵌入把手装饰盖(8)底面的凹槽。</div> <div>将带有碟形垫片(12)、垫片(13)和锁紧螺母(14)的阀体组件从面盆下方插入安装孔(面向龙头时，贴有红色标记的阀体装在左侧)。将齿套(10)装在阀轴(11)上，将把手组件旋紧到阀体上(面向龙头时，带红色垫片的把手安装在左侧)。旋紧锁紧螺母(14)。</div> <div>将垫片放入软管(16)两端，用软管连接阀体组件与T型接头(17)。</div> <div>注意：软管(16)只能用于此处。</div> <div>把手安装完毕，处于关闭状态的位置如图所示：</div>	<div>How To Install The Bodies, The Handles And Hoses</div> <div>Remove the handle kit(7) from the side body(15). Put the washer (9) into the groove on the bottom of the escutcheon(8).</div> <div>Insert the side body with dished washer (12), washer(13) and nut(14) through mounting holes from bottom of the lavatory (The side body with red mark on the left when facing the front of the faucet). Press the spline adapter(10) onto the valve stem(11), reinstall and tighten the handle kit (The handle with the red washer on the left when facing the front of the faucet). Tighten the nut(14).</div> <div>Put the washers into the ends of the hose(16). Connect the side bodies and supply tee(17) with hoses as shown in the figure.</div> <div>NOTE: The hoses(16) should only be used here.</div> <div>The configuration shown is the correct position of the handles in the closed position.</div>

如何安装排水器	How To Install The Drain
<div>把锁紧螺母(23)、塑料垫片(22)、橡胶垫圈(21)和尾管(20)从排水本体上依次取下。在尾管螺纹处须缠绕足以密封的密封胶带或涂合适的密封胶，装回排水本体。把排水本体从面盆上部孔插入。再依次将橡胶垫圈(小面朝上)、塑料垫片和锁紧螺母从排水本体底部装入。锁紧螺母。</div> <div>注意：在锁紧螺母拧紧后，不可调整排水本体的位置，否则会破坏油灰密封或密封剂密封。</div> <div>注意：如果需要，可直接在排水器盘片(18)底面沿周围涂一圈密封油灰或其他密封剂，而不使用橡胶垫片(19)。</div>	<div>Remove the locknut(23), plastic washer(22), rubber gasket(21) and tailpiece(20) from the drain body. Supply enough tape or sealant to tailpiece thread. Reinstall the tailpiece. Insert the drain body into the lavatory. Put the rubber gasket (Tapered side up), plastic washer and locknut back to the drain body in turn. Tighten the clocknut.</div> <div>NOTE: Do not reposition the drain after the locknut is tightened, or you may break the putty or sealant seal.</div> <div>NOTE: If needed, apply a ring of plumbers putty or other sealants around the underside of the drain flange(18), instead of using rubber washer(19).</div>
安装结果检查	INSTALLATION CHECKOUT
<div>检查并确保所有衔接处都已拧紧，确保把手在关的位置。</div> <div>打开主要供水源和排水系统，检查并修理有漏水的接口。</div> <div>取下起泡器(24)，打开龙头的冷热水，让水流出一分钟以清除杂质, 检查有无渗漏。冲洗起泡器，关闭水龙头，重新装回起泡器。</div>	<div>Ensure that all coupling nuts are tight. Ensure that the lever handles are in the off position.</div> <div>Turn on the main water supply and drain, and check for leaks. Repair as needed.</div> <div>Remove the aerator(24). Turn the faucet handle on. Run hot and cold water through spout for about one minute to remove any debris. Check for leaks. Repair as needed. Remove any debris from the aerator. Shut off the faucet. Reinstall the aerator.</div>
清洗说明	CLEANING INSTRUCTIONS
<div>适用于所有加工处理过的表面：以中性肥皂温水清洗镀层表面，再以干净的软布彻底擦干整个表面。许多清洁剂，比如氨水、去污粉及洁厕灵等，会对电镀表面造成伤害而不宜使用。</div> <div>有磨损性的清洁用具或清洁剂也不可使用于科勒牌的水龙头及其配件上。</div>	<div>All Finishes: Clean the finish with mild soap and warm water. Wipe entire surface completely dry with clean soft cloth. Many cleaners may contain chemicals, such as ammonia, chlorine, toilet cleaner etc. which could adversely affect the finish and are not recommended for cleaning.</div> <div>Do not use abrasive cleaners or solvents on Kohler faucets and fittings.</div>