

668 SINGLE LEVER KITCHEN FAUCET

BEFORE YOU BEGIN

All information is based on the latest product information available at the time of publication. Kohler Co. reserves the right to make changes in product characteristics, packaging, or availability at any time without notice.

Please leave these instructions for the consumer. They contain important information.

NOTES:

1. Flush the water supply pipes thoroughly to remove debris.
2. For new installations, assemble the faucet and drain to sink before installing.

HANDLE OPERATION

Lift the handle gently. Turn clockwise for hot water, counter-clockwise for cold water.

ROUGH-IN DIMENSIONS

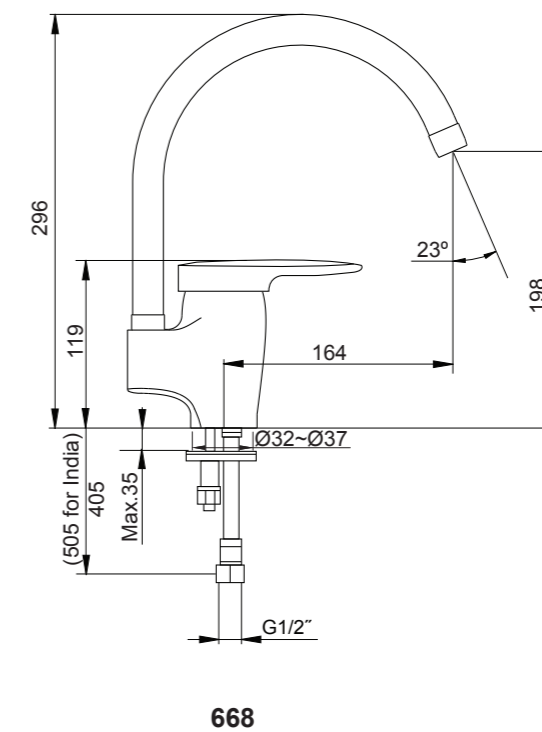

INSTALLATION

How To Install The Faucet

Insert the spout kit(1) into the outlet hole. Tighten the screw(2) by hex wrench(3).

Install the mounting stud(5) into the faucet body base(6). Slide O-Ring(7) into groove on body assembly. Insert the flexible supply hoses(4) into the hole from under the sink and install the flexible supply hoses into the faucet holes. Tighten it by hand.

From underside of sink, place bracket(8) and nut(9) onto mounting stud(5). Position faucet so that spout is toward the back. Tighten nut to secure faucet to sink.

Attach the hoses to water supplies. When facing front of faucet, the left hose is hot water, the right hose is cold water.



INSTALLATION CHECKOUT

Ensure that all connections are tight.

Ensure that the handle is in the off position.

Open the drain. Turn on main water supply and check for leaks. Repair as needed.

Remove aerator assembly(10). Turn the faucet handle on and run hot and cold water through spout for about one minute to remove any debris. Remove any debris from aerator assembly. Shut faucet off and reinstall aerator assembly.

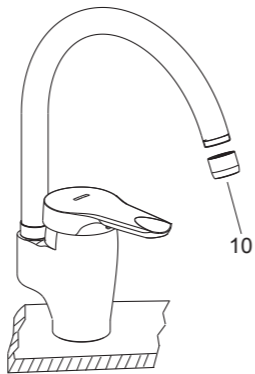

CLEANING INSTRUCTIONS

All Finishes: Clean the finish with mild soap and warm water. Wipe entire surface completely dry with a clean soft cloth. Many cleaners may contain chemicals, such as ammonia, chlorine, toilet cleaner etc. Which could adversely affect the finish and are not recommended for cleaning.

Do not use abrasive cleaners or solvents on Kohler faucets and fittings.

668 SINGLE LEVER KITCHEN FAUCET

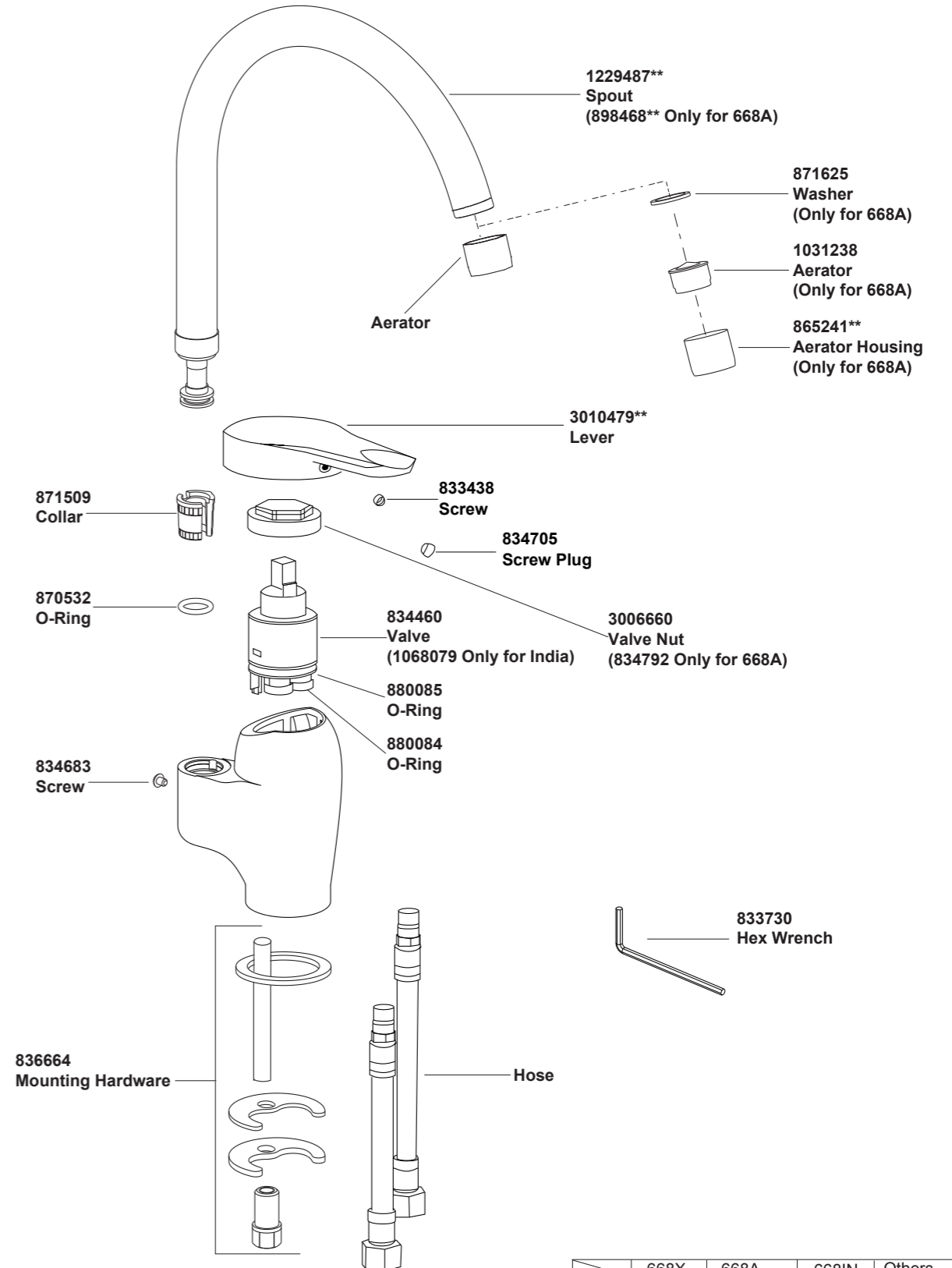

**Color code must be specified when ordering

	668X	668A	668IN	Others
Hose	834754	1054592	1024405	834754
Aerator	837262**	See Above	834769**	834769**