

KOHLER®

BATHTUB GRIP RAILS
浴缸扶手
INSTALLATION INSTRUCTIONS
安装说明书
K-8278T/K-9621T/K-9623T/
K-8598T/K-8599T/K-8645T/K-5791T

HOW TO INSTALL THE GRIP RAIL

如何安装扶手

1. Slip metal washers over bolts as shown. Thread the bolts half way into the anchor nuts pre-installed on the tub.

2. Place the appropriately-shaped gaskets over the bolts.

3. Position the grip rail so that slots line up with bolts. Be sure grip rail is placed between gasket and metal washer.

4. Position the gaskets to match contour of grip rail. Tighten the bolts evenly to secure grip rail making sure gaskets are in line with grip rail.

5. If the grip rail has caps, please snap the caps into each hole.

6. If needed, please trim excess gasket material from around grip rail with a razor blade very carefully.

7. Repeat procedure for other grip rails.
1. 如图所示，将金属垫圈滑入螺栓内，然后将螺栓拧入预先安装在浴缸上的螺母内，拧入程度为一半。

2. 将形状适当的密封垫圈放在螺栓上。

3. 将扶手放置到位，使其槽口与螺栓对直。确保扶手位于密封垫圈与金属垫圈之间。

4. 将密封垫圈放置到位，与扶手的外缘完好配合。均匀地拧紧每个螺栓，将扶手固定完好，确保密封垫圈与扶手完好匹配。

5. 若有装饰盖，请将装饰盖塞进孔中。

6. 如果需要，请用刀片尽量小心地切去扶手周围多余的密封垫圈材料。

7. 重复以上步骤，安装另一扶手。

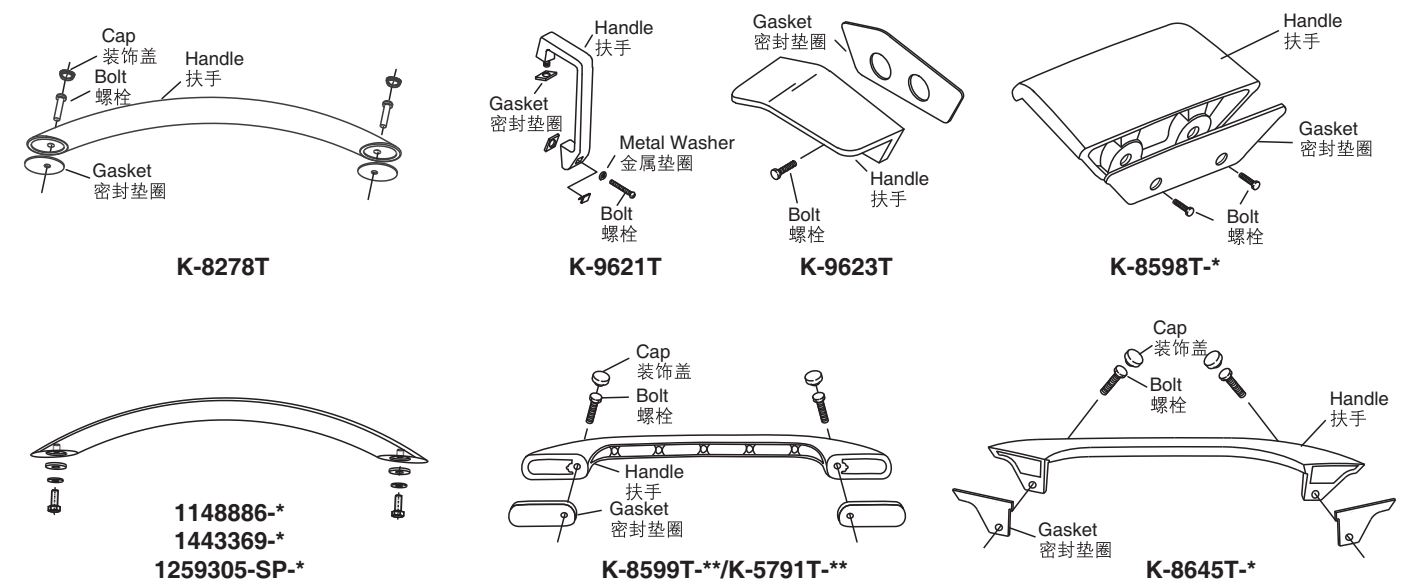

-* include: -*包括:		
-CP-Polished Chrome-抛光镀铬	-AF-French Gold -法兰金	-BN-Brushed Nickel -罗曼银
-BV-Brushed Bronze -罗曼铜	-SN-Polished Nickel -香槟金	-BL-Matte Black -原色黑
-RGD-Rose Gold -玫瑰金	-2MB-Brushed Moderne -摩登金	

SHANGHAI KOHLER LTD., NO.368, MIN LE ROAD,
FENG XIAN DISTRICT, SHANGHAI, CHINA POST CODE: 201419
上海科勒有限公司 上海市奉贤区民乐路368号 邮编: 201419

CARE AND CLEANING

For best results, keep the following in mind when caring for your KOHLER product:

- Use a mild detergent such as liquid dishwashing soap and warm water for cleaning. Do not use abrasive cleaners that may scratch or dull the surface.
- Carefully read the cleaner product label to ensure the cleaner is safe for use on the material.
- Always test your cleaning solution on an inconspicuous area before applying to the entire surface.
- Do not allow cleaners to sit or soak on the surface.
- Wipe surfaces clean and rinse completely with water immediately after cleaner application. Rinse and dry any overspray that lands on nearby surfaces.
- Use a soft, dampened sponge or cloth. Never use an abrasive material such as a brush or scouring pad to clean surfaces.

护理和清洁

为了长久使用，请在护理您的科勒产品时注意以下几点：

- 使用中性清洁剂，例如液体洗洁精和温水进行清洗。请不要使用研磨清洁剂，以免刮划或使表面变钝。
- 请仔细阅读清洁剂说明以确认其能够在产品上安全使用。
- 在大面积使用清洁剂之前，请务必先在不显眼处先试验清洁方式。
- 请不要将产品表面浸泡在清洁剂中。
- 使用清洁剂后，请立即擦拭并用水彻底清洗。清洗并擦干溢溅在周围表面的清洁剂。
- 使用柔软湿润的海绵或清洁布，请勿使用研磨材质，例如刷子和百洁布来清洁表面。