

9033T Bottle Trap

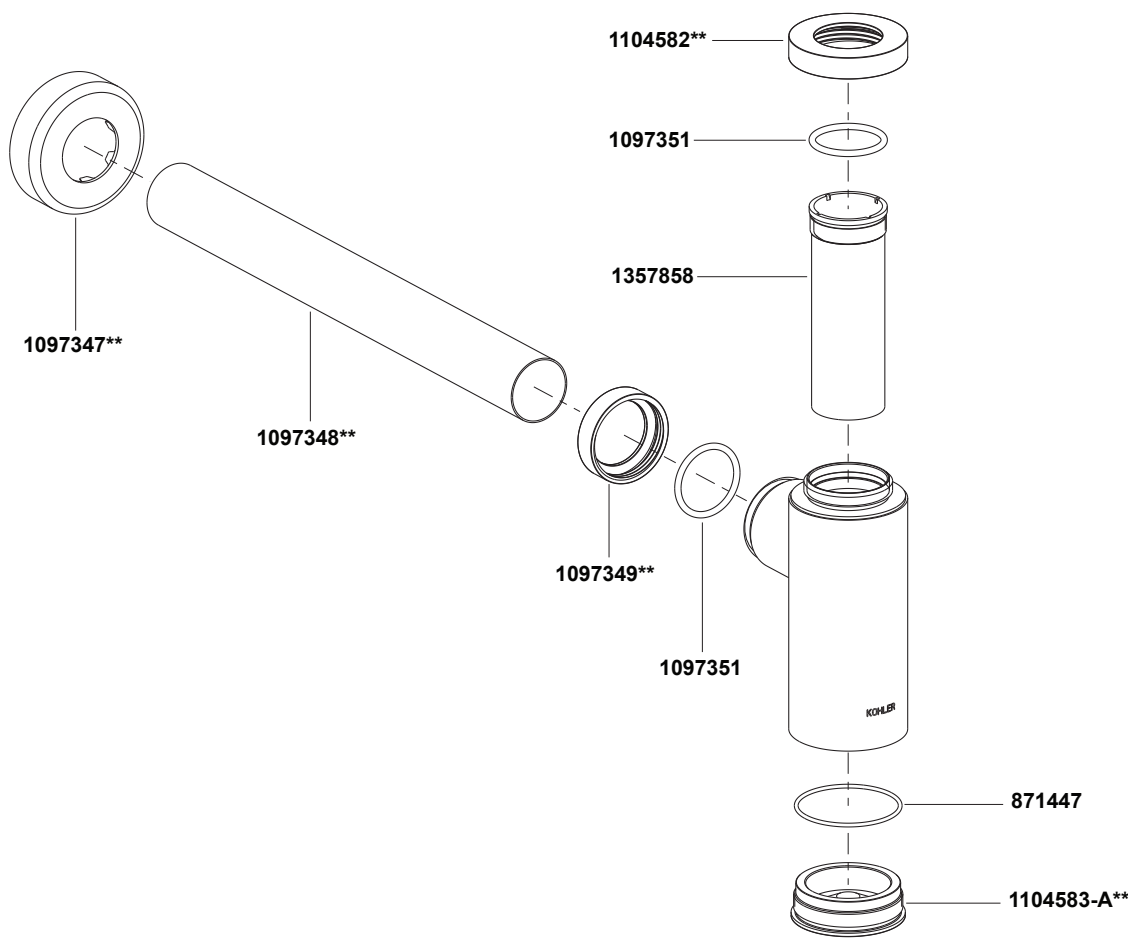

**Color code must be specified when ordering.
NOTE: For all Asia pacific regions (excluding China) add SP (SPxxxxxx**) in front of the part number when ordering.

9033T Bottle Trap

BEFORE YOU BEGIN

All information is based on the latest product information available at the time of publication. Kohler Co. reserves the right to make changes in product characteristics, packaging, or availability at any time without notice.

Please leave these instructions for the consumer. They contain important information.

NOTES:

1. Observe all local plumbing codes.
2. Shut off the main water supply.
3. According to rough-in dimensions, drain stub-out should be prearranged in the wall. Inside diameter of the drain stub-out must be little bigger $\Phi 32\text{mm}$ (recommended $33\sim 36\text{mm}$). It can extend beyond the wall, but no more than 10mm. The pipe of the bottle trap can reach into drain stub-out no less than 25mm.

ROUGH-IN DIMENSIONS

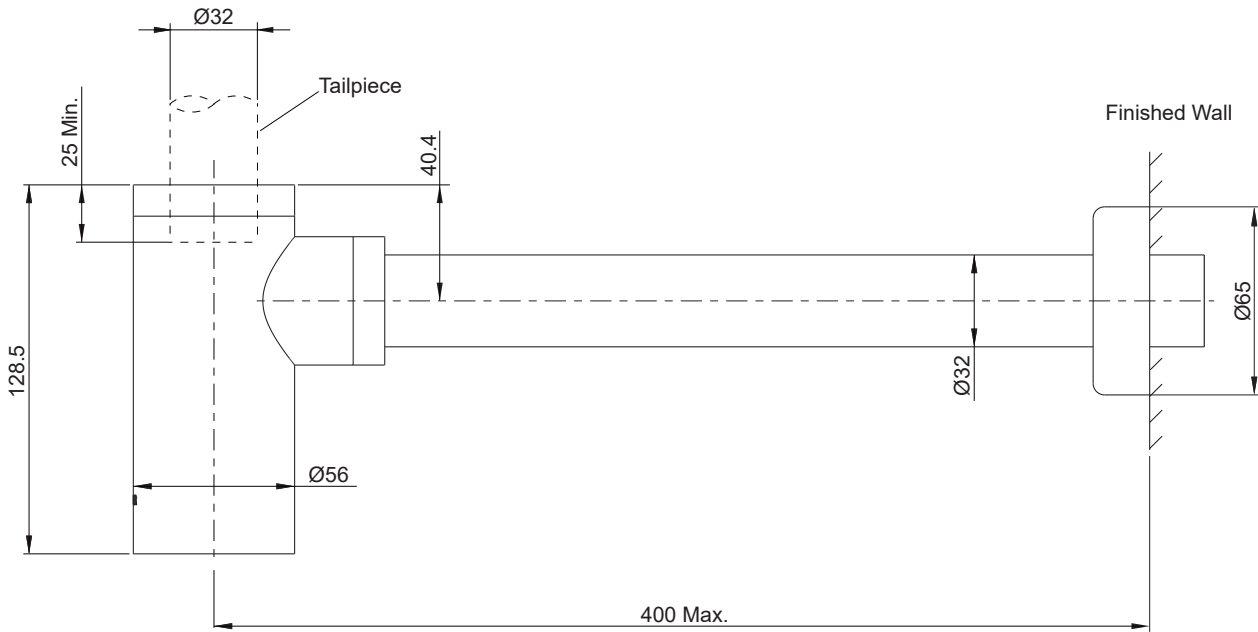

9033T

INSTALLATION

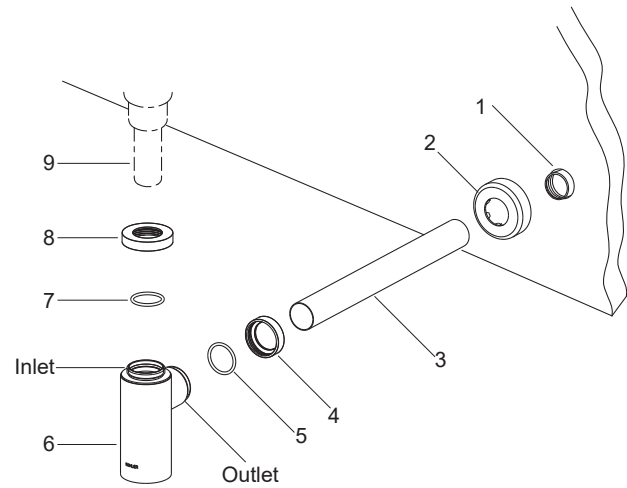

Install the drain to lavatory according to the manufacturer installation instruction.

Remove the inlet nut(8) and O-ring(7) from the bottle trap body(6). With the threads facing down, slide the inlet nut with O-ring onto the tailpiece(9) of drain. Position the bottle trap body around the tailpiece and keep the outlet of the bottle trap facing and aligning with drain stub-out(1). Then hand tighten the inlet nut.

NOTE: Ensure the tailpiece must be inserted at least 25mm inside the inlet nut.

Remove the outlet nut(4) and o-ring(5) from the bottle trap. The length of the pipe(3) should be about 50mm longer than the distance from drain stub-out(1) to the outlet. If more, cut it off as needed. Be careful, not to damage the finish.

Slide the outlet nut and o-ring to one end of pipe, and flange(2) to the other end. Insert the pipe to the bottle trap outlet and drain stub-out. If can't do so, adjust the position of bottle trap. Tighten the inlet nut(8) and outlet nut(4) to secure the bottle trap. Fill up the gap between drain stub-out and pipe with plumber putty or sealants. Remove any excess putty or sealant. Push flange against the finished wall.

NOTE: Ensure the pipe must be inserted at least 25mm inside both the outlet of bottle trap and drain stub-out.

INSTALLATION CHECKOUT

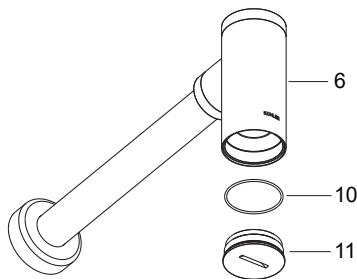

Ensure all coupling nuts are tightened.

Turn on the drain and main water supply. Check for leaks. Repair as required.

Clean Debris in Bottle Trap

Using a flat-blade screwdriver, turn the trap plug(11) counterclockwise until fully removed from the bottle trap body. Set the trap plug with o-ring(10) aside. Clean out any debris that has collected in the bottle trap body(6). Reinstall the trap plug with the o-ring to the bottle trap body.

CLEANING INSTRUCTIONS

All Finishes: Clean the finish with mild soap and warm water. Wipe entire surface completely dry with clean soft cloth. Many cleaners may contain chemicals, such as ammonia, chlorine, toilet cleaner etc, which could adversely affect the finish and are not recommended for cleaning.

Do not use abrasive cleaners or solvents on Kohler faucets and fittings.