



**Thoreau®**  
Bathroom Sink  
**K-2907-1**

**Features**

- Single faucet hole
- Oval basin

**Material**

- KOHLER® enameled cast iron

**Installation**

- Drop-in

**Recommended Products/Accessories**

- K-23726 Drain treatment
- K-23725 Cast iron cleaner



**ADA**

**CSA B651**

**OBC**

**Codes/Standards**

ASME A112.19.1/CSA B45.2

ADA

ICC/ANSI A117.1

CSA B651

OBC

**KOHLER® Enameled Cast Iron  
Kitchen and Bathroom Sink Lifetime  
Limited Warranty**

See website for detailed warranty information.

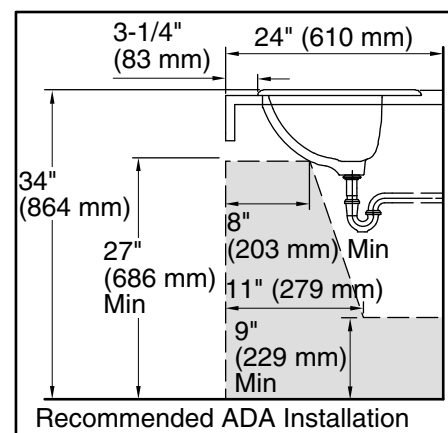
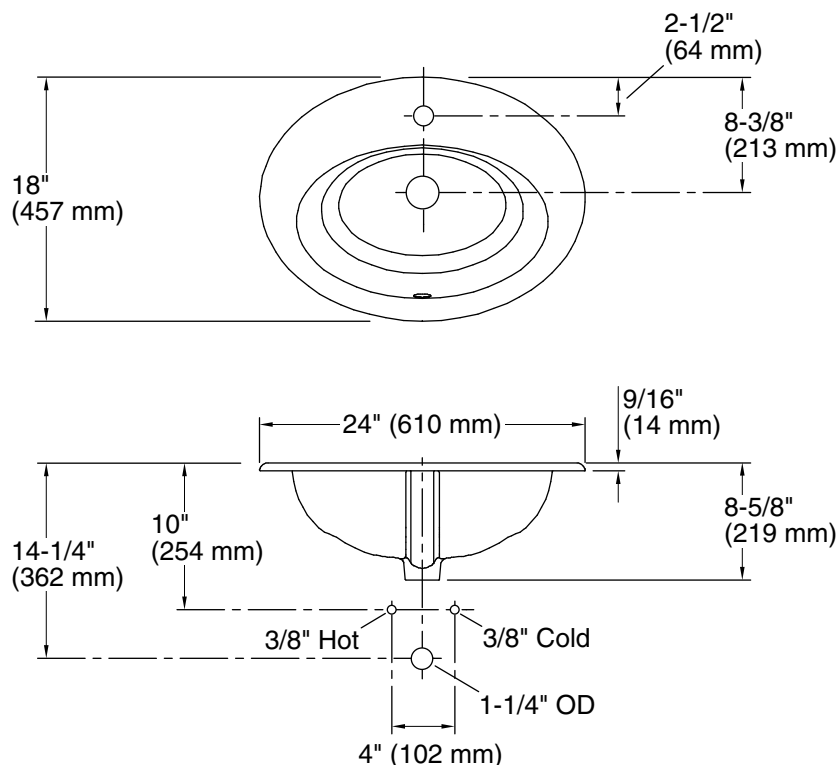

## Technical Information

All product dimensions are nominal.

Basin configuration:	Single Bowl
Bowl area (Only):	Length: 18-9/16" (471 mm) Width: 11-5/16" (287 mm) Bowl depth: 6-13/16" (172 mm)
Number of deck holes:	1
Faucet hole(s):	1-3/8" (35 mm)
Drain hole:	1-11/16" (43 mm)
Template:	114535-7, required, included

## Notes

Install this product according to the installation instructions.

**NOTICE:** Countertop manufacturer or cutter must use the current product template available at [www.kohler.com](http://www.kohler.com), or by calling 1-800-4KOHLER. Kohler Co. is not responsible for cutout errors when the incorrect cutout template is used.

ADA, OBC, CSA B651 compliant when installed to the specific requirements of these regulations.