



Hearthaven®

24" x 28" wall cabinet
K-33541-ASB

Features

- Open shelf offers easy access to storage, while interior shelf provides ample space for extra toilet paper
- Three-way adjustable slow-close door hinges for easy cabinet access
- Finish-matched 10"-deep cabinet interior
- Customize your storage with optional accessories such as floor liners, drawer organizers, and perfectly sized containers (sold separately)

Material

- Solid wood and moisture-resistant MDF
- Painted exterior

Installation

- Easy installation – no special tools required

Required Products/Accessories

K-33542 Cabinet knob



Codes/Standards



EPA TSCA Title VI/CARB P2

KOHLER® One-Year Limited Warranty

See website for detailed warranty information.

Available Colors/Finishes

Color tiles intended for reference only.

Color	Code	Description
	0	White
	1WX	Slate Grey

1-800-4KOHLER (1-800-456-4537)

Kohler Co. reserves the right to make revisions without notice to product specifications.

For the most current Specification Sheet, go to www.kohler.com USA or www.kohler.ca Canada

8-26-2024 21:33 - US/CA

THE BOLD LOOK
OF **KOHLER**®

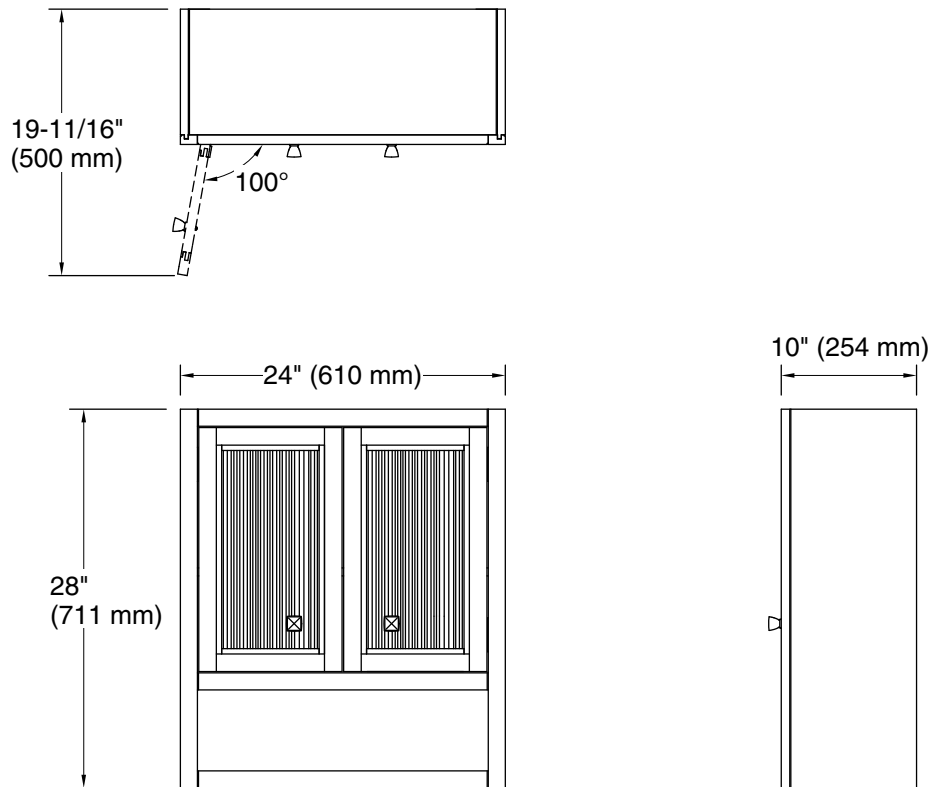

Technical Information

All product dimensions are nominal.

Notes

Install this product according to the installation instructions.