

## Features

- Contemporary design
- Arched spout and spout rotation offer superior clearance for filling pots
- 180° spout rotation
- Two Lever handles offer separate control of hot and cold water
- 4.48 gpm (17.0 lpm) maximum flow rate at 43.5 psi (3.0 bar)

## Material

- Premium metal construction for durability and reliability
- KOHLER finishes resist corrosion and tarnishing

## Installation

- Deck-mount
- Single-hole installation



## Codes/Standards

None Applicable

## KOHLER® India Faucet Limited Warranty

See website for detailed warranty information.

## Available Colors/Finishes

*Color tiles intended for reference only.*

Color	Code	Description
	CP	Polished Chrome

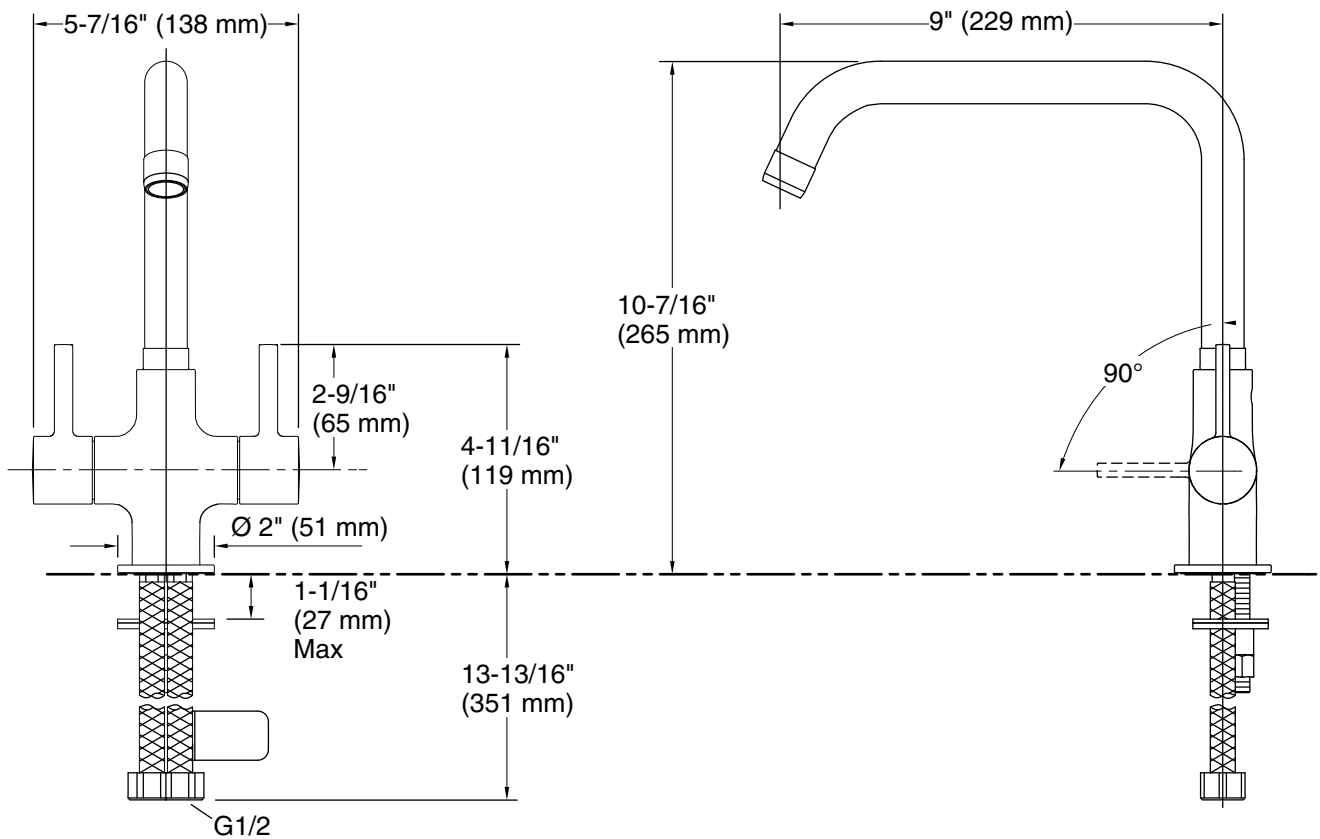

## Technical Information

All product dimensions are nominal.

## Notes

Install this product according to the installation instructions.