



Stoneridge®

48" x 36" corner shower base, left drain
K-44144

Features

- Perpendicular double-threshold design allows customization of shower door and stationary glass panel location
- Honed surface provides improved slip resistance (tested in accordance with DIN EN 16165:2023-02 Annex A)
- Two-sided integral flange
- Color-matched drain cover
- Complements traditional and contemporary bathroom designs
- Allows for quick and easy mortarless installation
- Contains more than 60% natural stone

Material

- KOHLER® engineered stone

Installation

- Corner
- Left drain
- For residential and hospitality use

Recommended Products/Accessories

K-9132 Shower Drain



Codes/Standards

CSA B45.5/IAPMO Z124
ASTM E162
ASTM E662

KOHLER® Plastic Baths and Shower Bases Lifetime Limited Warranty

See website for detailed warranty information.

Available Colors/Finishes

Color tiles intended for reference only.

Color	Code	Description
-------	------	-------------

	HW1	Honed White
---	-----	-------------



Stoneridge®
48" x 36" corner shower base, left drain
K-44144

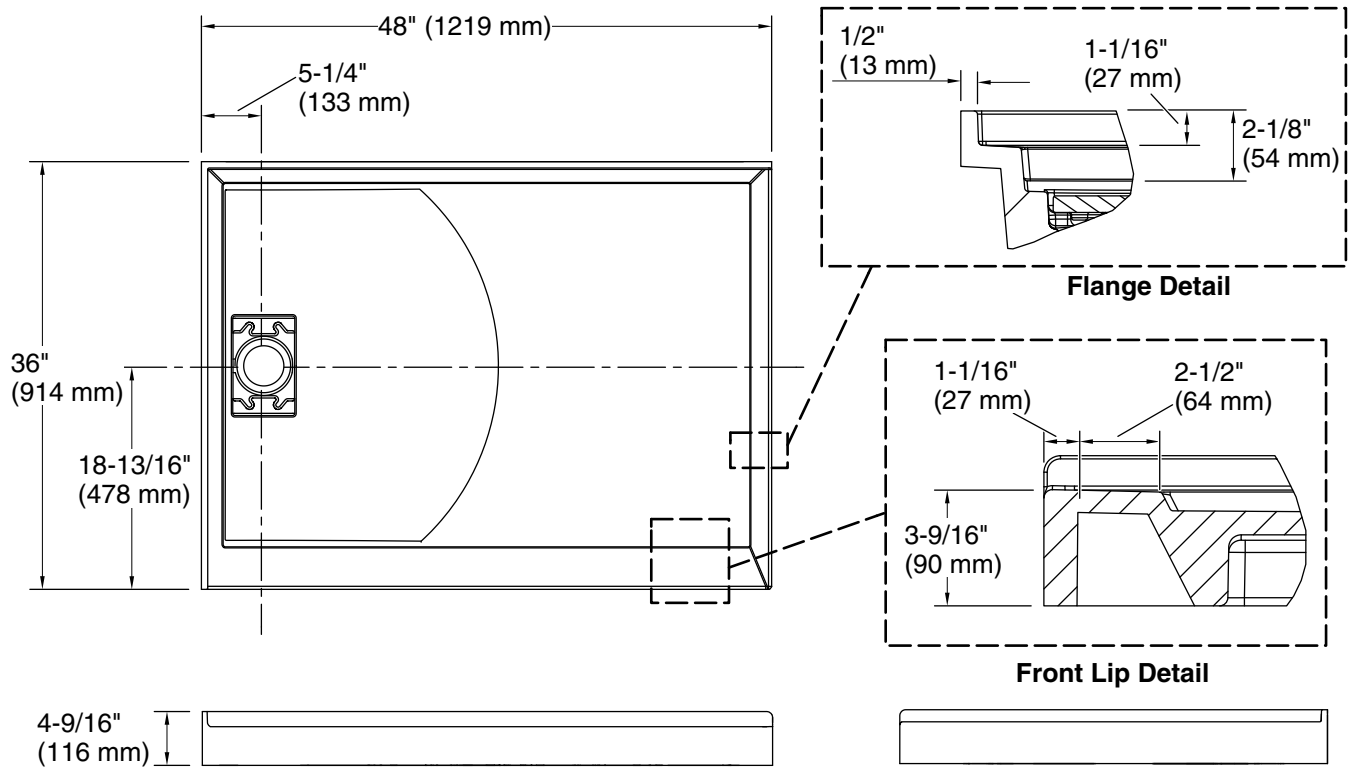

Technical Information

All product dimensions are nominal.

Drain location: Left

Weight: 170 lbs (77.1 kg)

Notes

Measure your actual product for rough-in details.

Install this product according to the installation instructions.