

**Features**

- Fixture-mount design
- Includes a 30-year hybrid energy cell
- Retrofit models require a control stop and vacuum breaker

**Material**

- Brass

**Technology**

- Electronic infrared sensor with Tripoint® technology for accurate activation
- Slow-closing piston technology

**Installation**

- Intended for toilet installations with 1-1/2" spud coupling connection

**ADA****CSA B651****OBC****Codes/Standards**

ASME A112.18.1/CSA B125.1

CSA B125.3

CSA B64

ASSE 1037/ASME A112.1037/CSA B125.37

ADA

ICC/ANSI A117.1

CSA B651

OBC

**KOHLER® One-Year Limited  
Warranty**

See website for detailed warranty information.

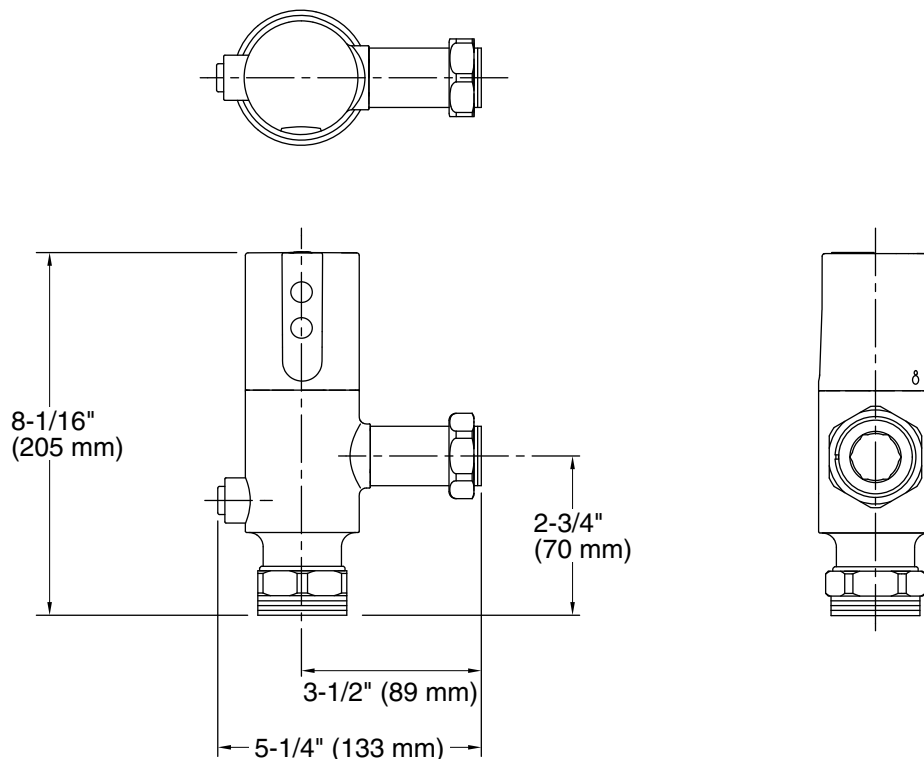

## Technical Information

All product dimensions are nominal.

Power source: Hybrid Energy Cell, included

## Pressure/fixture Supply Requirements

Fixture pressure 80 psi (551.6 kPa)

max (static):

Min flowing 25 psi (172.4 kPa)

pressure:

Min flow rate: 25 gpm (94.6 lpm)

## Notes

Install this product according to the installation instructions.

ADA, OBC, CSA B651 compliant when installed to the specific requirements of these regulations.