

Features

- Advanced spray engine with easy-to-clean sprayface provides three alternate spray experiences: wide coverage, medium coverage, and concentrated
- Water-saving spray option pauses water flow
- Ergonomic sprayhead pivots to allow precise adjustment for targeted hydromassage
- MasterClean™ sprayface features an easy-to-clean surface that withstands mineral buildup and maximizes spray performance
- 1.75 gpm (6.6 lpm) handshower flow rate
- Includes K-9514 MasterShower® 60" (1524 mm) metal shower hose, slidebar and trim, supply elbow, and vacuum breaker
- Coordinates with Forté® faucets, accessories, and showering components to complete your bathroom
- This product can help a building earn Water Efficiency points in LEED® Green Building Rating System
- ADA-compliant nonpositive shutoff
- Features a nonpositive shutoff: water-saving pause mode to temporarily reduce water flow

Material

- KOHLER finishes resist corrosion and tarnishing

Installation

- Wall-mount

Recommended Replacements

- This product is replaced by K-22177-G 30" four-function handshower kit, 1.75 gpm.

Recommended Products/Accessories

- K-30646 Showerhead filter
- K-30647 Showerhead replacement filter, two-pack



ADA

OBC

Codes/Standards

ASME A112.18.1/CSA B125.1
DOE - Energy Policy Act 1992
EPA WaterSense®
California Energy Commission (CEC)
ADA
ICC/ANSI A117.1
OBC

KOHLER® Faucet Lifetime Limited Warranty

See website for detailed warranty information.

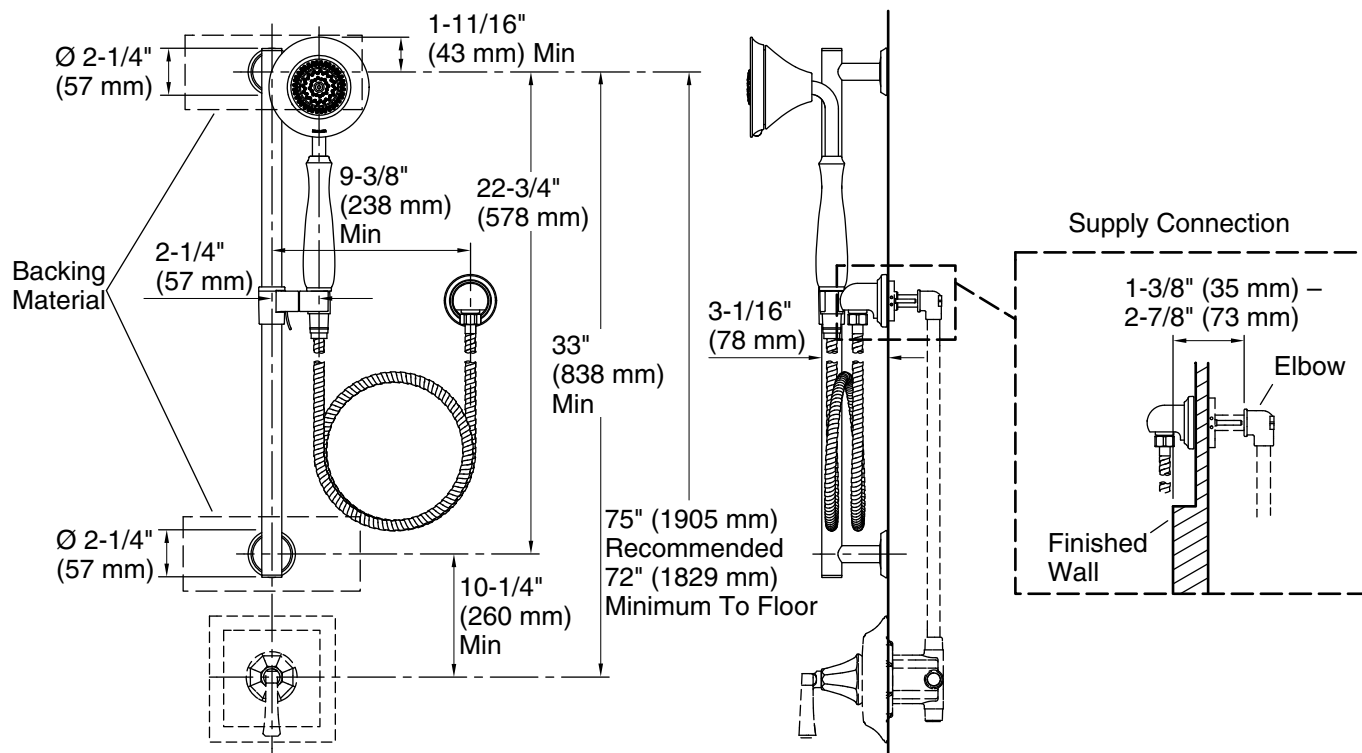

NOTE: Valve trim illustrated for dimensioning only, not included in the product.

Technical Information

All product dimensions are nominal.

Handshower rated max flow: 1.75 gal/min (6.6 l/min)

Notes

Install this product according to the installation guide.

IMPORTANT! The sidebar must be mounted to stud framing at both the top and bottom mounting locations. Do not use or depend on plastic wall anchors to attach the sidebar.

Plumbing codes may require that an atmospheric vacuum breaker be installed in-line to handshowers. Consult with local codes.

ADA, OBC compliant when installed to the specific requirements of these regulations.