

Features

- Ribbon spout
- 8" (203 mm) nondiverter bath spout with G 1/2 (13 mm) connection
- 8-5/16" (211 mm) spout height
- Laminar flow
- 16 gpm (61 lpm) maximum flow rate at 45 psi (3.1 bar)
- For use with Components™ Lever, Oyl, or Industrial faucet handles (sold separately)
- Coordinates with Components faucets, accessories, and showering components to complete your bathroom

Material

- Premium brass construction for durability and reliability
- KOHLER finishes resist corrosion and tarnishing

Installation

- Deck-mount



Codes/Standards

None Applicable

See website for detailed warranty information.

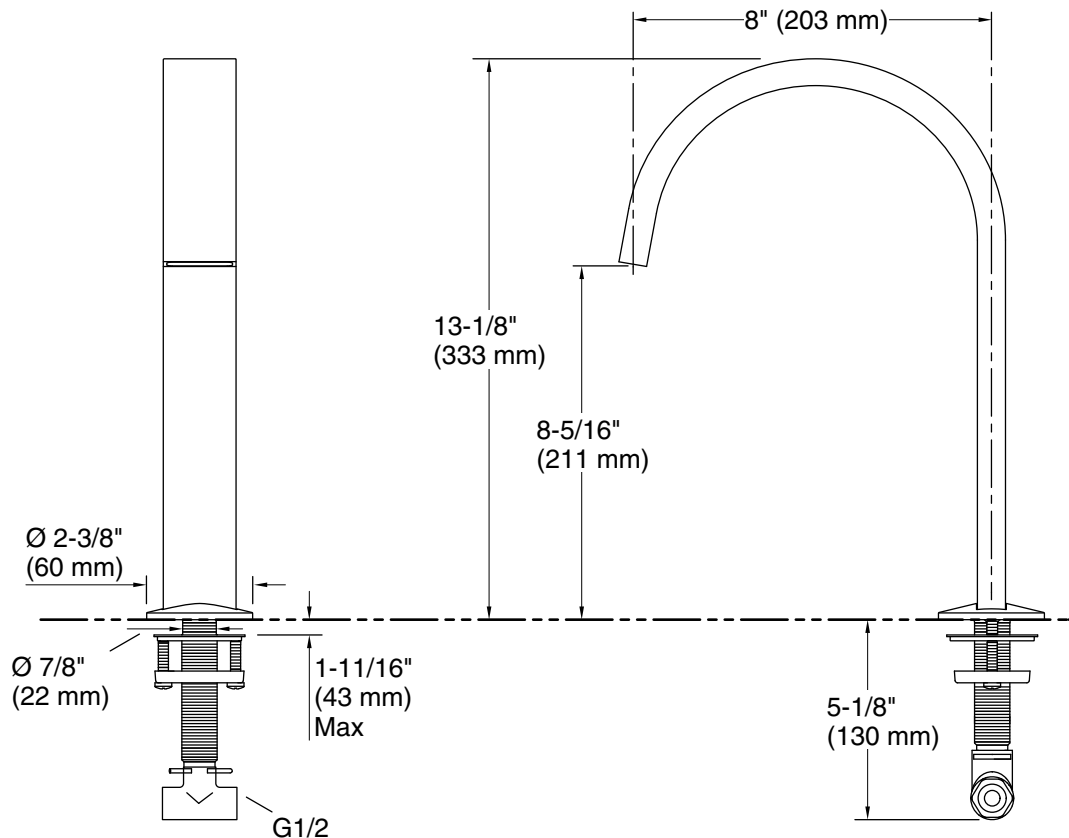

Technical Information

All product dimensions are nominal.

Faucet flow rate: 1.2 gal/min (4.5 l/min)

Spout:

Spout reach: 8" (203 mm)

Notes

Install this product according to the installation instructions.