



## Components™

406 mm double towel arm  
**K-78379T**

### Features

- 16" (406 mm) double towel arm
- Open-ended design for easy access
- Coordinates with Components faucets, accessories, and showering components to complete your bathroom

### Material

- Premium material construction for durability and reliability

### Installation

- Installation hardware included
- Wall-mount



### Codes/Standards

None Applicable

See website for detailed warranty information.

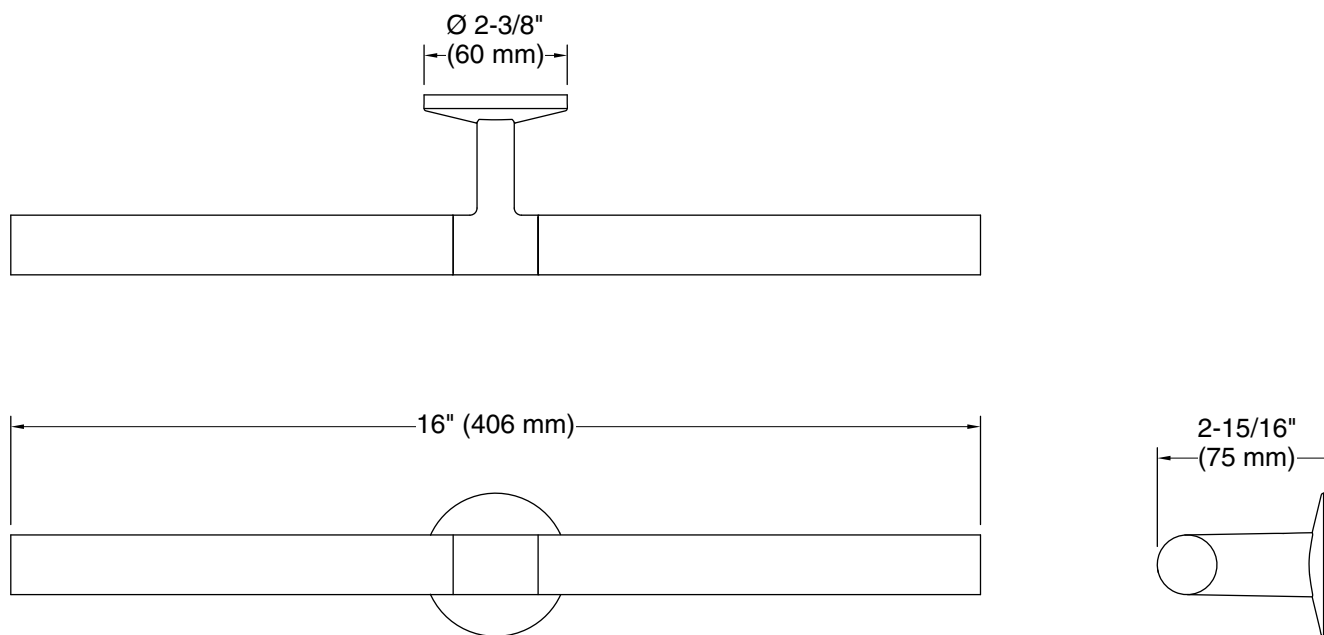

### Technical Information

All product dimensions are nominal.

Material: Brass, Zinc

### Notes

Install this product according to the installation instructions.

**CAUTION:** Risk of personal injury. Do not install these products in any area where they are likely to be used inadvertently as a grab bar or support bar. These products are not designed or intended for use as a grab bar or support bar.