



## Components™

Covered double toilet paper holder  
**K-78384T**

### Features

- Open-ended holder makes changing toilet paper quick and simple
- Storage tray is convenient for holding personal items
- Holds two rolls of toilet paper
- Coordinates with Components faucets, accessories, and showering components to complete your bathroom

### Material

- Premium material construction for durability and reliability

### Installation

- Installation hardware and template included
- Wall-mount



### Codes/Standards

None Applicable

See website for detailed warranty information.



# Components™

Covered double toilet paper holder  
**K-78384T**

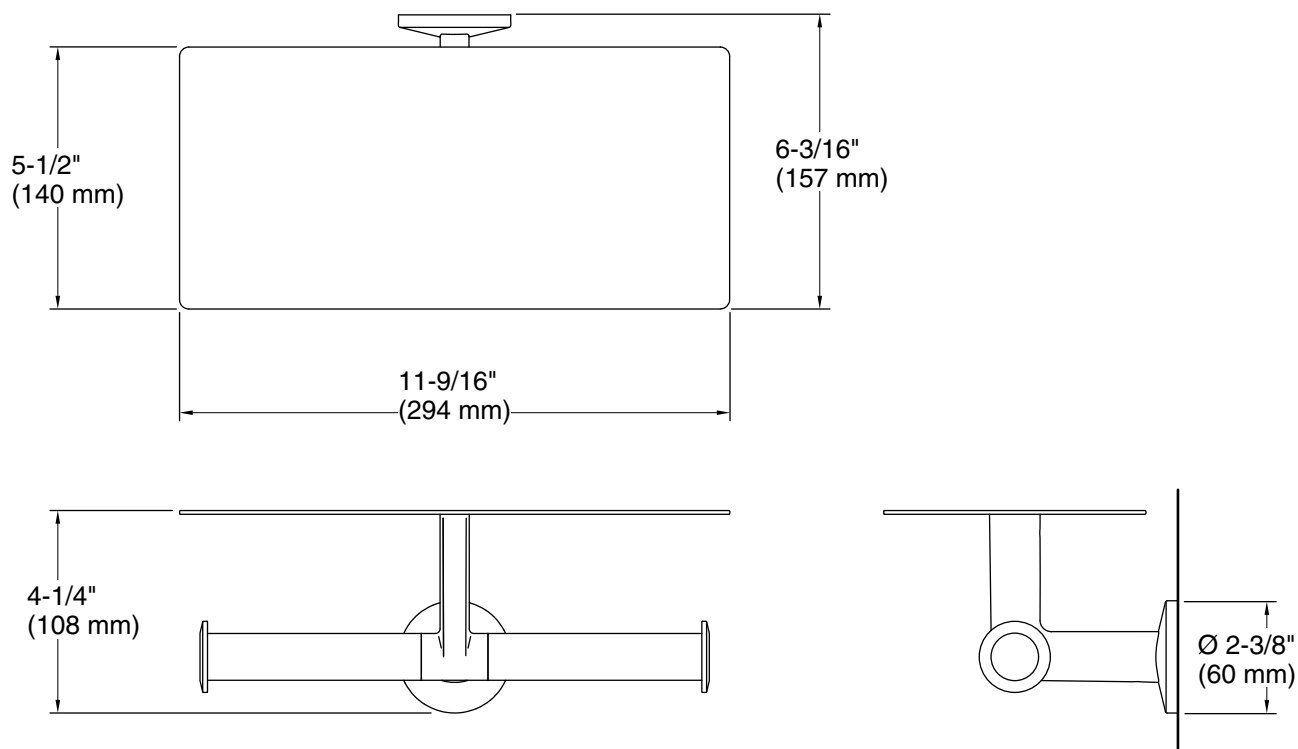

## Technical Information

All product dimensions are nominal.

Material: Brass, Zinc, Stainless Steel

## Notes

Install this product according to the installation instructions.