



Kathryn®
48" x 36" single-threshold shower base
K-9025

Features

- Low-threshold design for easy entry and exit
- Safeguard® slip-resistant surface provides excellent traction underfoot
- Single threshold for three-wall installation
- Coordinates with other products in the Kathryn collection

Material

- KOHLER® enameled cast iron

Installation

- Center drain

Recommended Products/Accessories

K-9132 Shower Drain
K-706008-D3 Frameless Sliding Shower Door
K-706008-L Frameless Sliding Shower Door
K-706014-D3 Frameless Sliding Shower Door
K-706014-L Frameless Sliding Shower Door
K-5557 steam generator control kit
K-23726 Drain treatment
K-23725 Cast iron cleaner



Codes/Standards

ASME A112.19.1/CSA B45.2
ASTM F462

**KOHLER® Enameled Cast Iron Bath
and Shower Base Lifetime Limited
Warranty**

See website for detailed warranty information.

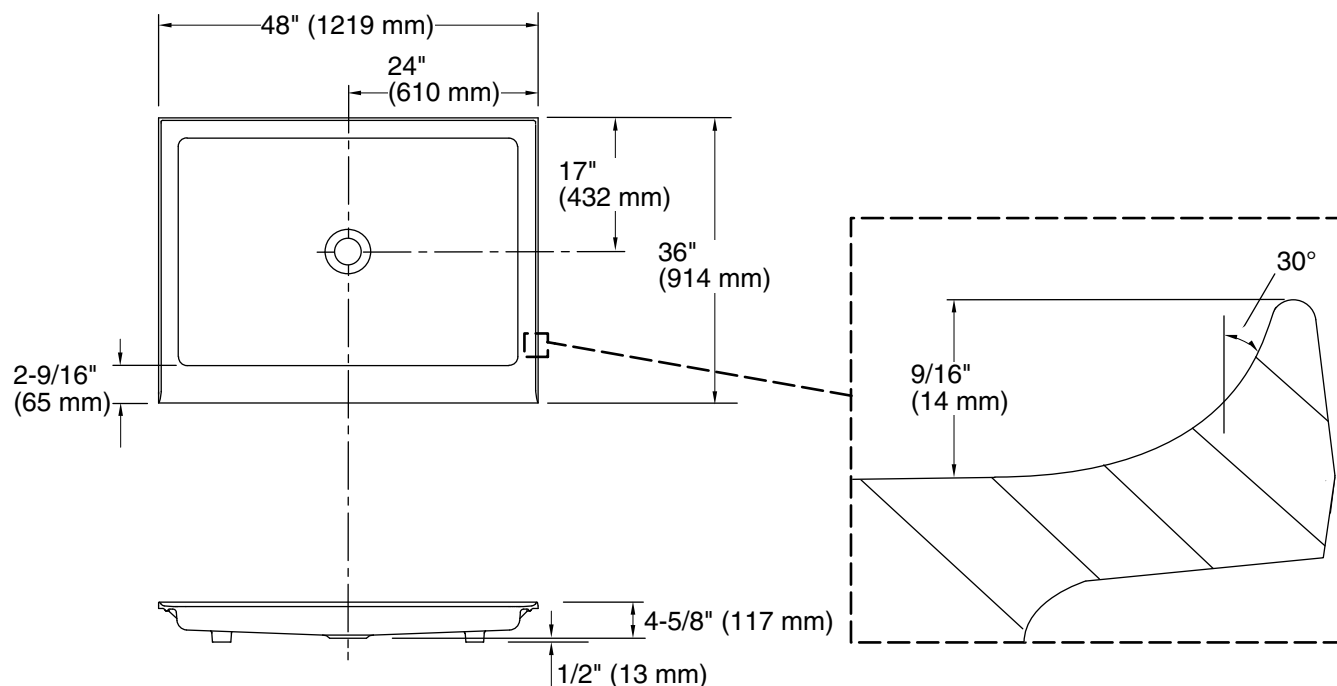

Technical Information

All product dimensions are nominal.

Drain location: Center

Weight: 175 lbs (79.4 kg)

Minimum floor load: 20 lbs/ft² (97.6 kg/m²)

Notes

Measure your actual product for rough-in details.

Install this product according to the installation instructions.

The dimensions are applicable for this product only and should not be used to fabricate substitute bases for shower enclosures.

KOHLER steam generator/control kit is designed for use with this product. Kohler Co. shall not be responsible for problems encountered due to the installation and use of other manufacturer's steam generators.