



Decree® All-In-One

33" top-/undermount single-bowl kitchen sink
K-R39830-1PC

Features

- 36" (914 mm) minimum base cabinet width
- Single bowl
- 9" (229 mm) depth provides generous workspace
- Rear drain placement increases cabinet storage space underneath sink
- Bowl slopes toward drain to minimize water pooling
- Single faucet hole
- Three-function pull-down sprayhead with touch control allows you to switch between aerated stream, Sweep® spray, and SoftRinse™ spray
- High-arch spout offers vertical clearance for tall cookware and pitchers
- Box includes: Sink, assembled Vibrant Stainless faucet, sink rack, drain with strainer, cutout template, installation hardware

Material

- Premium 18-gauge stainless steel

Installation

- Top-mount or undermount
- Flexible supply lines and quick-connect fittings simplify installation

Recommended Products/Accessories

K-6644 Sink rack for Vault™ and Strive® kitchen sinks
K-8801 Sink drain and strainer with tailpiece
K-8799 Sink drain and strainer basket
K-23726 Drain treatment
K-23729 Stainless steel cleaner

Optional Products/Accessories

K-6429 Utility Rack
K-6667 Wood Cutting Board

Included Components

1130570 Hardware Kit, Self-Rimming
K-6644 Sink rack for Vault™ and Strive® kitchen sinks
7400 Stainless Steel Sink Drain and Strainer
K-REC31548 Pull-down kitchen sink faucet with three-function sprayhead



Codes/Standards

ASME A112.19.3/CSA B45.4
ASME A112.18.1/CSA B125.1
NSF/ANSI/CAN 61
NSF/ANSI/CAN 372
DOE - Energy Policy Act 1992
California Energy Commission (CEC)

KOHLER® Stainless Steel Sinks Lifetime Limited Warranty

See website for detailed warranty information.



Decree® All-In-One
33" top-/undermount single-bowl kitchen sink
K-R39830-1PC

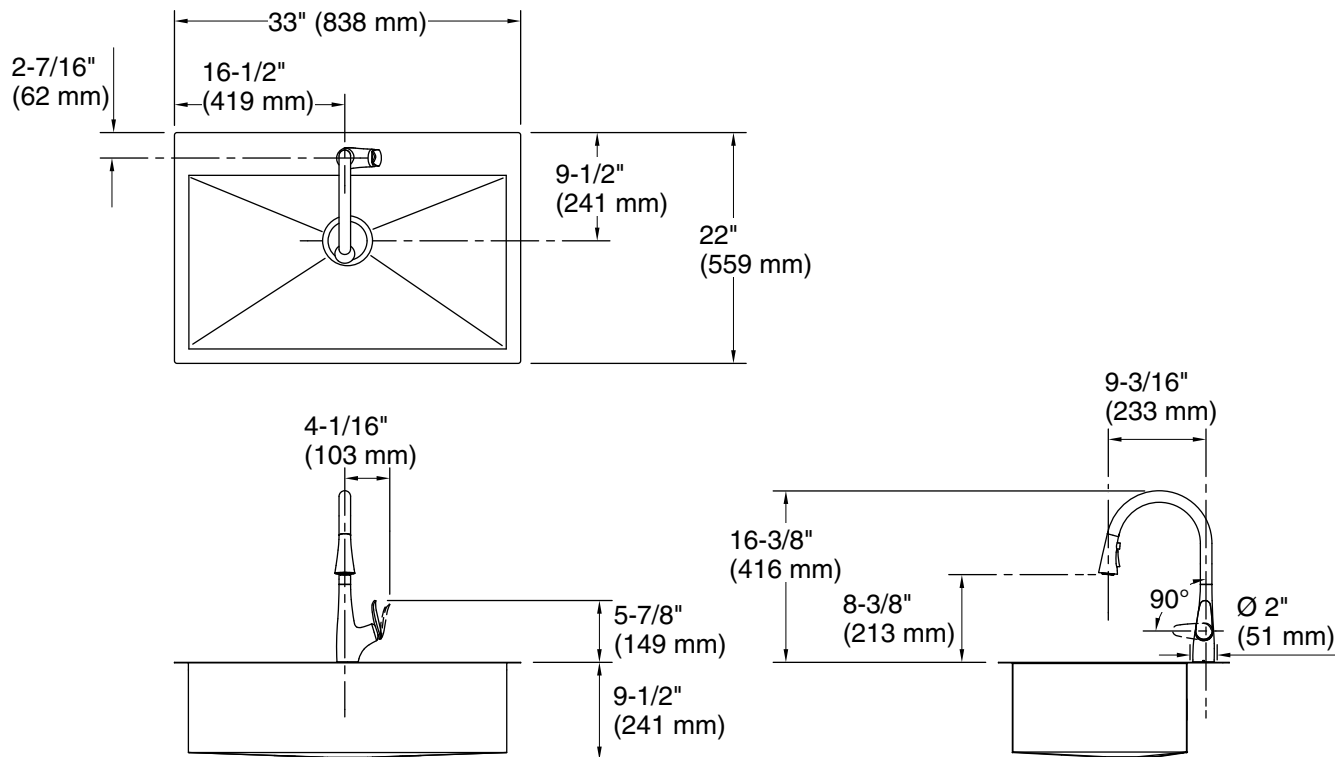

Technical Information

All product dimensions are nominal.

Basin configuration: Single Bowl

Min. base cabinet width: 36" (914 mm)

Bowl area (Basin #1): Length: 30-1/4" (768 mm)
Width: 16-9/16" (421 mm)
Water depth: 9" (229 mm)

Number of deck holes: 1

Faucet hole(s): 1-7/16" (37 mm)

Drain hole: 3-3/4" (94 mm)

Template: Top-mount/Undermount, 1130821-7, required, included

Notes

Install this product according to the installation instructions.