

**Features**

- Includes faceplate with handle, shower arm with flange and showerhead
- A single handle controls both on/off activation and temperature setting
- Integrated push-button diverter
- Includes single-function 2.5 gpm (9.5 lpm) showerhead with Katalyst® air-induction technology
- MasterClean™ sprayface features an easy-to-clean surface that withstands mineral buildup and maximizes spray performance
- 5-3/4" Spout
- Trim only, requires valve to complete installation
- Complements Finial faucets and accessories

**Material**

- Premium material construction with metal handle ensures reliability and durability
- KOHLER finishes resist corrosion and tarnishing

**Required Products/Accessories**

K-11748 Series Rite-Temp® Valves

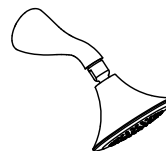
**Codes/Standards**

ASME A112.18.1/CSA B125.1

DOE - Energy Policy Act 1992

**KOHLER® Faucet Lifetime Limited Warranty**

See website for detailed warranty information.

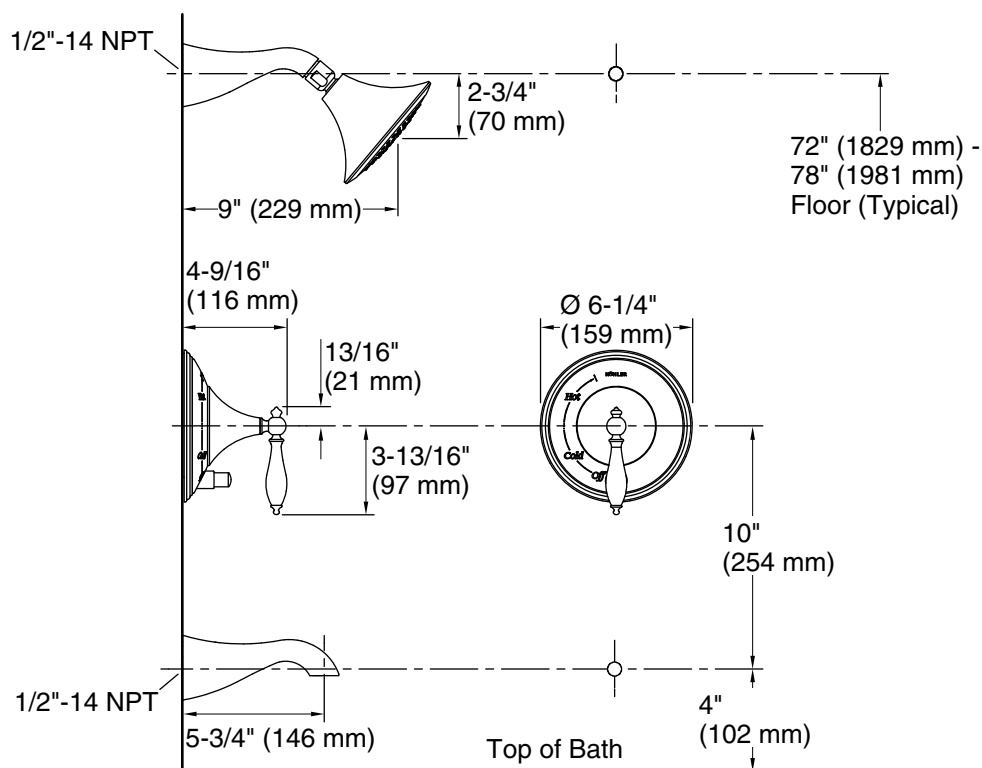

### Technical Information

All product dimensions are nominal.

Shower/Rainhead rated max flow: 2.5 gal/min (9.5 l/min)

### Notes

Install this product according to the installation instructions.

Avoid cross-flow conditions. Do not install shut-off device on either valve outlet.

Install straight pipe or tube drop of 7" (178 mm) to 18" (457 mm) with single elbow between the valve and wall-mount spout.