

**NOTES:**

- DIMENSIONS IN [ ] ARE INCHES.
- FINISH: ANSI 49 GRAY.
- REFER TO OPERATOR'S MANUAL PRIOR TO INSTALLATION AND OPERATION OF UNIT.
- POWER CABLES AND CONTROL WIRING MUST BE RUN IN METAL CONDUIT
- APPROXIMATE WEIGHT: 59 Kg (130 LBS.)
- SERVICE DISCONNECT BREAKER IS 400A, 80% REATED. CONTINUOUS LOAD CURRENT IS NOT TO EXCEED 80% OF BREAKER RATING.

MPAC 500  
400A 240V  
SERVICE ENTRANCE  
NEMA 3R

REV	DATE	ON COMPOSITE DWGS, SEE PART NO. FOR REVISION LEVEL	BY
-	2-19-21	NEW DRAWING [CT210077]	ZHK
A	3-10-21	SEE SHEET 2 [CT210709]	ZHK

APPROVALS	DATE
DRAWN ZHK	2-12-21
CHECKED MTL	2-12-21
APPROVED MTL	2-12-21

**UNLESS OTHERWISE SPECIFIED -**  
1) DIMENSIONS ARE IN MILLIMETERS  
2) TOLERANCES ARE:  
X.XX ± 0.25  
X.X ± 1.0  
X ± 1.5  
ANGLES ± 0° 30' MAX.

**THIRD ANGLE PROJECTION**

**COHLER CO. METRIC PRO-E**  
POWER SYSTEMS, KOHLER, WI 53044 U.S.A.  
THIS DRAWING IN DESIGN AND DETAIL IS KOHLER CO. PROPERTY AND MUST NOT BE USED EXCEPT IN CONNECTION WITH KOHLER CO. WORK. ALL RIGHTS OF DESIGN OR INVENTION ARE RESERVED.

**TITLE: DIMENSION PRINT - ATS, RDT 400A SE**

SCALE: 0.20 CAD NO. SHEET 1 of 2  
DWG NO.: **ADV-9767**

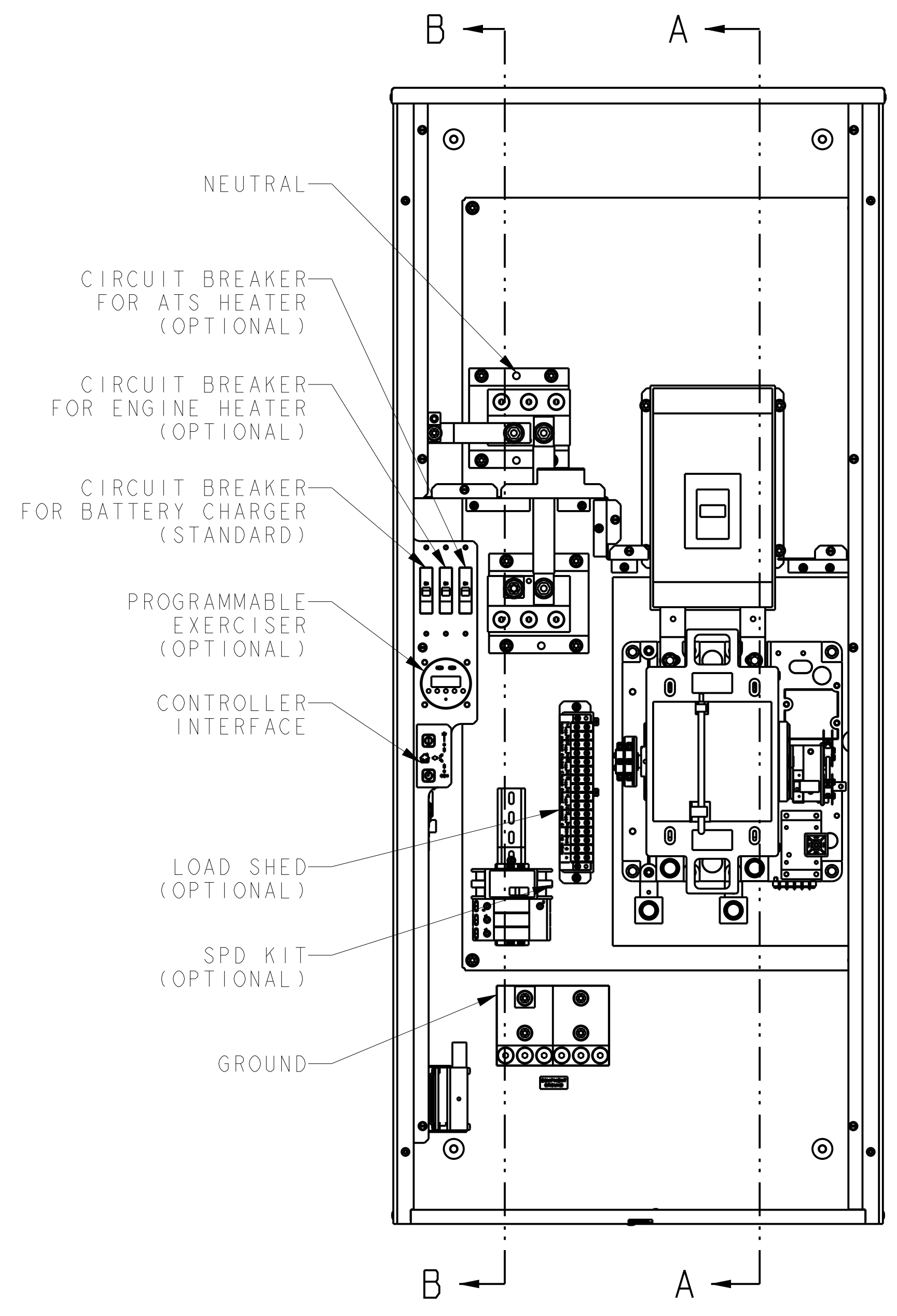

COVER & INNER PANELS REMOVED TO SHOW DETAIL

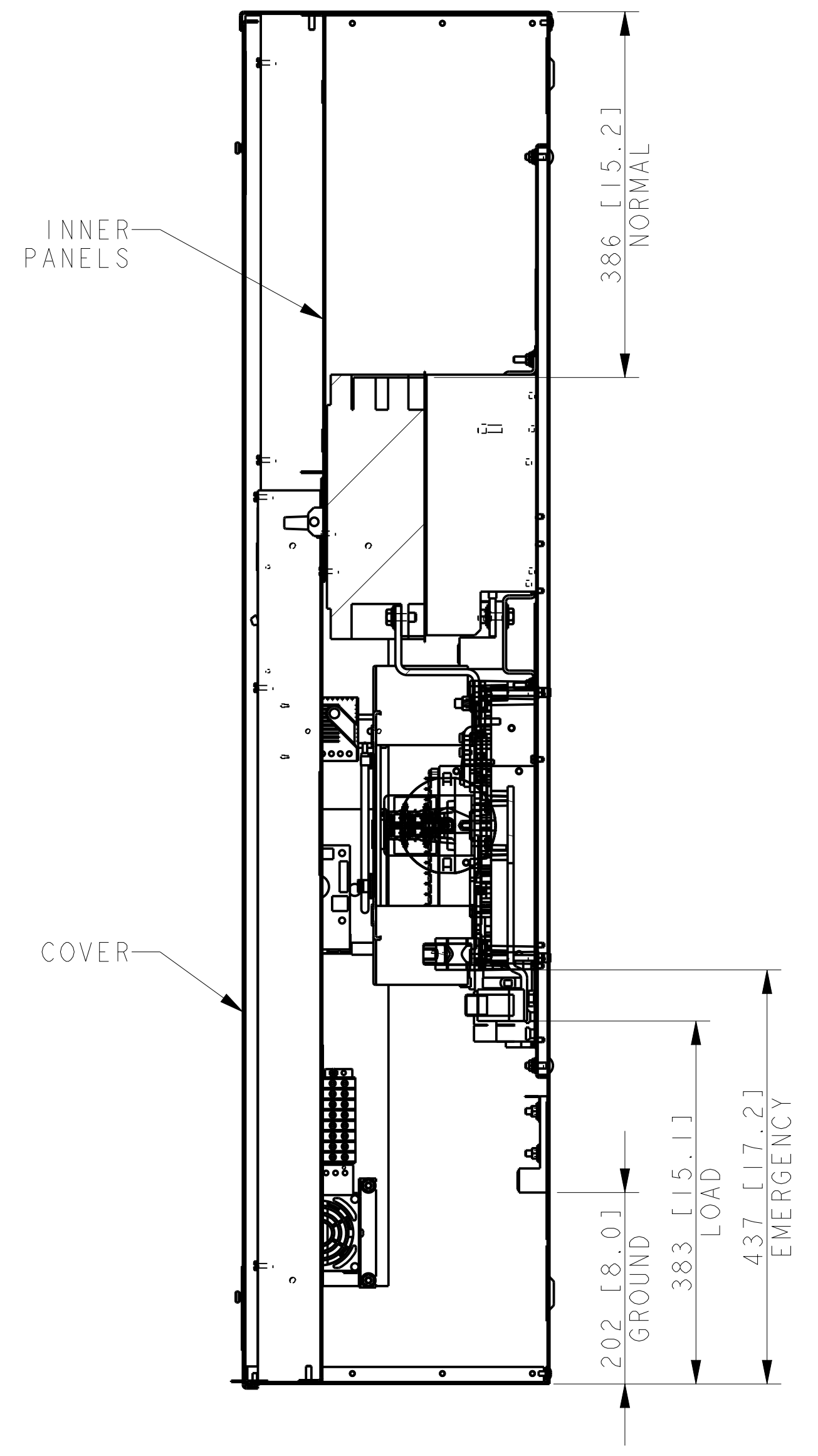

SECTION A-A

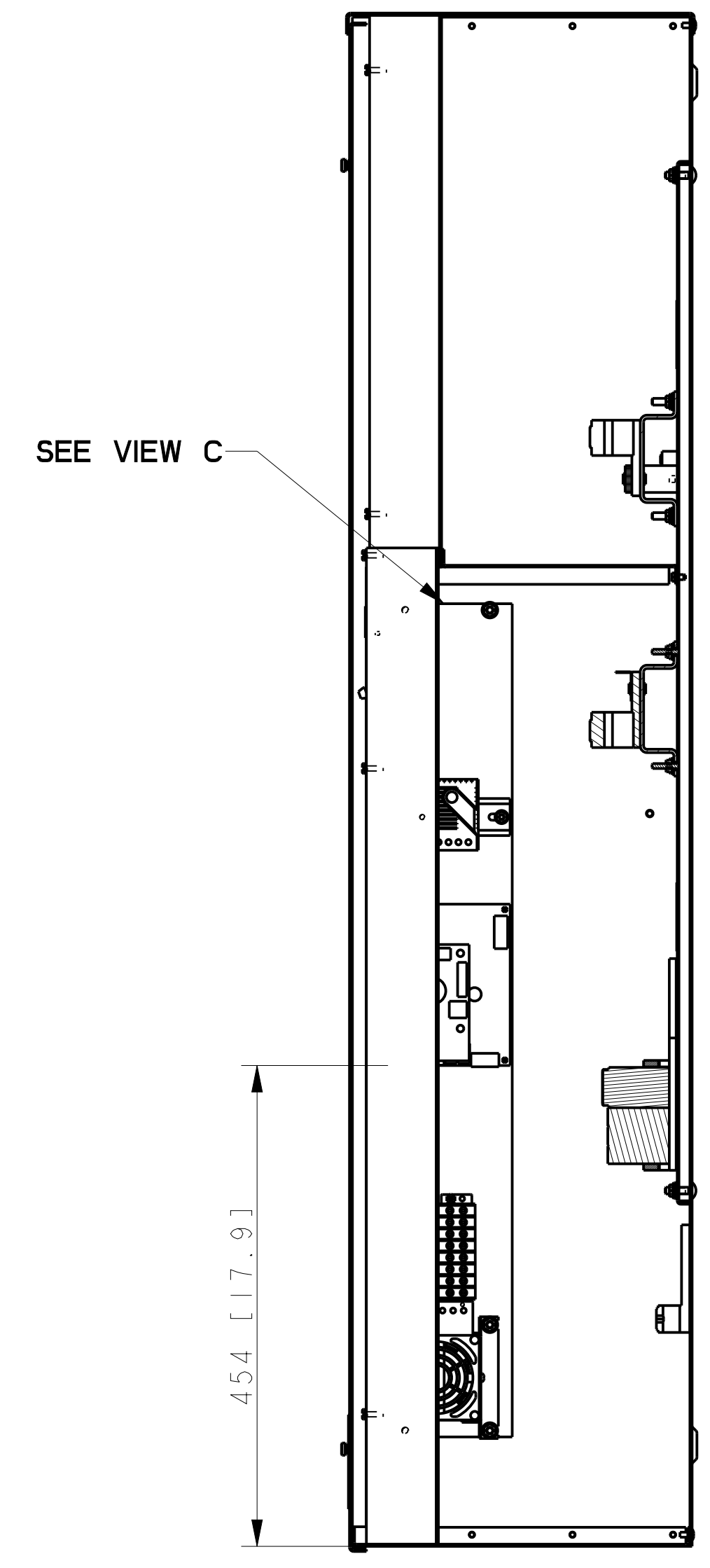

SECTION B-B

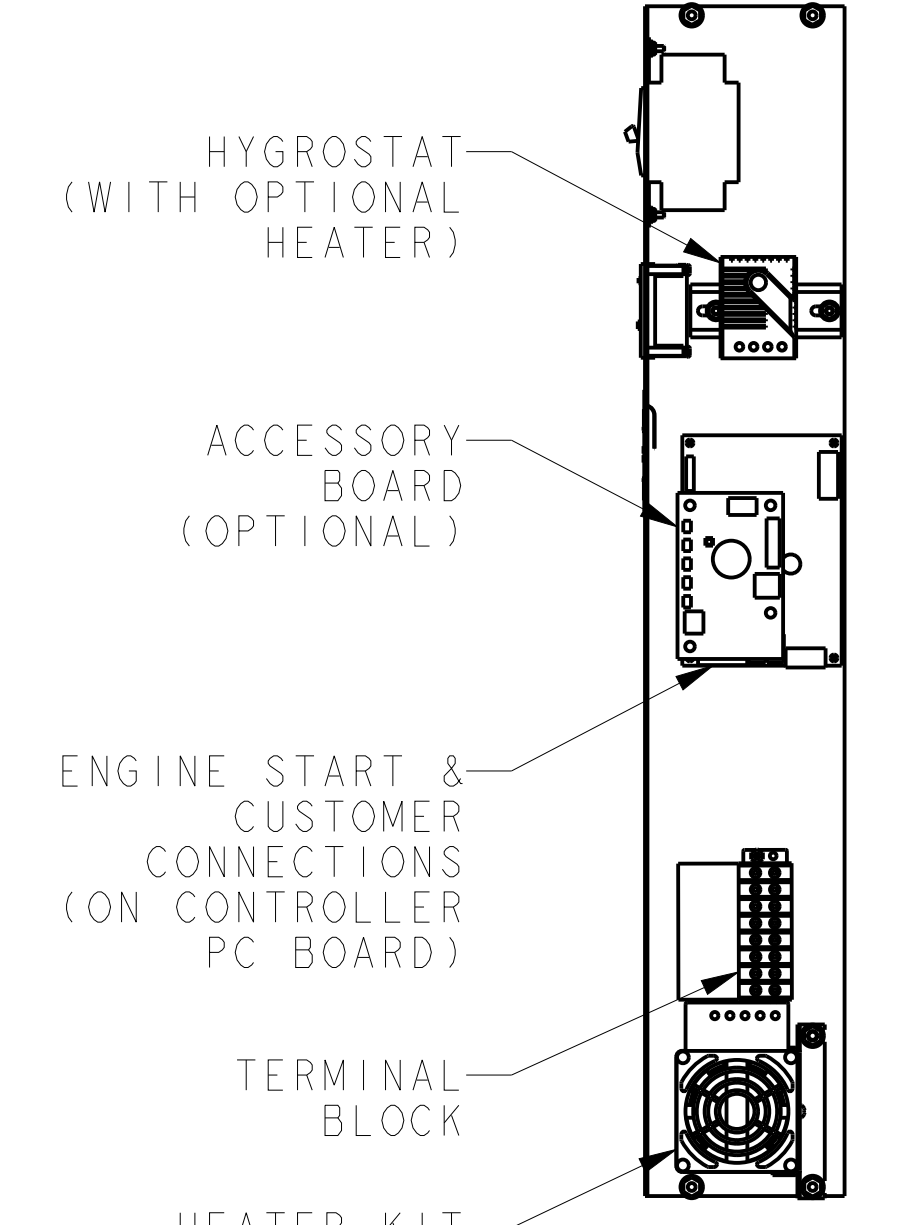

VIEW C

A: SCREW TYPE TERMINALS FOR EXTERNAL POWER CONNECTION

SWITCH RATING (AMPS)	RANGE OF AL-CU WIRE SIZES			
	NORMAL (PER PHASE)	EMERGENCY & LOAD (PER PHASE)	NEUTRAL	GROUND
400	(2) 1 AWG TO 250 KCMIL (1) 1 AWG TO 600 KCMIL	(2) 1/0 TO 250 KCMIL OR (1) 4 AWG TO 600 KCMIL	(12) 1/0 TO 250 KCMIL OR (6) 4 AWG TO 600 KCMIL	(6) #6 TO 3/0 AWG
TORQUE	UP TO 250 KCMIL 275 lbf-in (31.1 Nm) 300 TO 600 KCMIL 500 lbf-in (56.5 Nm)	UP TO 250 KCMIL 275 lbf-in (31.1 Nm) 300 TO 600 KCMIL 500 lbf-in (56.5 Nm)	UP TO 250 KCMIL 275 lbf-in (31.1 Nm) 300 TO 600 KCMIL 500 lbf-in (56.5 Nm)	275 lbf-in (31.1 Nm)

MPAC 500  
400A 240V  
SERVICE ENTRANCE  
NEMA 3R

REV	DATE	ON COMPOSITE DWGS, SEE PART NO. FOR REVISION LEVEL	BY
-	2-19-21	NEW DRAWING [CT210077]	ZHK
A	3-10-21	(SHEET 1) UPDATED VIEWS; (B-C-7) ADDED OPTIONAL SPD KIT; [CT210709]	ZHK

UNLESS OTHERWISE SPECIFIED -  
1) DIMENSIONS ARE IN MILLIMETERS  
2) TOLERANCES ARE:  
X.XX ± 0.25  
X.X ± 1.0  
X ± 1.5  
ANGLES ± 0° 30' MAX.

THIRD ANGLE PROJECTION

APPROVALS	DATE
DRAWN ZHK	2-12-21
CHECKED MTL	2-12-21
APPROVED MTL	2-12-21

**KOHLER CO.** METRIC PRO-E  
POWER SYSTEMS, KOHLER, WI 53044 U.S.A.  
THIS DRAWING IN DESIGN AND DETAIL IS KOHLER CO. PROPERTY AND MUST NOT BE USED EXCEPT IN CONNECTION WITH KOHLER CO. WORK. ALL RIGHTS OF DESIGN OR INVENTION ARE RESERVED.

**DIMENSION PRINT - ATS, RDT 400A SE**

SCALE 0.20 CAD NO. SHEET 2 of 2  
DWG NO. **ADV-9767**