

APPLICABLE STANDARDS:

- A. F100.001 - COLOR/FINISH STANDARDS
 - B. H020.001 - TOILET PRODUCTION SPECIFICATION
 - G300.055.4.1 - LOGO
 - H020.001.1.8 - TOILET SEAT HOLE PUNCHING
 - H020.001.1.1 - UNSPECIFIED TOLERANCES
 - G300.015.3.3.1.1 - MARKINGS
 - H020.001.1.23 - COUNTRY OF ORIGIN
 - H. H020.001.3.2 - WATER ABSORPTION
- SKU NUMBER

NOTES:

1. THERE ARE 7 CUSTOMER CHARACTERISTIC SYMBOLS ON THIS DRAWING.
2. THERE IS ONE SIGNIFICANT CHARACTERISTIC SYMBOL ON THIS DRAWING.
4. FOR UNDEFINED SURFACES AND CONTOURS REFERENCE CAD MODEL F1660.

MATERIAL:

VITREOUS CHINA

ALL MATERIALS DOCUMENTED OR DESCRIBED ON THIS PRINT MUST COMPLY WITH KOHLER POLICY PEP-001-001 PRODUCT ENVIRONMENTAL POLICY RESTRICTED MATERIALS LIST

ALL DIMENSIONS IN: INCHES [MM]					DIMENSIONING AND TOLERANCING PER ASME Y14.5M-1994							
					TOLERANCES UNLESS OTHERWISE SPECIFIED	APPROVED	JACK FENG	DATE	2121.7.23	PLOT DATE	SCALE	
						DRAWN	DATE	CHECKED	DATE			
						PAUL CHEN	2021.7.23					
						DO NOT SCALE DRAWING	CRED			DWG	SIZE	
						KOHLER		THIRD ANGLE PROJECTION				
						KOHLER CO. KOHLER, WISCONSIN 53044		PART NAME: F1660				
						DESCRIPTION		VEIL CLASS FIVE 2PC BOWL				
						DWG. NO.	F1660			SHT	1 OF 3	
						DWG REVISION RECORD						

THIS DRAWING IN DESIGN AND DETAILS IS THE PROPERTY OF KOHLER CO. AND MAY NOT BE USED EXCEPT IN CONNECTION WITH KOHLER CO. WORK. ALL RIGHTS OF DESIGN OR INVENTION ARE RESERVED.

FUNCTION

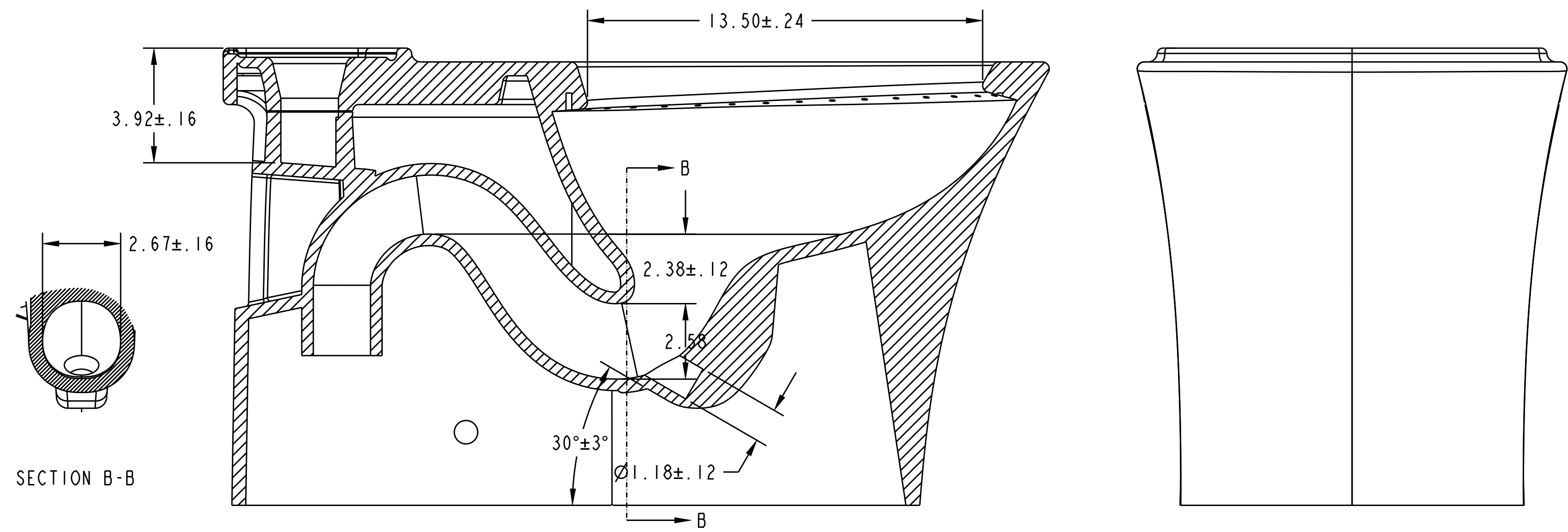
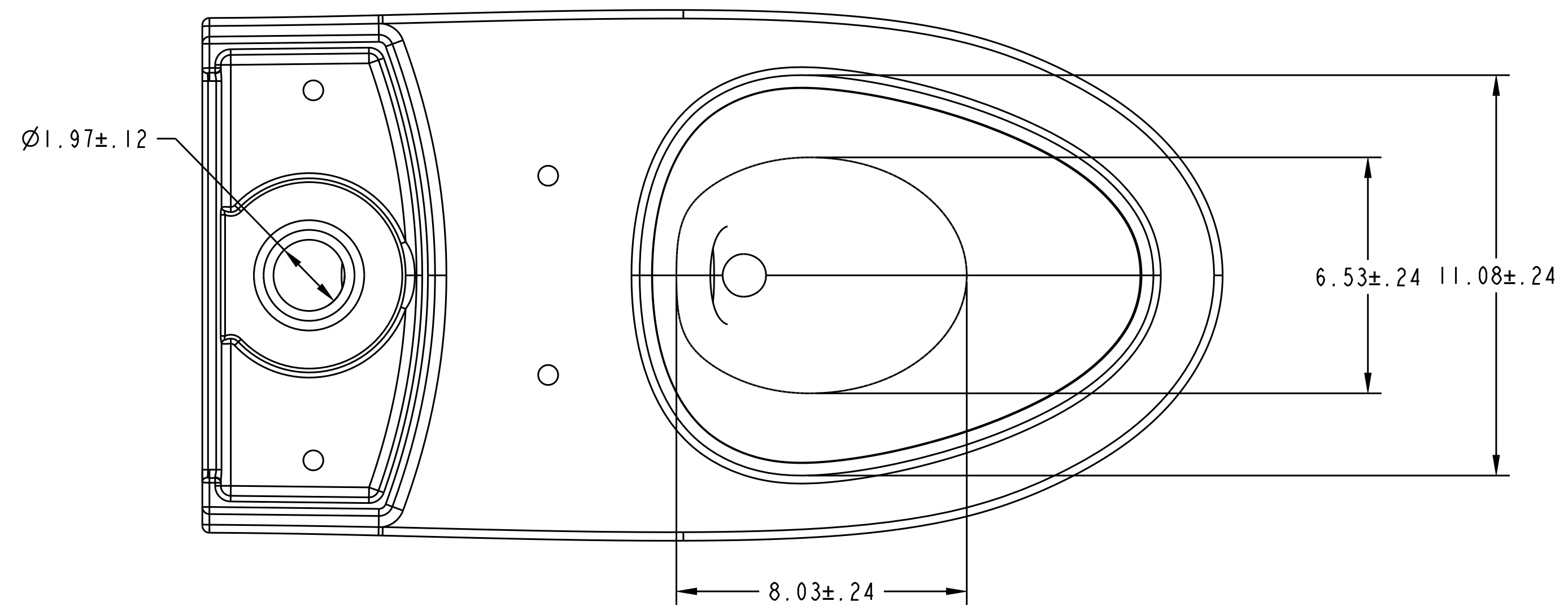

KEY DIM/CHAR		FLUSH IMPACT: FROM LSL TO USL						
NO.	DESCRIPTION	MISO	DISK	GRANULE	DYE	MIXED MEDIA	3 PAPER	SPLASH
1	BALL PASSAGE TRAPWAY	+	+	-	-	+		
2	WATER SEAL DEPTH	-	-	+	-	-		
3	WATER SEAL LENGTH			-	-	+		
4	WATER SEAL WIDTH			-	-	+		
5	JET HOLE SIZE	+	+	-	-	+		
6	JET HOLE ANGLE	+	+					
7	HOLE TO JET LENGTH(LEFT/RIGHT)	+	+	+		+		
8	HOLE TO JET WIDTH(LEFT/RIGHT)	+	+	+		+		
9	HOLE TO 1st RIM LENGTH(LEFT/RIGHT)						+	-
10	HOLE TO 1st RIM WIDTH(LEFT/RIGHT)						+	-
11	1st RIM HOLE LENGTH					+	+	-
12	1st RIM HOLE WIDTH					+	+	-
13	1st RIM HOLE LOCATION						+	-
14	2nd RIM HOLE DIA							
15	2nd RIM HOLE LOCATION							
16	MOUTH CLEARANCE	+	+	-	-	+		
17	MOUTH WIDTH	+	+	-	-	+		
18	RIM OPENING LENGTH							
19	RIM OPENING WIDTH							
20	MIN HOLE TO JET LENGTH(L/R)	+	+	+		+		
21	MIN HOLE TO JET WIDTH(L/R)	+	+	+		+		
22	HOLE TO 2ND RIM LENGTH(LEFT/RIGHT)							
23	HOLE TO 2ND RIM WIDTH(LEFT/RIGHT)							
24	VENT HOLE							
25	Sump inlet							

ALL MATERIALS DOCUMENTED OR DESCRIBED ON THIS PRINT MUST COMPLY WITH KOHLER POLICY PEP-001-001 PRODUCT ENVIRONMENTAL POLICY RESTRICTED MATERIALS LIST

ALL DIMENSIONS IN: INCHES [MM]					DIMENSIONING AND TOLERANCING PER ASME Y14.5M-1994						
					TOLERANCES UNLESS OTHERWISE SPECIFIED	APPROVED JACK FENG	DATE 2121.7.23	PLOT DATE	SCALE 0.333		
					.XXX ± 0.010	DRAWN PAUL CHEN	DATE 2021.7.23	CHECKED	DATE		
					.XX ± 0.02	KOHLER KOHLER CO. KOHLER, WISCONSIN 53044 DESCRIPTION VEIL CLASS FIVE 2PC BOWL PART NAME: F1660					
					.X ± 0.1						
					ANG ± 3.0	THIRD ANGLE PROJECTION					
					THIS DRAWING IN DESIGN AND DETAILS IS THE PROPERTY OF KOHLER CO. AND MAY NOT BE USED EXCEPT IN CONNECTION WITH KOHLER CO. WORK. ALL RIGHTS OF DESIGN OR INVENTION ARE RESERVED.					DWG. NO. F1660	
SHT	SYM	BY	DESCRIPTION	DATE	DWG REVISION RECORD					SHT 2 OF 3	

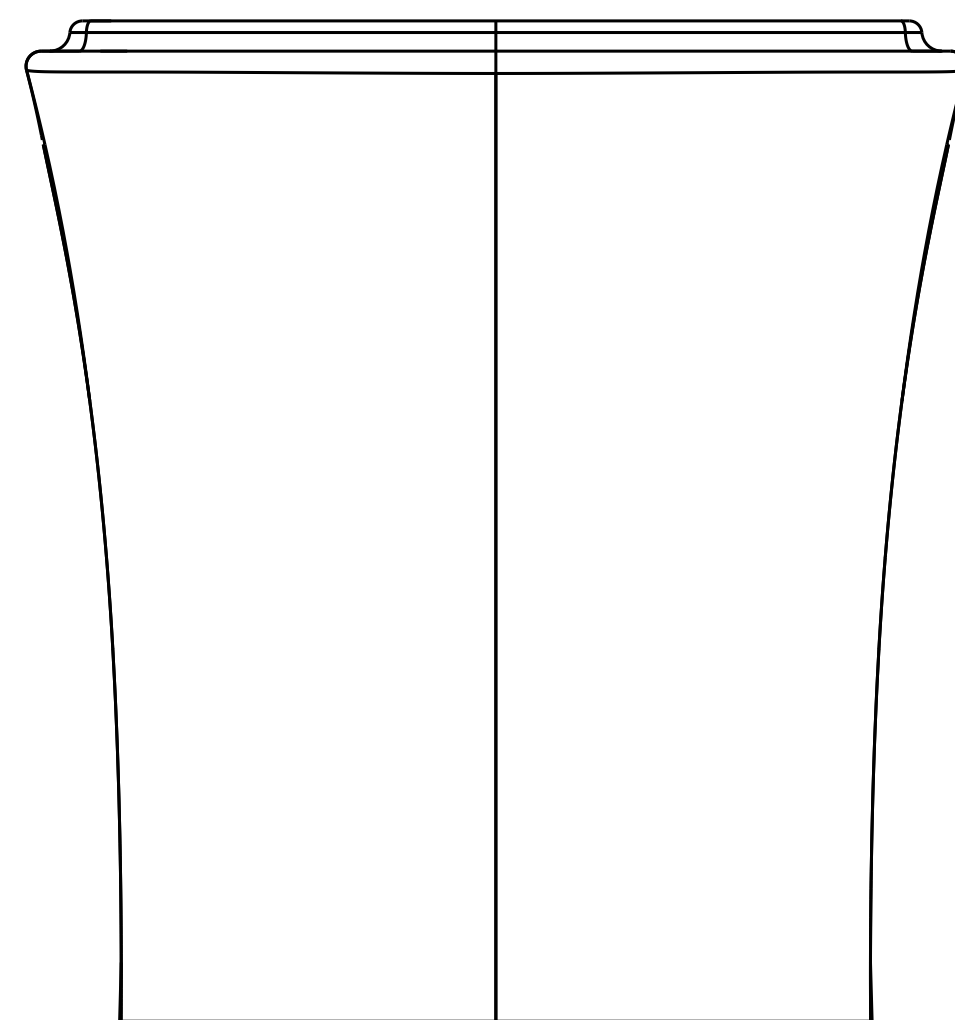
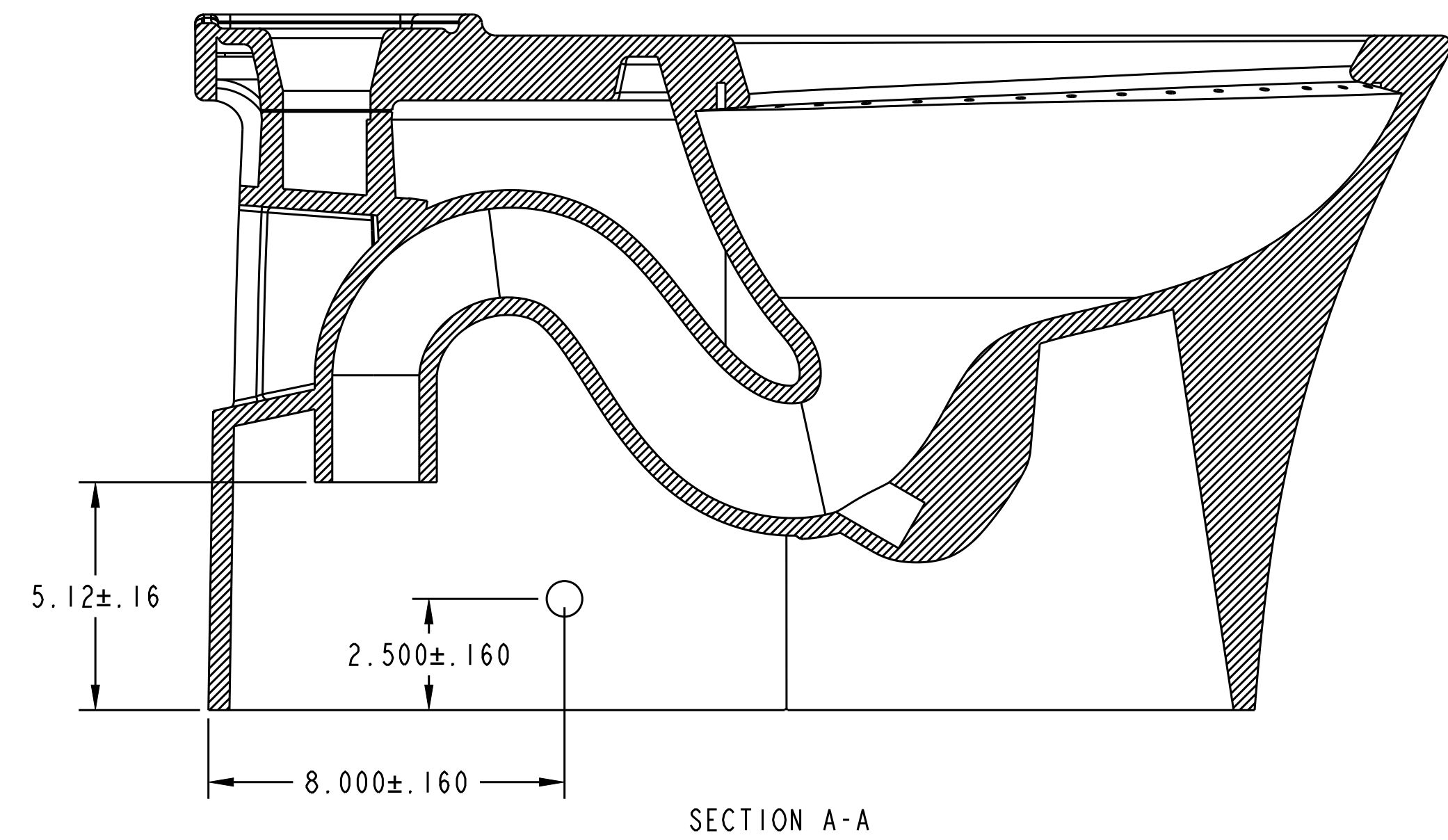
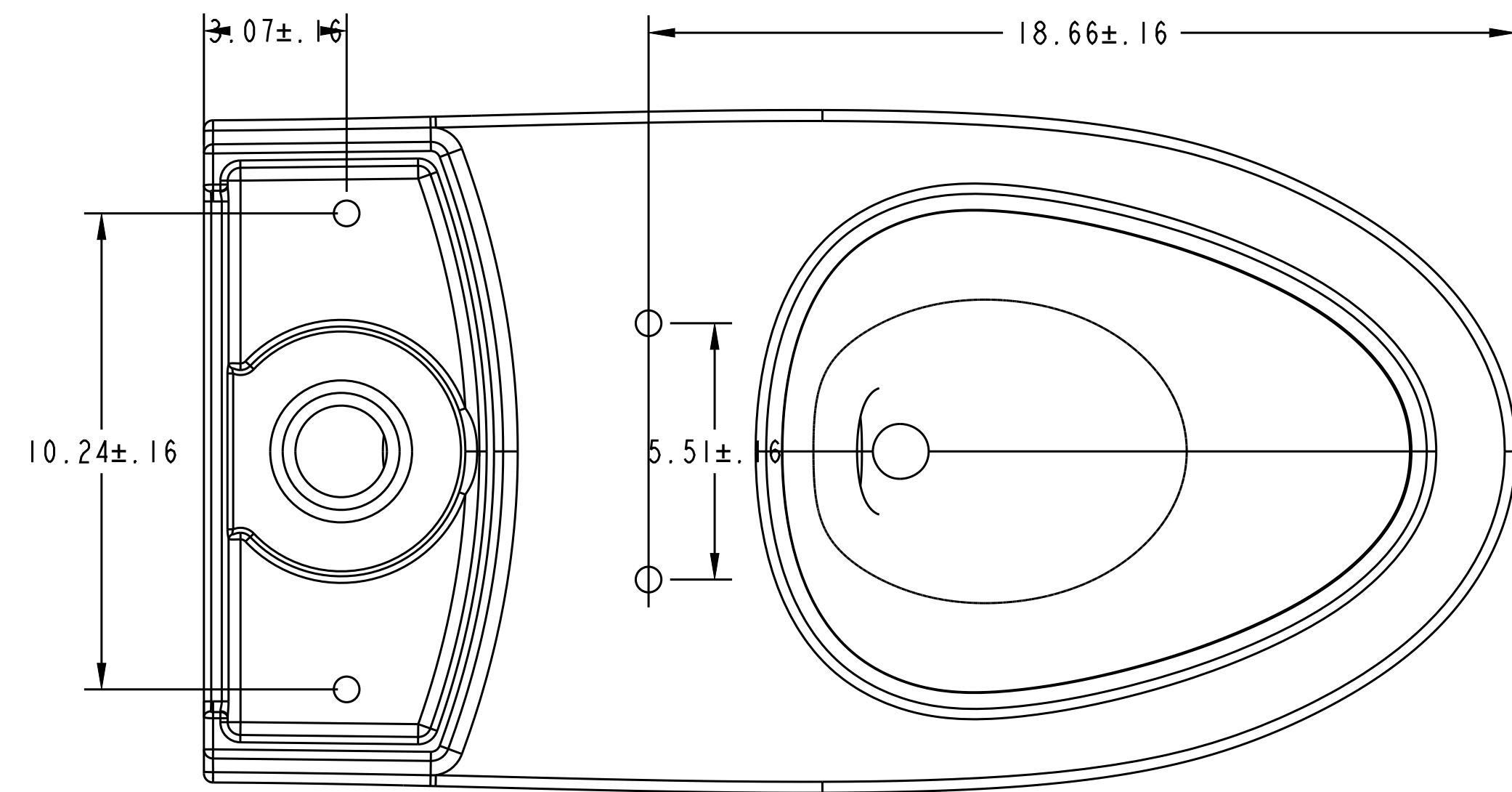

ALL MATERIALS DOCUMENTED OR DESCRIBED ON THIS PRINT MUST COMPLY WITH KOHLER POLICY PEP-ENL-001 PRODUCT ENVIRONMENTAL POLICY RESTRICTED MATERIALS LIST

ALL DIMENSIONS IN: INCHES [MM]					DIMENSIONING AND TOLERANCING PER ASME Y14.5M-1994						
					APPROVED	JACK FENG	DATE	2121.7.23	PLOT DATE	SCALE	
					DRAWN	DATE	CHECKED	DATE		0.333	
					PAUL CHEN	2021.7.23				DWG	
					DO NOT SCALE DRAWING			CRED	SIZE	D	
					KOHLER KOHLER CO. KOHLER, WISCONSIN 53044				THIRD ANGLE PROJECTION		
				DESCRIPTION					PART NAME: F1660		
					VEIL CLASS FIVE 2PC BOWL					DWG. NO. F1660	
					SHT 3 OF 3					SHT 3 OF 3	
DWG REVISION RECORD											
SHT	SYM	BY	DESCRIPTION	DATE							

THIS DRAWING IN DESIGN AND DETAILS IS THE PROPERTY OF KOHLER CO. AND MAY NOT BE USED EXCEPT IN CONNECTION WITH KOHLER CO. WORK. ALL RIGHTS OF DESIGN OR INVENTION ARE RESERVED.